

CLASS A BEDDING

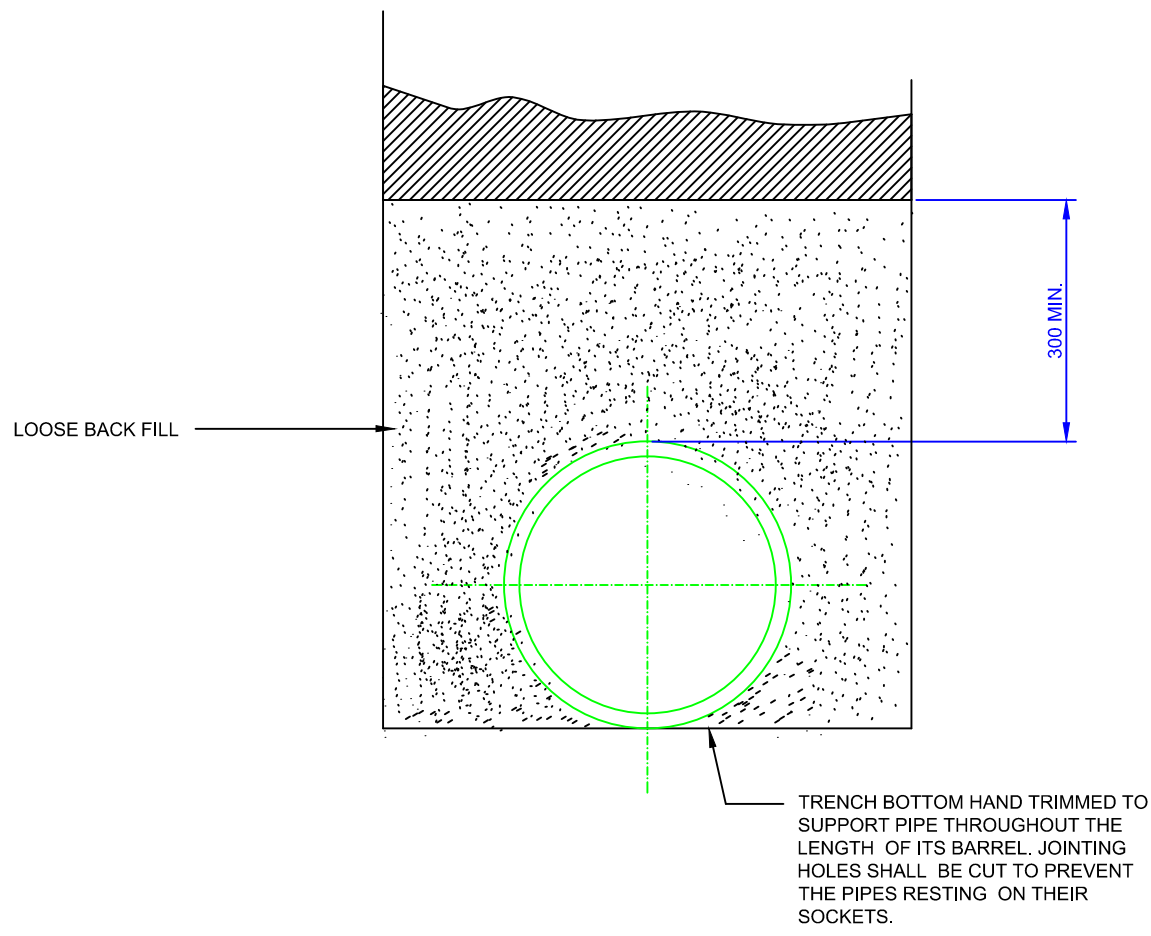

CLASS D BEDDING

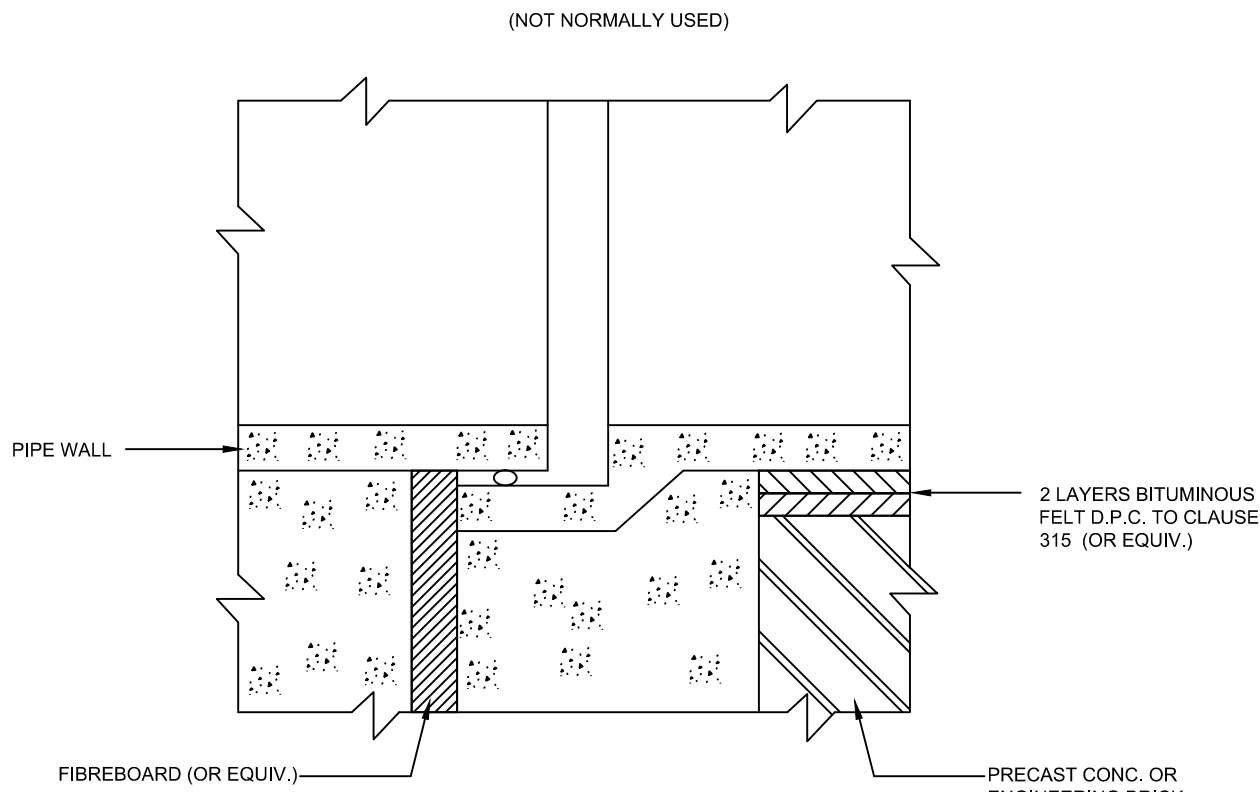

JOINT IN CONCRETE SUPPORT

NOTES:

1. THE MINIMUM TRENCH WIDTH IS ALSO THE PAYMENT WIDTH.
2. THE MAXIMUM TRENCH WIDTH IS MINIMUM TRENCH WIDTH PLUS 200mm.
3. ANY INTERNAL DIAMETER BETWEEN THOSE GIVEN IN THE TABLE, SHALL BE INCLUDED IN THE NEXT HIGHEST DIAMETER FOR MINIMUM TRENCH, PAYMENT AND MAXIMUM TRENCH WIDTHS.
- \* 4. WHERE TRENCH DEPTH IS GREATER THAN 1500mm THE WIDTH IS TO BE 1100mm.

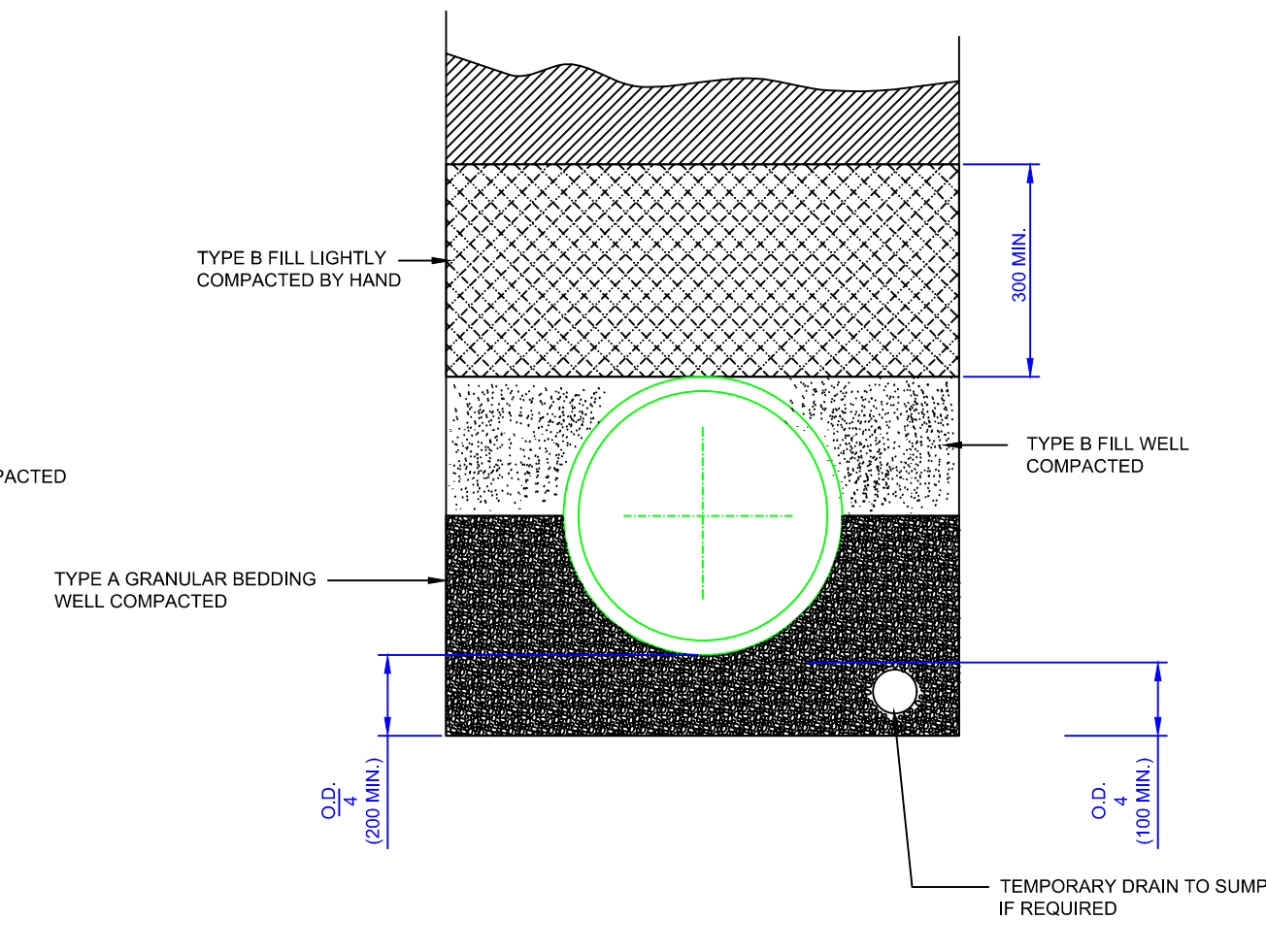

CLASS B BEDDING

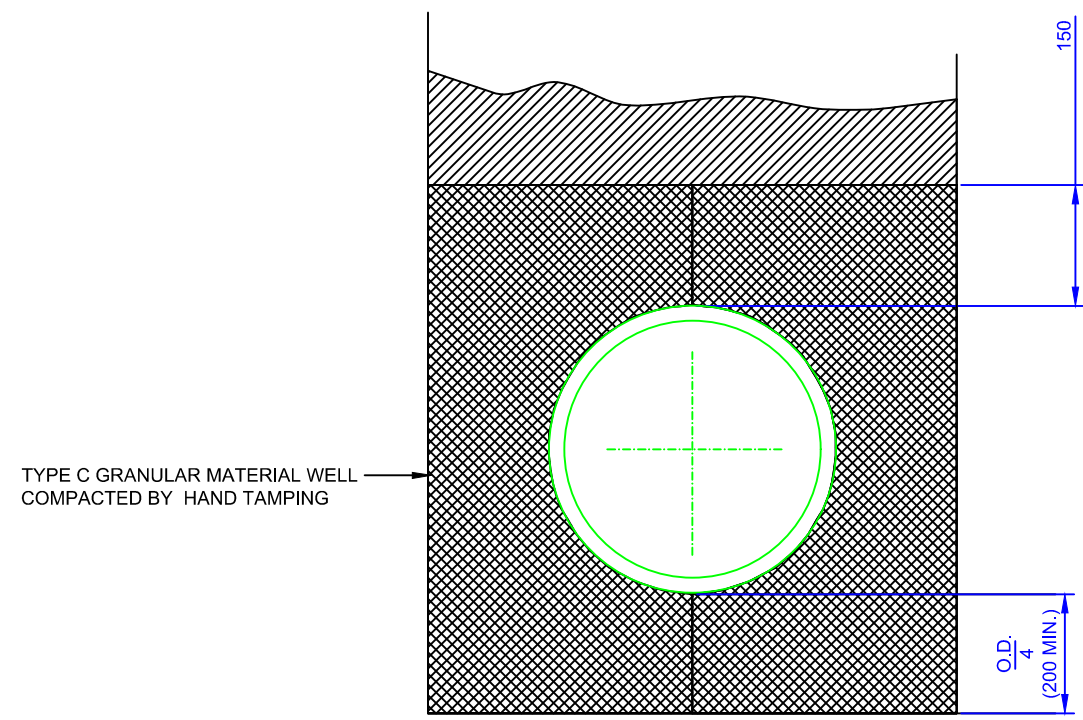

CLASS E BEDDING

NOMINAL INTERNAL DIAMETER (mm)	MINIMUM TRENCH WIDTH (mm)
100	430 *
150	490 *
200	550 *
250	620 *
300	680 *
350	730 *
400	780 *
450	1030 *
500	1080 *
600	1240
700	1320
750	1400
800	1480
850	1560
900	1620
1000	2040
1100	2160
1200	2280
ABOVE 1200	OUTSIDE DIAMETER OF PIPE PLUS 800

MINIMUM TRENCH WIDTHS

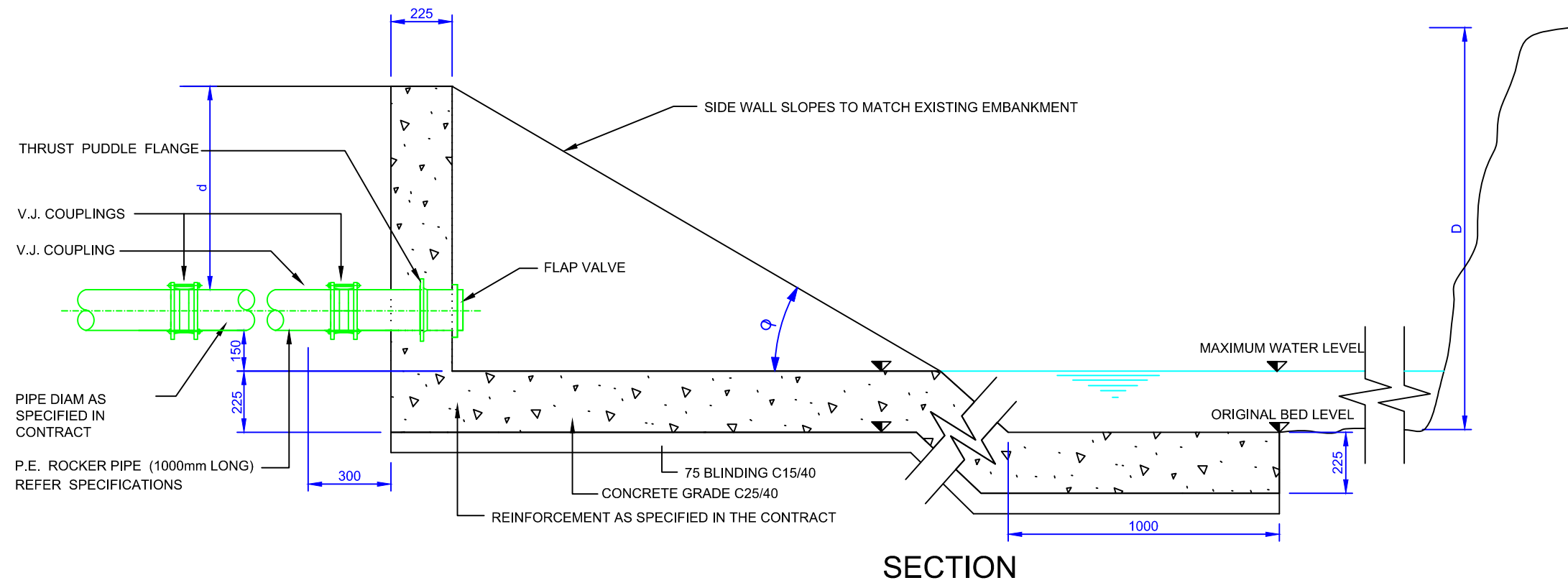

SECTION

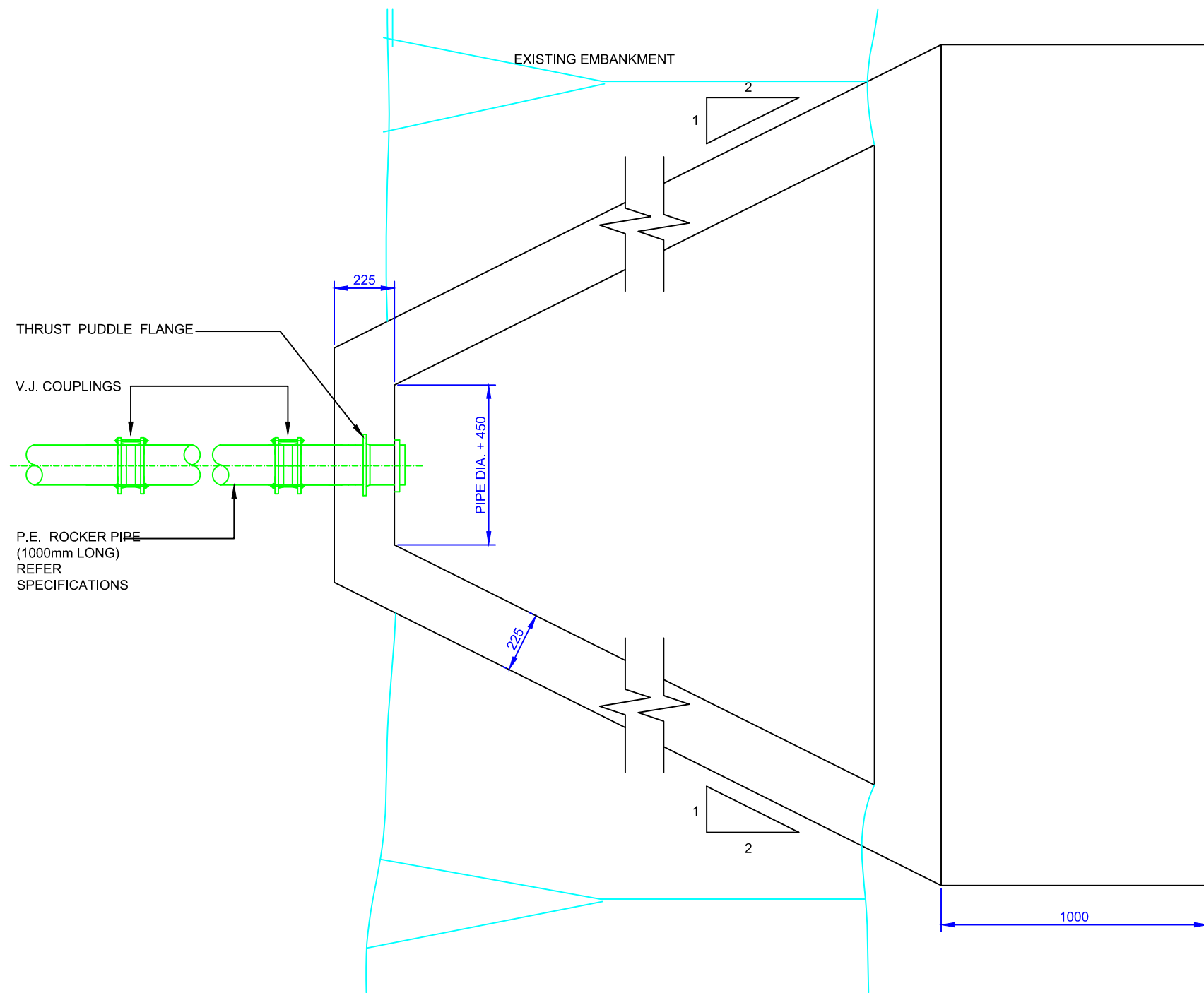

PLAN  
OUTFALL STRUCTURE

NOTE: IN SPECIFICATION  
OR BILL OF QUANTITIES INCLUDE

1. DEPTH TO CROWN OF PIPE d
2. DEPTH TO BED BELOW BANK D
3. REINFORCEMENT IF REQUIRED.

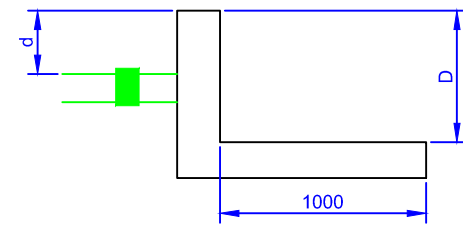

1. ALL DIMENSIONS IN MILLIMETRES UNLESS STATED OTHERWISE.
2. BEDDING TO PIPES SHALL BE CARRIED OUT IN ACCORDANCE WITH CLAUSE 506.
3. THE APPLICABLE BEDDING SHALL BE AS SPECIFIED IN THE CONTRACT.
4. TYPE A AND TYPE C BEDDING MATERIALS IN ACCORDANCE WITH CLAUSE 347.12.

TEST SIEVE (mm)	PERCENTAGE BY MASS PASSING			
	TYPE A40	TYPE A20	TYPE A14	TYPE A10 or TYPE C
63	100	-	-	-
37.5	85-100	100	-	-
20	0-25	85-100	100	-
14	-	-	85-100	100
10	0-5	0-25	0-50	85-100
5	-	0-5	0-10	0-25
2.36	-	-	-	0-5

5. TYPE A MATERIAL SHALL BE USED AS FOLLOWS:

TYPE	NOMINAL BORE OF PIPE(mm)
A40	EXCEEDING 1350
A20	600 - 1350
A14	300 - 525
A10	LESS THAN 300

6. TYPE B BEDDING MATERIAL IN ACCORDANCE WITH CLAUSE 347.12.

\*SELECTED FILL TYPE B COMPRISING UNIFORM READILY COMPACTABLE MATERIAL FREE FROM TREE ROOTS, VEGETABLE MATTER, BUILDING RUBBISH AND FROZEN SOIL, AND EXCLUDING CLAY LUMPS RETAINED ON 75mm SIEVE AND STONES RETAINED ON 25mm SIEVE.\*

7. FOR PIPE DIAMETERS GREATER THAN 800mm AND CLASS B, E AND F BEDDINGS, THE DEPTH OF GRANULAR BED BELOW THE BARREL MAY BE REDUCED WHERE STATED IN THE CONTRACT.

8. REFERENCE TO A CLAUSE ON THIS DRAWING IS TO THE GENERAL SPECIFICATION.

9. TYPE D AND TYPE E BEDDING MATERIALS IN ACCORDANCE WITH CLAUSE 347.13 OF THE GENERAL SPECIFICATION.