

BIORETENTION AREA  
SCALE 1:20

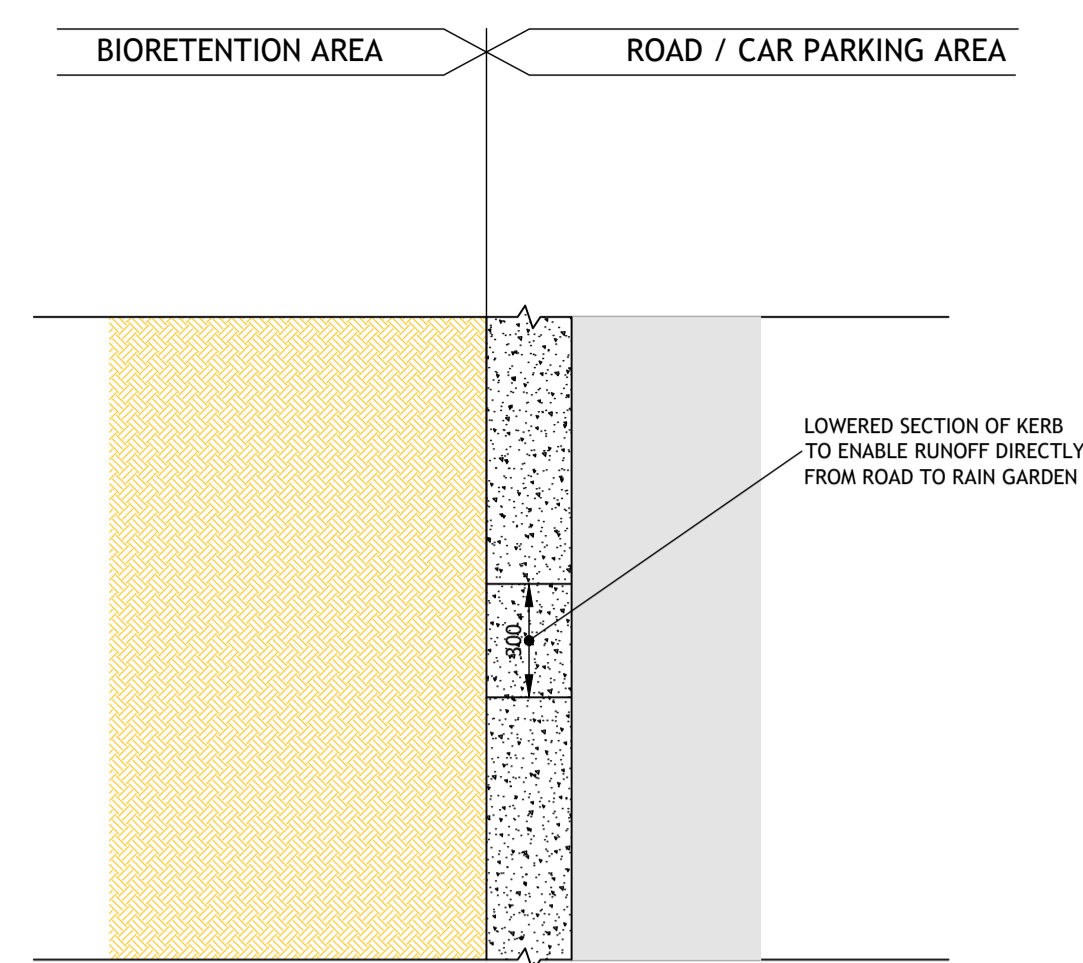

PLAN ON INTERFACE BETWEEN ROAD & BIO RETENTION -  
LOWERED KERB DETAIL (REFER DET.1 FOR SECTION)  
SCALE 1:20

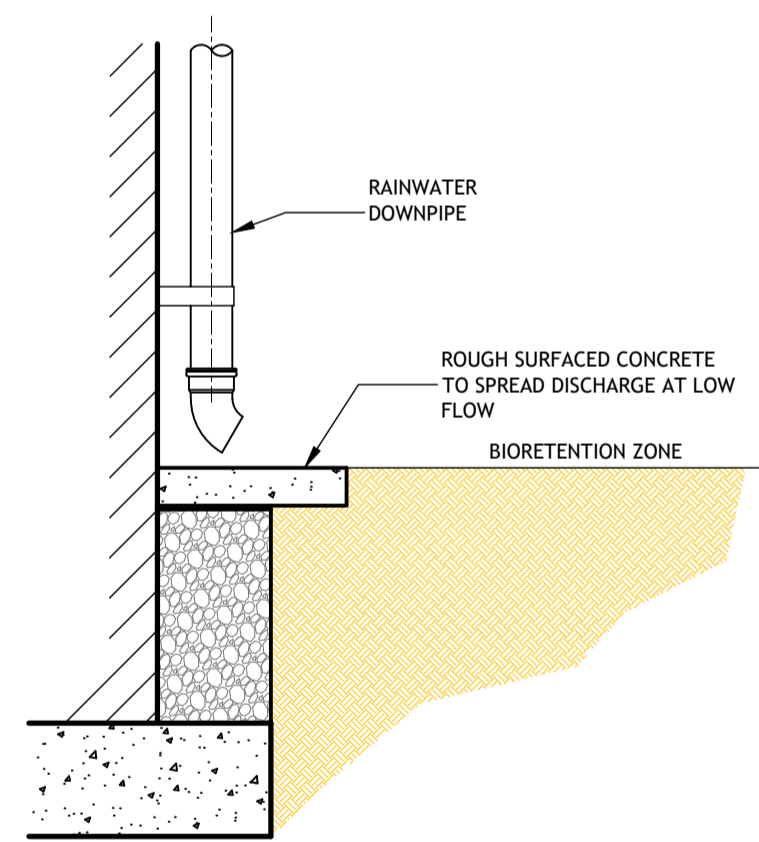

RAINWATER DOWNPIPE DISCHARGE  
SCALE 1:20

© PUNCH Consulting Engineers

This drawing and any design herein is the copyright of the Consultants and must not be reproduced without their written consent. All drawings remain the property of the Consultants. Figured dimension only to be taken from this drawing. Consultants to be informed immediately of any discrepancies before work proceeds.

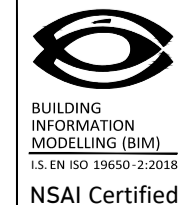

Rev	Amendment	By	Date	Rev	Amendment	By	Date
C01	DRAFT PLANNING ISSUE	PJM	2024-04-12				
C02	DRAFT PLANNING ISSUE	AF	2024-04-19				
C03	PLANNING APPLICATION	PJM	2024-06-25				

Client:



Project: RESIDENTIAL DEVELOPMENT LEHAUNSTOWN, CHERRYWOOD			
Title: PROPOSED DRAINAGE DETAILS - SHEET 1			
Drawn: PJ Mulcahy	Date drawn: 2024-04-04	Technician Check: PJ Mulcahy	Engineer Check: Mark Richardson
Project No: 232250	Model Ref: 232250-PUNCH-XX-XX-M2-C-0501	Approved: Leonard Brennan	
Scale @ A1: As Shown	Document Ref: 232250-PUNCH-XX-XX-DR-C-0501	Drawing Status: A0 (Planning)	
		Revision No: C03	