

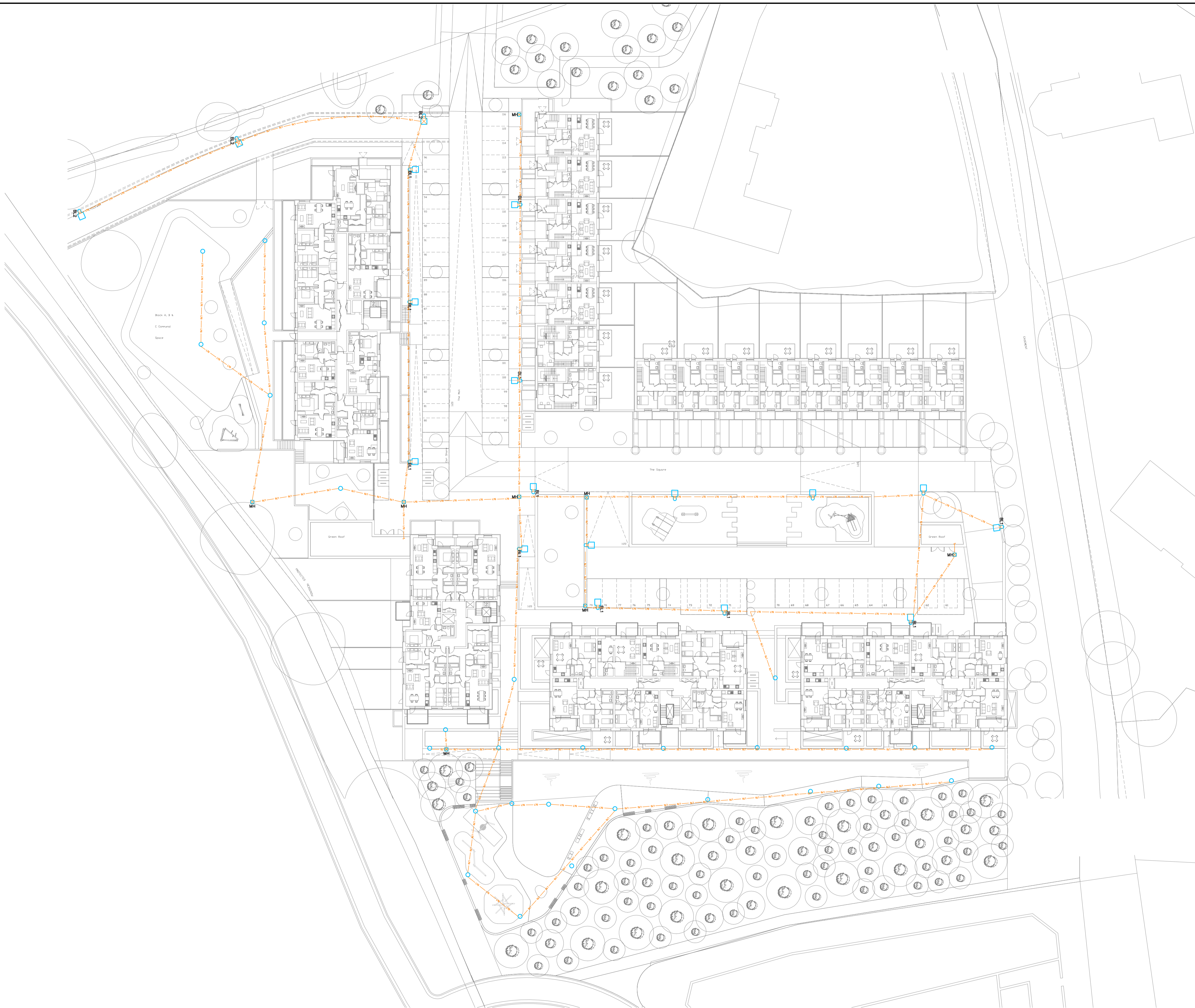





No part of this document may be re-produced or transmitted in any form or stored in any retrieval system of any nature without the written permission from Homan O'Brien Associates as copyright holder except as agreed for use on the project for which the document was originally issued. © Homan O'Brien Associates Copyright.



**Symbols Reference:**

-  LumistreetGen2 BGP291 20LED  
4.6KLM DW50 WW  
lamp(s): LED-HB 5.2S 730
-  LumistreetGen2 BGP291 20LED  
2.8KLM DM10 WW BL2  
lamp(s): LED-HB 5.2S 730
-  LumistreetGen2 BGP291 20LED  
4.6KLM DW50 WW BL1  
lamp(s): LED-HB 5.2S 730
-  Manhole – 600mm x 600mm.
-  2 No. 100mm<sup>ø</sup> Lighting PVC Ducts.
-  OptiSpace BCB500 T25 A DF  
LED27/740 candela

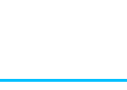

BL1 & BL2 Luminaire



Bollard Luminaire

**ISSUED FOR PLANNING**



**HOMAN O'BRIEN** Consulting Engineers  
89 Booterstown Avenue, Blackrock, Co. Dublin.  
Telephone: 2056300, Fax: 2056301  
E-mail: info@homanobrien.ie  
Web: www.homanobrien.ie

|   |                    |  |              |
|---|--------------------|--|--------------|
| Cherrywood Housing.   |                    | ABK Architects<br>34 Lower Leeson Street<br>Dublin 2 |              |
| Electrical Services Installation<br>Site Layout<br>Site Lighting Layout |                    | Drawn: K.M.<br>Checked: B.H.<br>Issue: PL1           |              |
| Drawing Number<br>2343-E1000  | Date<br>11-12-2023 | Scale<br>Refer to Scalebar                           | Issue<br>PL1 |

| Revision | Issue: P-Preliminary T-Tender CN-Construction A-Approval I-Information | Date | Checked | Revision | Issue: P-Preliminary T-Tender CN-Construction A-Approval I-Information | Date       | Checked  |
|----------|--|------|---------|----------|--|------------|----------|
|          |  |      |         |          | Issued for Planning.   | 12-04-2024 | PL1 M.M. |
|          |  |      |         |          | Issued for Information Only.   | 05-04-2024 | I02 M.M. |
|          |  |      |         |          | Issued for Information Only.   | 16-02-2024 | I01 M.M. |