



KEY - SOFT LANDSCAPING

- PLANT MIX 1 - ORNAMENTAL MIX & RAISED PLANTER MIX**
PLEASE REFER TO PLANTING SCHEDULE FOR DETAILS/SPECIES.
- PLANT MIX 2 - BIORETENTION MIX**
PLEASE REFER TO PLANTING SCHEDULE FOR DETAILS/SPECIES.
- MEADOW GRASS**
AREAS OF THE SITE ARE PROPOSED TO BE MAINTAINED AS MEADOWS. THE BIODIVERSITY OF THE SITE WILL BE IMPROVED BY MANAGING THESE AREAS AS MEADOWS. THIS SHOULD ALLOW A RANGE OF NATIVE WILDFLOWERS TO NATURALLY COLONISE THE HABITAT. THE KEY MANAGEMENT MEASURE FOR NATURAL MEADOWS IS TO MOW ONY ONCE PER YEAR, AND TO REMOVE THE CUTTINGS (THIS CAN BE USED AS AMENITY GRASS).
- AMENITY GRASS**
HARDWEARING SEED MIX TO BE USED.
- PRIVATE LAWN SPACE**
HARDWEARING SEED MIX TO BE USED.
- HEDGE 1**
FAGUS SYLVATICA - BEECH
LOW INTERNAL HEDGE - 1.2M HIGH
SINGLE ROW - 2.5NO. PER PER LINEAR METER.
- HEDGE 2**
FAGUS SYLVATICA - BEECH
BOUNDARY HEDGING - 1.8M HIGH
SINGLE ROW - 1.8 PLANTS PER LINEAR METER.
- TREE 1 (T1) - ORNAMENTAL STANDARD MIX**
• ILEX AQUIFOLIUM (HOLLY) 30%
• SCORBUS AUCUPARIA (ROWAN) 30%
• SORBUS ARIA (WHITESMART) 40%
- TREE 2 (T2) - RESIDENTIAL FRONT GARDEN/RAISED PLANTER MIX**
• MALUS SYLVESTRIS (CRAB APPLE) 25%
• SORBUS AUCUPARIA (ROWAN) 25%
• AMELANCHIER LAMARCKII (SNOWY MESPLUS) 25%
• BETULA ULM VAR. JACQUEMONTII 25%
• CORYLUS AVELLANA (HAZEL) 25%
- TREE 3 (T3) - RESIDENTIAL STREET TREE MIX**
• SCORBUS AUCUPARIA (ROWAN) 50%
• MALUS SYLVESTRIS (CRAB APPLE) 50%
- TREE 4 (T4) - NATIVE WOODLAND MIX**
• BETULA PENDULA (SILVER BIRCH) 15%
• CORYLUS AVELLANA (HAZEL) 10%
• CRATAEGUS MONOCOMA (HAWTHORN) 15%
• PRUNUS AUNUM (WILD CHERRY) 15%
• PINUS SYLVESTRIS (SCOTS PINE) 15%
• ELONIVUS EUROPAEUS (SPINKLE) 15%
• QUERCUS ROBUR (COMMON OAK) 15%
• SAMBUCUS NIGRA (ELDER) 10%
- TREE 5 (T5) - FEATURE MIX**
• QUERCUS PETRAEA (SESSILE OAK) 30%
• CARPINUS BETULUS FASTIGIATA (HORNBEAM) 30%
• PINUS SYLVESTRIS (SCOTS PINE) 40%
- TREE 6 (T6) - BIORETENTION MIX**
• QUERCUS PETRAEA (SESSILE OAK) 50%
• CARPINUS BETULUS (HORNBEAM) 50%
- EXISTING TREES - TO BE RETAINED**
PLEASE REFER TO ARBORIST'S REPORT FOR FURTHER INFORMATION.
- EXISTING HEDGEROW - TO BE RETAINED**
PLEASE REFER TO ARBORIST'S REPORT FOR FURTHER INFORMATION.
- EXISTING TREES - TO BE REMOVED**
PLEASE REFER TO ARBORIST'S REPORT FOR FURTHER INFORMATION.
- EXISTING HEDGEROW - TO BE REMOVED**
PLEASE REFER TO ARBORIST'S REPORT FOR FURTHER INFORMATION.
- TREE GRATES**
STEEL FRAME BOUND TREE GRATES TO FACILITATE TREE PLANTING IN HARD LANDSCAPING.
PLEASE REFER TO THE ACCOMPANYING DETAILS / DESIGN REPORT FOR FURTHER SPECIFICATION.
- GRASS MOUNDING**
PLEASE REFER TO THE ACCOMPANYING DETAILS / DESIGN REPORT FOR FURTHER SPECIFICATION.

PLANTING SCHEDULE

PLANT MIX 1 - ORNAMENTAL & RAISED PLANTER MIX
PLANTED AT 500MM CENTERS UNLESS OTHERWISE STATED. 4NO PER SQ M TO BE FINISHED WITH A 50MM LAYER OF FINE GRADE BARK CHIP. SEE DETAILS ON DRAWING # 531-PD-06 FOR MORE INFORMATION.

NAME	SPECIFICATION	PLANTING
SHRUBS:		
AUCUBA JAP. 'ROZANNE'	CG. 3L	5%
AUCUBA JAP. 'VARIEGATA'	CG. 3L	5%
SARCOCODON CONFUSA	CG. 3L	10%
FATISIA AFRICA	CG. 10L	5%
BUDLEIA DAVIDI 'BUZZ SKY BLUE'	CG. 3L	10%
PERENNIALS:		
HYDRANGEA PAN. 'LIMELIGHT'	CG. 2L	10%
GERANIUM 'ROZANNE'	CG. 3L	10%
SALVIA 'CARADONNA'	CG. 2L	10%
VERBENA BONARIENSIS	CG. 2L	10%
GRASSES:		
CAREX 'TEST. 'PRAIRIE FIRE'	CG. 2L	15%
LIBERTIA 'GRANDIFLORA'	CG. 2L	10%

PLANT MIX 2 - BIORETENTION MIX
BIORETENTION SOIL MIX TO BE APPLIED. PLANTED AT 400MM CENTERS UNLESS OTHERWISE STATED. 6.25NO PER SQ M TO BE FINISHED WITH A 50MM FINE GRADE BARK MULCH. SEE DETAIL 001 AND 006 ON DRAWING # 531-PD-06 FOR MORE INFORMATION.

NAME	SPECIFICATION	PLANTING
SHRUBS:		
ERICA 'DARLEVENSIUS 'KRAMER'S ROSE''	CG. 2L	20%
GRASSES:		
CAREX TESTACEA	CG. 2L	20%
PERENNIALS:		
RUEBICKIA HIRTA 'MAYA'	CG. 2L	10%
INDULA HOOKERI	CG. 2L	10%
HELENIUM AUTUMNALE	CG. 2L	10%
VERONICASTRUM VIRGINICUM	CG. 2L	10%
BULBS:		
IRIS PSEUDACORUS	CG. 2L	10%
ALLIUM GLOBEMASTER	CG. 2L	10%
NARCISSUS (IN VARIETY)	10 P/SQM	

RHS PLANTS FOR POLLINATORS **RHS AWARD OF GARDEN MERIT**
80% OF THE SHRUBS AND PERENNIALS PROPOSED ARE ON THE RHS PLANTS FOR POLLINATORS LIST.
REHORT 900 ROOT BARRIER (OR SIMILAR AND APPROVED PRODUCT) TO BE USED TO ALL FRONT OF PROPERTY PLANTING AREAS TO PROTECT SERVICE ROUTES, AND ALL OTHER AREAS WHERE REQUIRED.
ALL SUBSTITUTIONS TO BE AGREED WITH LANDSCAPE ARCHITECT.

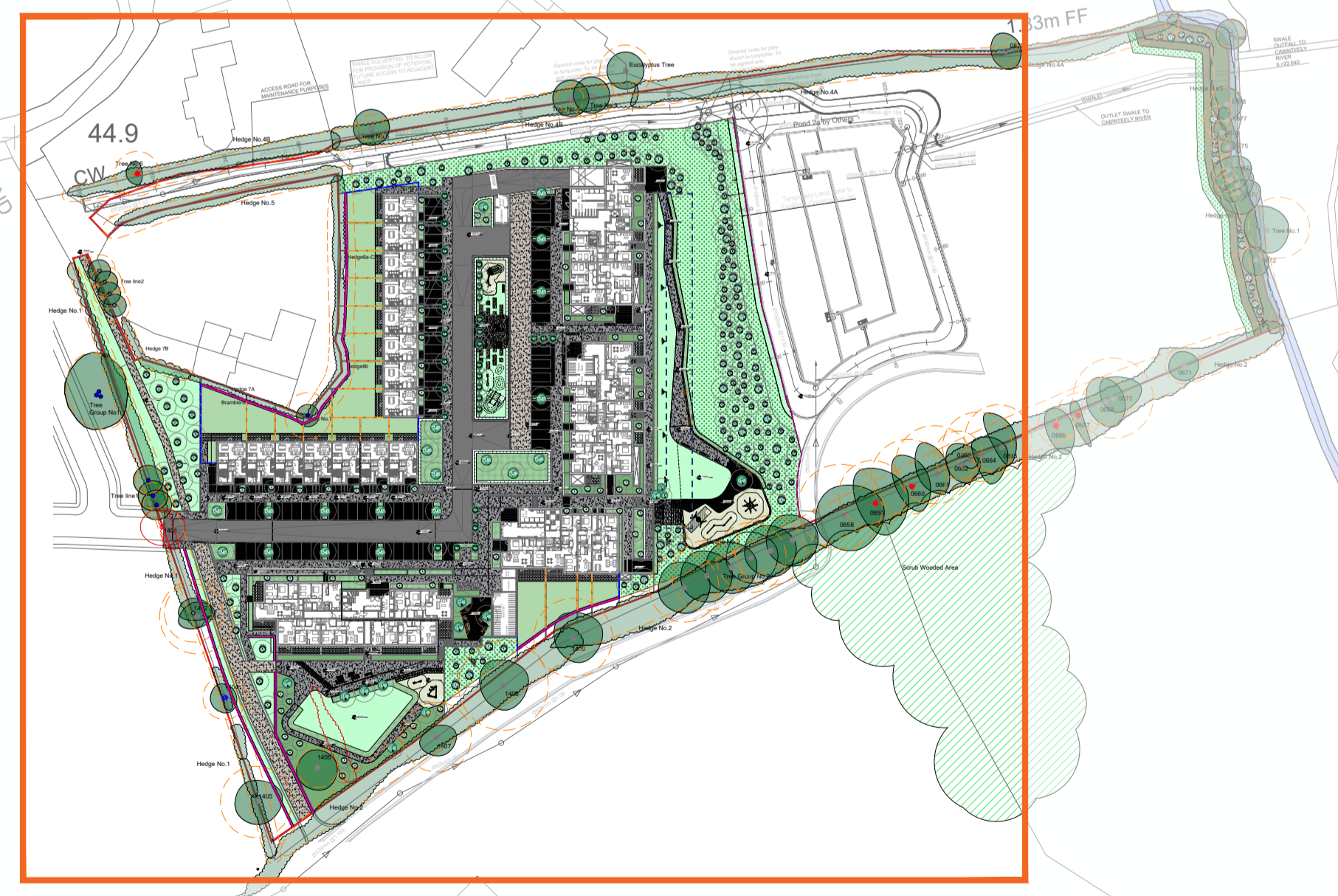

DO NOT SCALE FROM THIS DRAWING. WORK ONLY FROM FIGURED DIMENSIONS. ALL ERRORS AND OMISSIONS ARE TO BE REPORTED TO LANDSCAPE ARCHITECT

REV:	DATE:	REFERENCE:
A	2024-04-11	PLANTING PLAN & SCHEDULE 1 OF 2
B	2024-06-24	PUBLISHED PLANNING ISSUE
C	2024-06-26	PUBLISHED PLANNING ISSUE - SERVICES REVISIONS

BY:	REV:	DATE:	REFERENCE:
RM			
CC			
CC			

BY:	REV:	DATE:	REFERENCE:

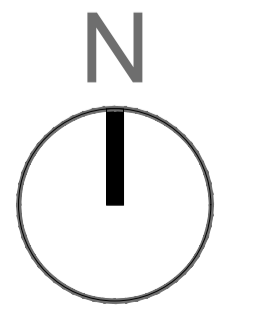

MURPHY+SHEANON
Horticulture & Landscape Architecture

Contact : colum@murphysheanon.ie
Tel : +353860787147
Address : Ground Floor, Mounttown House, Lower Mounttown Road, Glengageary, Co.Dublin

CLIENT: DUN LAOGHAIRE-RATHDOWN COUNTY COUNCIL
C/O ABK ARCHITECTS

PROJECT: LEHAUNSTOWN RESIDENTIAL DEVELOPMENT, CHERRYWOOD

TITLE: PLANTING PLAN & SCHEDULE 1 OF 2

CAD FILE REFERENCE: h:\shared drives\murphy sheanon office\m+s_office\jobs\2312531 - cherrywood\m+s\2_planning\23-531-pd-01 v27.06.24.dwg

DRAWING NUMBER: 531-PD-02.1	SHEET NO: REV. C
PROJECT NUMBER: 23-531	
PROJECT STATUS: PLANNING	
DATE: JUNE 2024	
SCALE: 1:400 / A1	
DRAWN BY: RM	CHECKED BY: DM/CS