



**NOTE:**  
 All drawings to be read in conjunction with all other related documents and other consultants drawings and documentation. Architects to be informed immediately of any discrepancies before work proceeds.

**© COPYRIGHT**  
 This drawing and any design herein is copyright of Deaton Lysaght Architects and must not be reproduced in whole or in part without their express written consent.

**DIMENSIONS**  
 Figured dimensions only to be taken from this drawing. All dimensions to be checked on site. Architects to be informed immediately of any discrepancies before work proceeds.

REVISION:	DESCRIPTION:	DATE:

This drawing has been prepared for the following purpose only:

**Part 8 Submission**

It should not be used, nor information contained therein be relied upon, for any other purpose whatsoever.

**Project Name:** Blackglen Road Housing  
**Project Address:** Blackglen Road, Dublin 18  
**Client:** Dun Laoghaire Rathdown County Council  
**Project No.:** 2338  
**Drawing No.:** BGR-ARCH-B-ZZ-DR-A  
**B.201**  
**Drawing Title:** Block B Elevations - Sheet 1  
**Scale:** As Shown at A1 / Half Scale at A3  
**Revision:** 1

**Dun Laoghaire-Rathdown County Council**  
  
**Head Office:** 2 Marine Rd, Dún Laoghaire, Co. Dublin, A96 K6C9  
**Telephone:** +353 1 205 4700  
**Email:** info@dlrccoco.ie

**Deaton Lysaght Architects**  
  
**Head Office:** 44 South Richmond Street, Dublin 2, D02 T284  
**Telephone:** +353 1 475 4960  
**Email:** mail@dlarch.ie

**JFOC ARCHITECTS**  
**JFOC Architects**  
**Head Office:** 354 Greenmount House, Harold's Cross, Dublin 6W, D6W X008  
**Telephone:** +353 1 453 0277  
**Email:** info@jfocarchitects.com

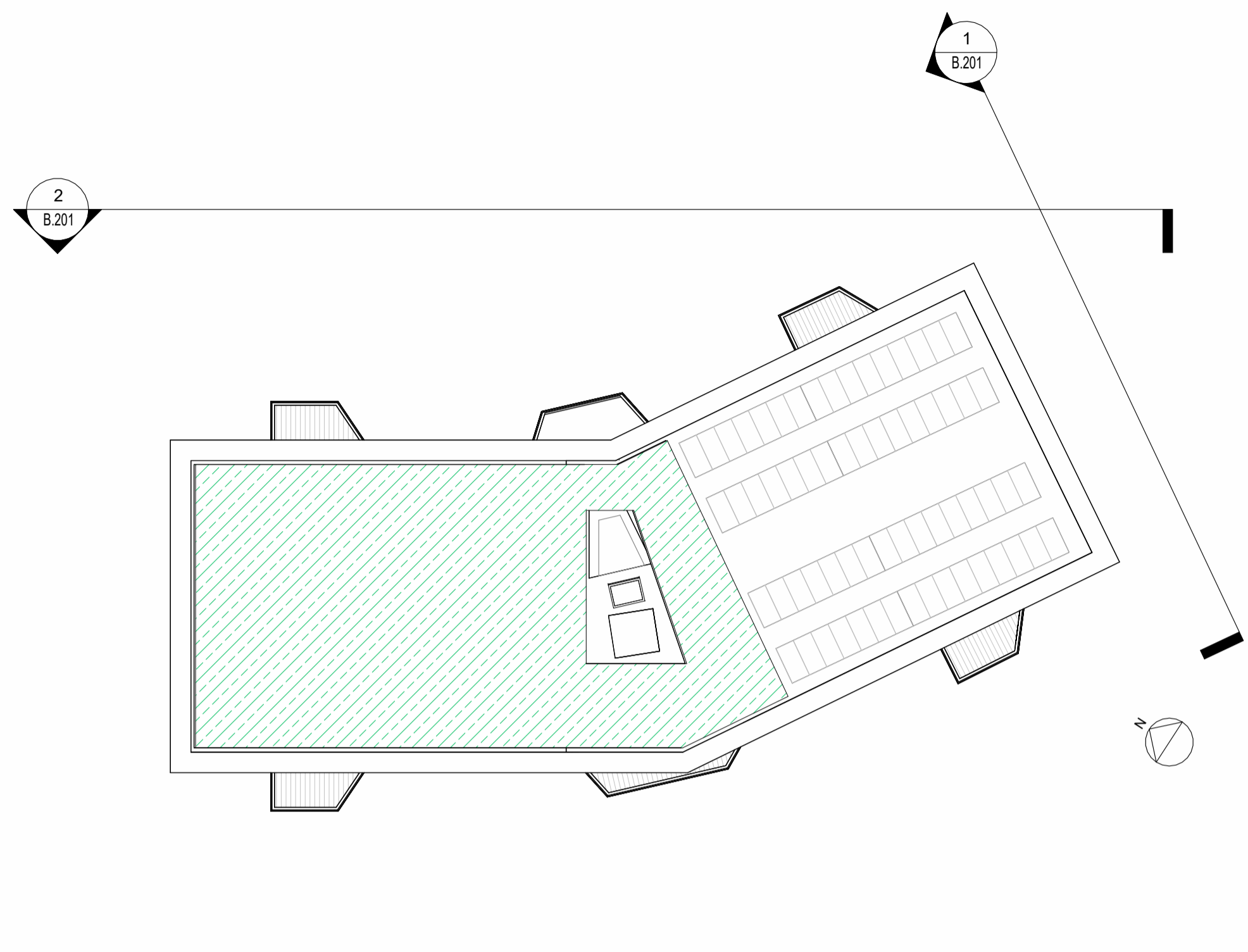

**1 North Elevation**  
 1 : 100

**K1 Block B - Keyplan**  
 B.201 1 : 250



**2 West Elevation**  
 B.201 1 : 100