



**NOTE:**  
All drawings to be read in conjunction with all other related documents and other consultants drawings and documentation. Architects to be informed immediately of any discrepancies before work proceeds.

**© COPYRIGHT**  
This drawing and any design herein is copyright of Deaton Lysaght Architects and must not be reproduced in whole or in part without their express written consent.

**DIMENSIONS**  
Figured dimensions only to be taken from this drawing. All dimensions to be checked on site. Architects to be informed immediately of any discrepancies before work proceeds.

REVISION:	DESCRIPTION:	DATE:

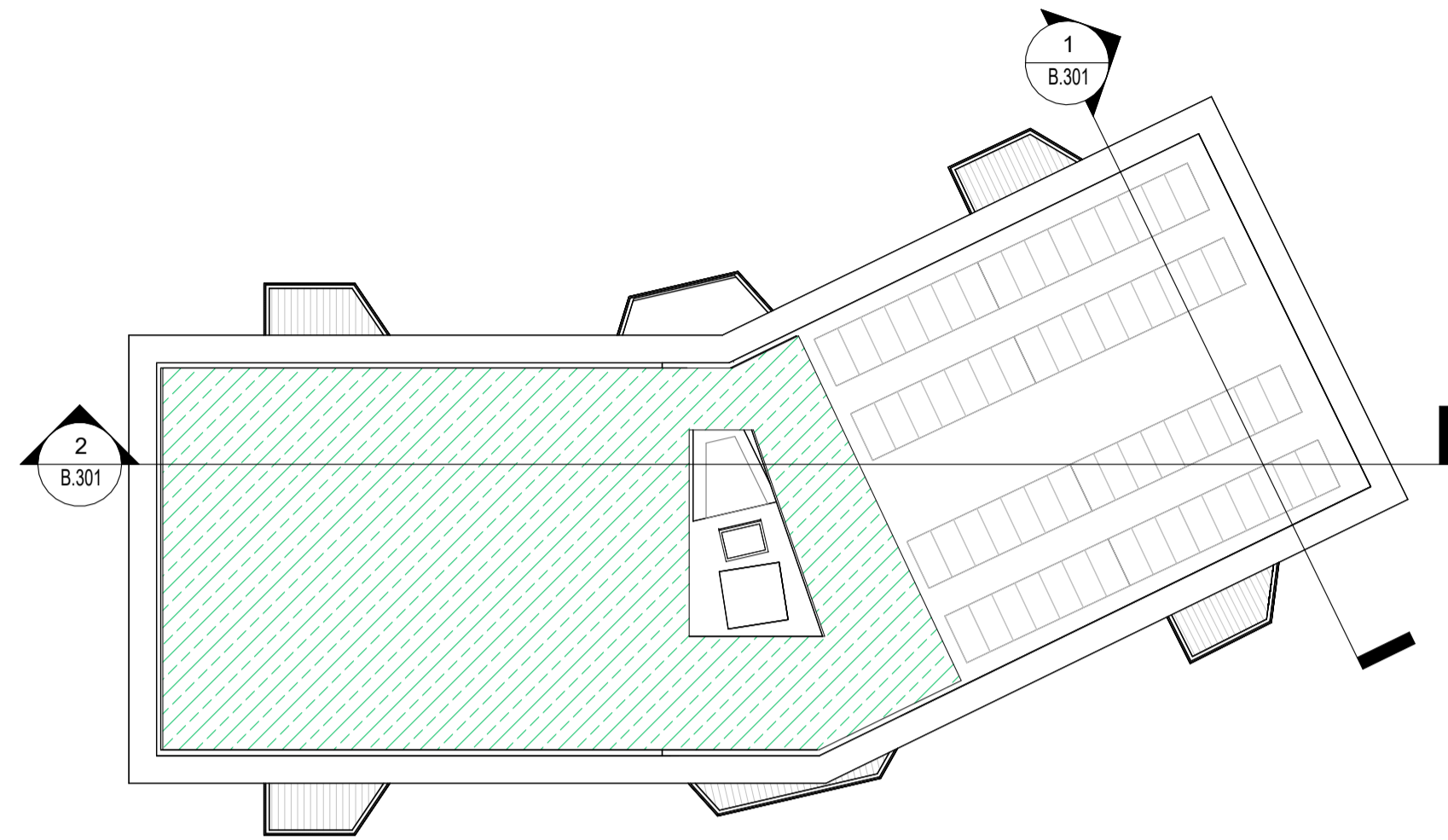

**Block B - Keyplan**  
K1  
B.301  
1 : 250



**Block B - Section 2**  
1  
B.301  
1 : 100



**Block B - Section 3**  
2  
B.301  
1 : 100

This drawing has been prepared for the following purpose only:  
**Part 8 Submission**

It should not be used, nor information contained therein be relied upon, for any other purpose whatsoever.

**Project Name:** Blackglen Road Housing  
**Project Address:** Blackglen Road, Dublin 18  
**Client:** Dun Laoghaire Rathdown County Council  
**Project No.:** 2338  
**Drawing No.:** B.301  
**Drawing Title:** Block B Sections - Sections Sheet 1  
**Scale:** As Shown at A1 / Half Scale at A3  
**Revision:** 1

**Deaton Lysaght Architects**  
Head Office: 44 South Richmond Street, Dublin 2, D02 T284  
Telephone: +353 1 475 4960  
Email: mail@dlarch.ie

**JFOC ARCHITECTS**  
JFOC Architects  
Head Office: 364 Greenmount House, Harold's Cross, Dublin 6W, D6W X008  
Telephone: +353 1 453 0277  
Email: info@jfocarchitects.com