



NOTE:
All drawings to be read in conjunction with all other related documents and other consultants drawings and documentation. Architects to be informed immediately of any discrepancies before work proceeds.

© COPYRIGHT
This drawing and any design herein is copyright of Deaton Lysaght Architects and must not be reproduced in whole or in part without their express written consent.

DIMENSIONS
Figured dimensions only to be taken from this drawing. All dimensions to be checked on site. Architects to be informed immediately of any discrepancies before work proceeds.

REVISION:	DESCRIPTION:	DATE:

This drawing has been prepared for the following purpose only:

Part 8 Planning

It should not be used, nor information contained therein be relied upon, for any other purpose whatsoever.

Project Name: **Blackglen Road Housing**

Project Address: **Blackglen Road, Dublin 18**

Client: **Dun Laoghaire Rathdown County Council**
2338

Project No.: **BGR-ARCH-C-ZZ-DR-A**

Drawing No.: **C.202**

Drawing Title: **Block C Elevations - Sheet 2**

Scale: **As Shown at A1 / Half Scale at A3**

Revision: **1**

Dun Laoghaire-Rathdown County Council

drc Dun Laoghaire Rathdown County Council
Head Office: 2 Marine Rd, Dún Laoghaire, Co. Dublin, A96 K6C9
Telephone: +353 1 205 4700
Email: info@drcoco.ie

Deaton Lysaght Architects

Head Office: 44 South Richmond Street, Dublin 2, D02 T284
Telephone: +353 1 475 4960
Email: mail@dlarch.ie

JFOC ARCHITECTS

Head Office: 364 Greenmount House, Harolds Cross, Dublin 6W, D6W X008
Telephone: +353 1 453 0277
Email: info@jfocartchitects.com

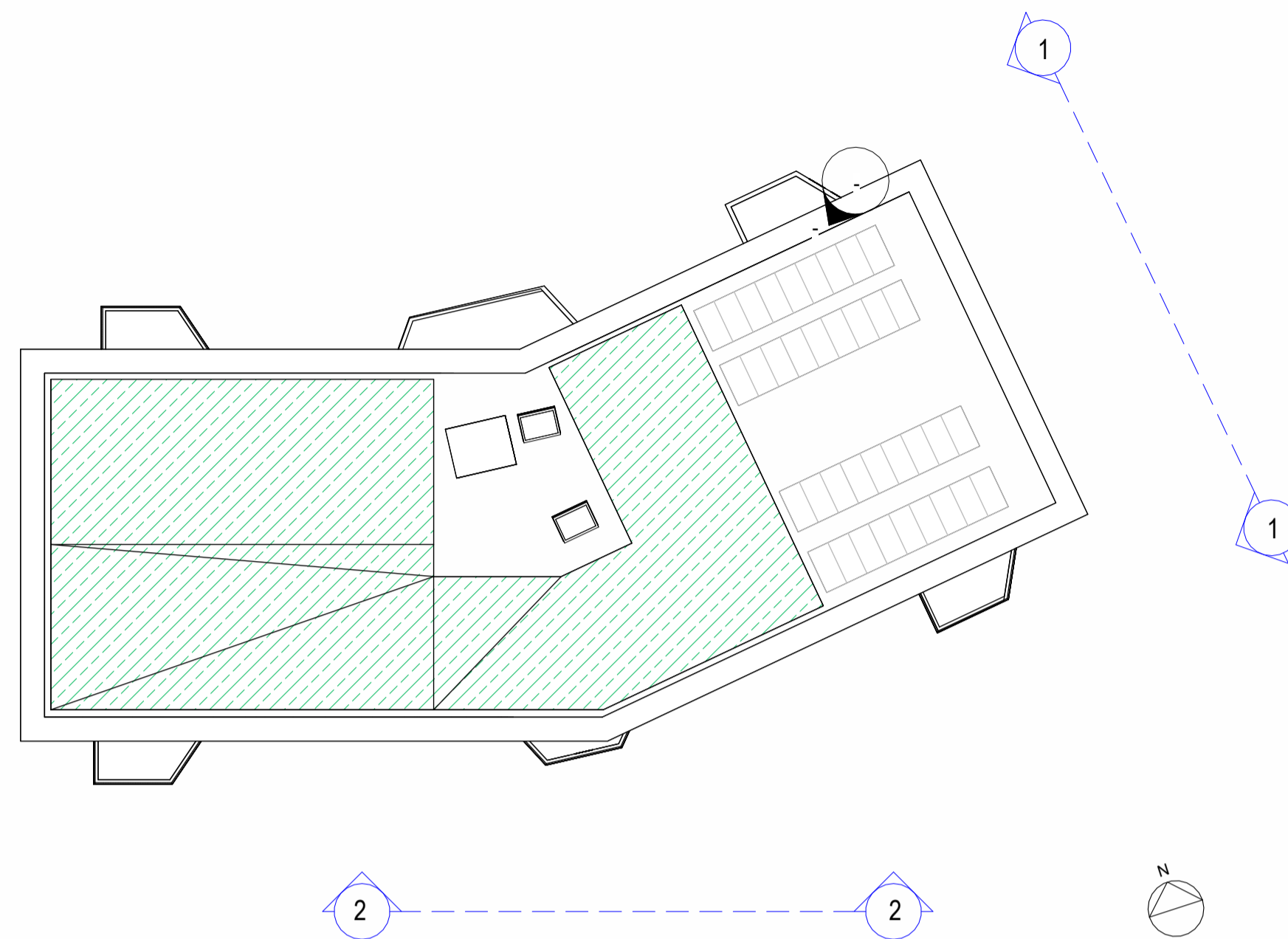

K1 Block C - Keyplan
1 : 250



1 East Elevation
1 : 100



2 South Elevation
1 : 100