

**4M SECURITY FENCE**  
1 : 20

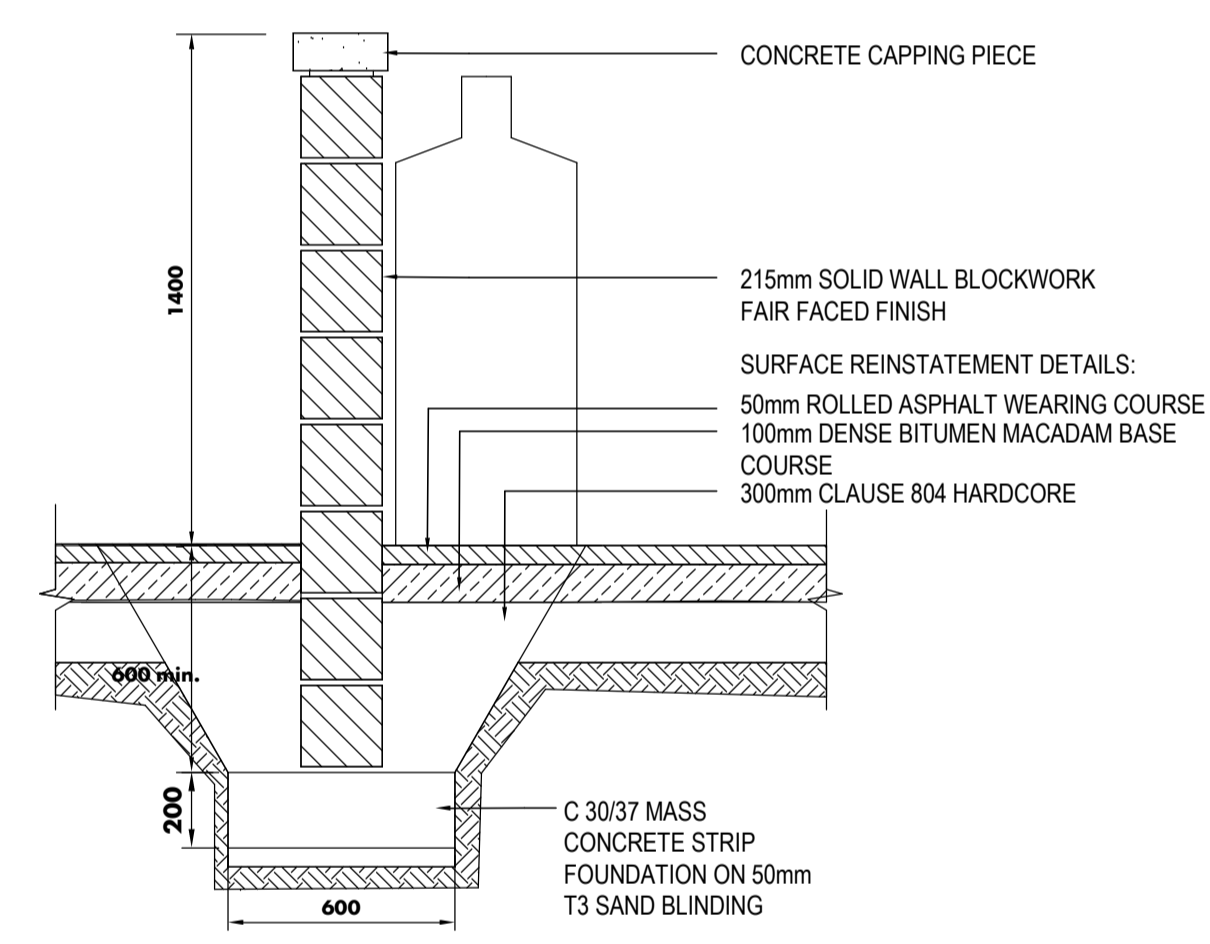

**GAS CYLINDER WALL DETAIL**  
1 : 20

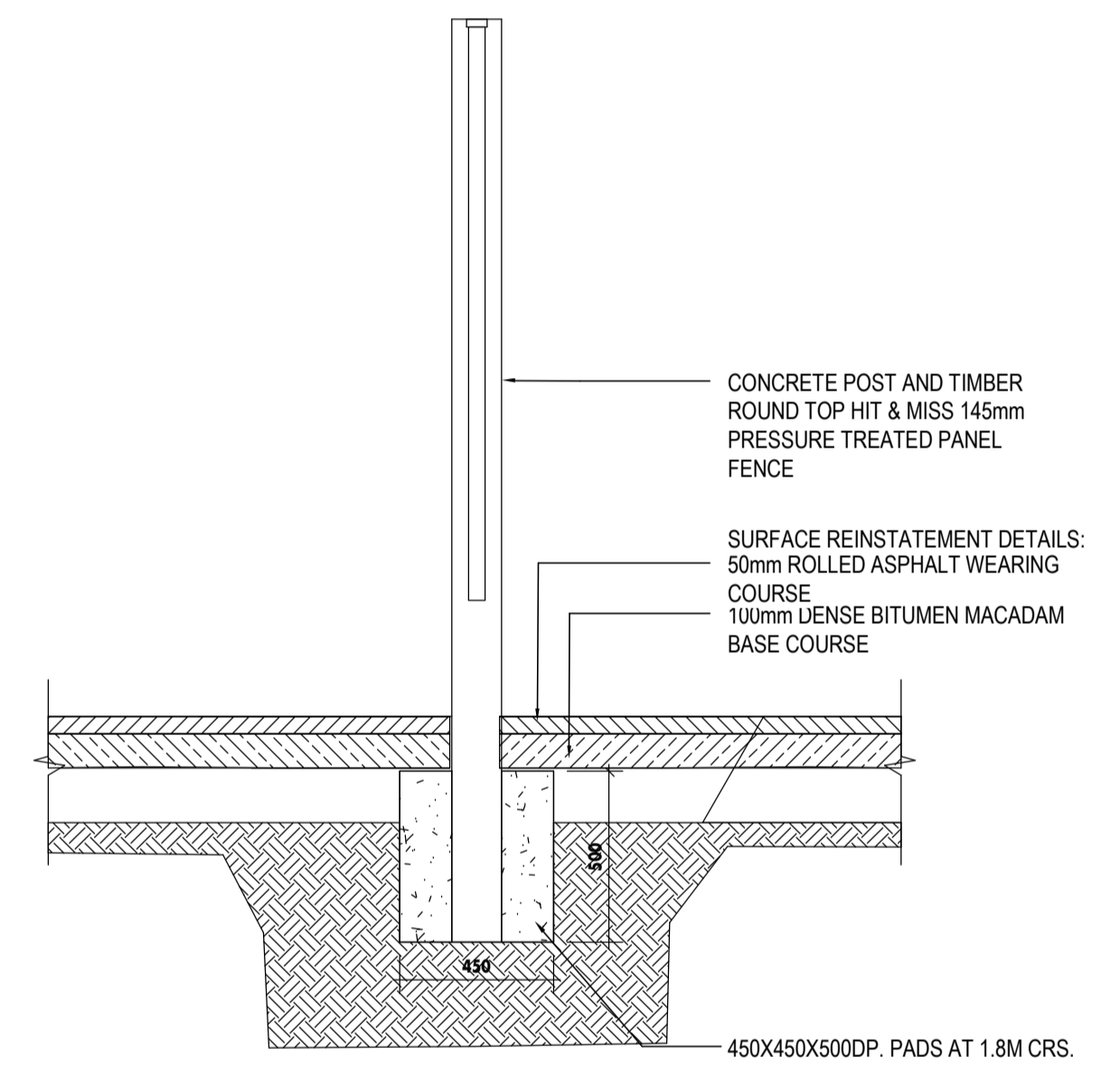

**POST & PANEL WALL**  
1 : 20

**PROPOSED DRAINAGE & SURFACE FINISH**  
1 : 200

LEGEND	
	DENOTES EXISTING STORM DRAINAGE
	DENOTES NEW STORM DRAINAGE
	DENOTES EXISTING FOUL DRAINAGE
	DENOTES NEW FOUL DRAINAGE
	DENOTES EXISTING WATER MAIN
	DENOTES NEW WATER MAIN
	DENOTES SITE BOUNDARY
	DENOTES GAS CYLINDER FIRE WALL
	DENOTES POST & TIMBER PANEL WALL
	DENOTES 4M HIGH SECURIFOR SECURITY FENCE
	DENOTES EXISTING SURFACE FINISH - ASPHALT (TO BE REINSTATED WHERE EXCAVATED FOR SERVICE TRENCHES)
	DENOTES NEW INSPECTION CHAMBER
	DENOTES NEW GULLY TRAP
	DENOTES EXISTING FIRE HYDRANT

- N O T E S**
1. Read in conjunction with Architects and other contract drawings and with the Specification.
  2. This drawing to be read only for details of structural elements or siteworks as indicated by the drawing Title.
  3. Structural steelwork detailed on this drawing shall be execution class . It shall be protected as per the Specification Section H.O - System .
  4. Existing services, foundations, structural elements and other works shown on this drawing are based on limited information and are to be regarded as indicative. The Contractor shall accurately locate and determine all existing works before putting new work in hand, and shall inform the Engineer. See the specification also.
  5. Any general setting-out dimensions shown here are not definitive - see the Architects drawings. See the Specification Section A also.
  6. Beneath pavements and ground-supported floor slabs, excavate, make up levels as necessary, and prepare the formation all in accordance with Section C of the Specification.
  7. Foundation formations to be in the following soil stratum(s) (see soil investigation report):
- No part of this document may be re-produced or transmitted in any form or stored in any retrieval system of any nature without the written permission of Piconault Ltd. © Kavanagh Mansfield and Partners is copyright holder except as agreed for use on the project for which the document was originally issued.

Rev.	Date	Drn. by	Description
P09	16.05.22	JK	ATTENUATION CAPACITY INCREASED
P08	09.05.22	JK	PETROL INTERCEPTOR, HYDROBRAKE & TANK RELOCATED
P07	12.04.22	JK	SITE BOUNDARY AMENDED
P06	21.02.21	JK	TOPO SURVEY ADDED
P05	18.10.21	JK	LAYOUT AMENDED
P04	13.10.21	JK	EXISTING SURFACE FINISH NOTED
P03	27.09.21	JK	SECURITY FENCE DETAIL AMENDED
P02	19.02.21	BG	LAYOUT REVISED TO MATCH ARCHITECTS
P01	30.11.20	MR	DETAILS ADDED
P00	01.10.20	MR	ISSUED FOR INFORMATION

INFORMATION	
Status	<b>INFORMATION</b>
Architect	<b>DLR ARCHITECTS</b>
Project	<b>TEMPORARY TAU BURTON CAR PARK</b>
Title	<b>PROPOSED DRAINAGE &amp; SITE SERVICES</b>
Scale @ A1	As indicated
Date	21.02.2022
Drn. by	JK
Chkd. by	Checker
Aprvd.	

**DLR 659-101**

Status	Rev.
S1	P09

**KAVANAGH MANSFIELD & PARTNERS**  
CONSULTING STRUCTURAL AND CIVIL ENGINEERS

37 HEATHER ROAD  
SANDFORD IND. EST. D18  
TEL: 01 6606966  
FAX: 01 6606758  
E-MAIL: kmp@kmp.ie