



DESIGNING AND DELIVERING
A SUSTAINABLE FUTURE

PROPOSED RESIDENTIAL DEVELOPMENT AT LEHAUNSTOWN LANE

Appropriate Assessment Screening Report

Prepared for:

Dun-Laoghaire Rathdown County Council



Date: December 2025

Document No:

P25261-FT-EGN-XX-RP-EN-0001

Unit 3/4, Northwood House, Northwood Crescent,
Northwood, Dublin, D09 X899, Ireland

T: +353 1 658 3500 | E: info@ftco.ie

CORK | DUBLIN | CARLOW

www.fehilytimoney.ie

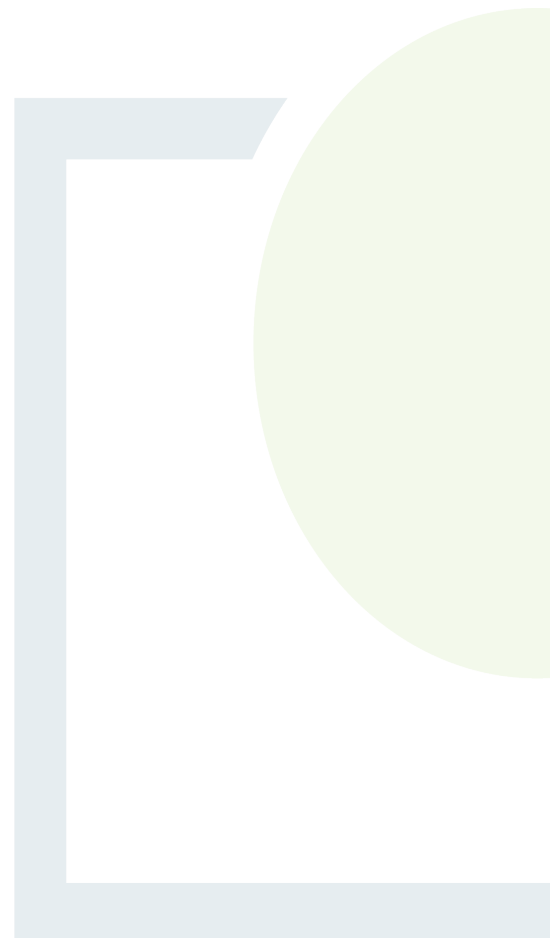

Appropriate Assessment Screening Report

REVISION CONTROL TABLE, CLIENT, KEYWORDS AND ABSTRACT

User is responsible for Checking the Revision Status of This Document

Rev. No.	Description of Changes	Prepared by:	Checked by:	Approved by:	Date:
0	Issue	HR	AT	JH	15/01/2024
1	Final Issue	HR/CM/AM	DOH	RD	12/12/2025

Client: Dún-Laoghaire Rathdown County Council

Keywords: Appropriate Assessment Screening, Residential Development, Lehaunstown Lane

Abstract: Fehily Timoney and Company is pleased to submit this Appropriate Assessment Screening to Dún Laoghaire – Rathdown County Council for Proposed Residential Development at Lehaunstown Lane, Co. Dublin.

TABLE OF CONTENTS

1.	INTRODUCTION	1
1.1	Legislative Requirements	1
1.2	Guidance.....	2
1.3	Assessment Process and Approach	2
2.	EXISTING SITE AND PROJECT DESCRIPTION.....	5
2.1	Receiving Environment.....	5
	Proposed Project	7
2.2	Potential Interactions of the Proposed project with the receiving environment.....	7
3.	SCREENING FOR APPROPRIATE ASSESSMENT	10
3.1	Identification of European Sites that may be affected by the Proposed project.....	10
3.2	Other plans and projects considered for potential in-combination effects.....	18
4.	AA SCREENING CONCLUSION	19

LIST OF APPENDICES

Appendix 1 - Background Information on European Sites

Appendix 2 - Further Information on the Qualifying Interests of SACs That Have Undergone Assessment

Appendix 3 - Further Information on the Special Conservation Interests of SPAs That Have Undergone Assessment

Appendix 4 - Conservation Objectives

Appendix 5 - In-Combination Assessment

LIST OF FIGURES

	<u>Page</u>
Figure 2-1: Site Location and Hydrological connectivity	6
Figure 2-2: Site Plan	8
Figure 3-1: European sites within the Zone of Influence and Pathway Consideration Zone	12

LIST OF TABLES

	<u>Page</u>
Table 3-1: Screening assessment of the potential effects arising from the proposed project on European sites within the Zone of Influence and Pathway Consideration Zone (listed according to distance)	13



1. INTRODUCTION

Fehily Timoney and Company (FT) were commissioned by Dún Laoghaire – Rathdown County Council to prepare a report to inform the competent authorities of a Screening for Appropriate Assessment, as required by Article 6(3) of the Council Directive 92/43/EEC (Habitats Directive). The preparation of the Appropriate Assessment (AA) screening report is for a Proposed Residential development and associated access road at Lehaunstown, Cherrywood, Co. Dublin. This road is to provide improved access through the Cherrywood SDZ while also facilitating access to a concurrent development which is subject to its own planning application for a residential development – this assessment considered these two projects in combination in section 3.2. A separate EIA screening report and associated supporting documentation will accompany the other application.

This report presents an examination of whether the proposed project is likely to have a significant effect on a European site (either alone or in combination with other plans or projects) and is based on best available scientific knowledge. This report is to inform the competent authority in completing their statutory obligation to carry out a Screening for AA.

1.1 Legislative Requirements

Council Directive 92/43/EEC on the Conservation of Natural Habitats and of Wild Fauna and Flora (Habitats Directive) provides legal protection for habitats and species of European importance. The overall aim of the Habitats Directive is to maintain or restore the “favourable conservation status” of habitats and species of European Community Interest. These habitats and species are listed in the Habitats and Birds Directives (Habitats Directive as above and Directive 2009/147/EC on the conservation of wild birds) with Special Areas of Conservation (SACs) and Special Protection Areas (SPAs) designated to afford protection to the most vulnerable among them. These two designations are collectively known and referred to as European sites.

Articles 6(3) and 6(4) of the Habitats Directive set out the decision-making tests for plans and projects likely to affect such sites. Article 6(3) establishes the requirement for AA. These requirements are implemented in the Republic of Ireland by the European Communities (Birds and Natural Habitats) Regulations 2011 (as amended) and the Planning and Development Act 2000 (as amended). Specifically, Article 6(3) of the Habitats Directive states:

"Any plan or project not directly connected with or necessary to the management of the site (Natura 2000 sites) but likely to have significant effect thereon, either individually or in combination with other plans or projects, shall be subject to Appropriate Assessment of its implications for the site in view of the site's conservation objectives. In the light of the conclusions of the assessment of the implications for the site and subject to the provisions of paragraph 4, the competent national authorities shall agree to the plan or project only after having ascertained that it will not adversely affect the integrity of the site concerned and, if appropriate, after having obtained the opinion of the general public".

Therefore, the AA process is an assessment of the following key concepts:

- Whether a plan or project can be excluded from AA requirements because it is directly connected with or necessary to the management of a European site.
- Whether the project will have a potentially significant effect on a European site, either alone or in combination with other projects or plans, in view of the site's conservation objectives or if residual uncertainty exists regarding potential impacts.



The provisions of Article 6(3) do not apply where the proposed plan or project is ‘connected with or necessary to the management of the site’. Where a formal consent process applies, the AA process is concluded by the relevant competent authority making a determination in accordance with article 6(3) of the Habitats Directive.

1.2 Guidance

- The assessment was conducted in accordance with the following guidance:
- Assessment of Plans and Projects Significantly Affecting Natura 2000 Sites: Methodological guidance on the provisions of Article 6(3) and (4) of the Habitats Directive 92/43/EEC, Office for Official Publications of the European Communities, Luxembourg (European Commission, 2002).
 - This document was updated by Assessment of plans and projects in relation to Natura 2000 sites - Methodological guidance on Article 6(3) and (4) of the Habitats Directive 92/43/EEC. Commission Notice (2021) Brussels, 28.9.2021 C(2021) 6913 final;
- Appropriate Assessment of Plans and Projects in Ireland: Guidance for Planning Authorities. National Parks and Wildlife Service, Department of the Environment, Heritage and Local Government, Dublin (2009, updated 2010);
- Commission Notice: Managing Natura 2000 sites. The provisions of Article 6 of the Habitats Directive 92/43/EEC. European Commission (2018). Brussels, (2019/C 33/01). OJ C 33, 25.1.2019;
- Interpretation Manual of European Union Habitats. Version EUR 28. European Commission 2013;
- OPR Practice Note PN01 Appropriate Assessment Screening for Development Management, Office of the Planning Regulator (2021).

1.3 Assessment Process and Approach

The assessment commences with a description of the receiving environment, along with a description of the project and the associated sources for impacts to the receiving environment which may arise through interactions on same. All elements of the project are presented including the proposed project location and existing baseline environment. The type of impacts that are likely due to the proposed project are identified having regard to the spatial and temporal scale of the project, resource requirements and likely emissions; these sources are then used to define the zone of influence (ZoI)¹ of the project as detailed in in Section 2.3.

The European Commission Notice (2021) on the ‘Assessment of plans and projects in relation to Natura 2000 sites – Methodological guidance on Article 6(3) and (4) of the Habitats Directive 92/43/EEC, states that in identifying European sites (Natural 2000 sites), which may be affected by the project, the following should be identified:

- Any European sites geographically overlapping with any of the actions or aspects of the plan or project in any of its phases, or adjacent to them;
- Any European sites within the likely zone of influence of the plan or project. European sites located in the surroundings of the plan or project (or at some distance) that could still be indirectly affected by aspects of the project, including as regards the use of natural resources (e.g., water) and various types of waste, discharge or emissions of substances or energy;
- European sites whose connectivity or ecological continuity can be affected by the plan or project.

¹ The zone of influence is the area which the sources for impacts are likely to have effect - emanating outwards from the subject lands.



An ecological desktop study has been completed for the AA screening of the proposed project, which comprised the following elements:

- Identification of European sites within 15km² of the subject lands;
- Identification of European sites pathways for effects from the site (if relevant³) greater than 15km from the subject lands;
- Review of the NPWS site synopses and conservation objectives for European sites within 15km and for which potential pathways from the proposed site have been identified; and
- Examination of available information on protected species.

Section 3.1 sets out the detailed rationale for the identification of relevant European sites looking at the ZOI (as explained above) and the potential interactions due to ecological connectivity with the ZOI. Subsequently, an assessment process is undertaken with respect to potential connectivity to European Sites and their qualifying interests/special conservation interests are identified.

The process of determining the likelihood of significant effects from a proposed project on European sites is an iterative process centred around a Source-Pathway-Receptor (S-P-R) model. In order for an effect to be established, all three elements of this mechanism must be in place. The absence or removal of one of the elements of the mechanism is sufficient to conclude that a potential effect is not of any relevance or significance.

- Source(s) – e.g., pollutant run-off, noise, removal of vegetation etc.;
- Pathway(s) – ecological connectivity linkages e.g., groundwater connecting to nearby qualifying wetland habitats; and,
- Receptor(s) – ecological resources supporting the qualifying habitats and species of European sites.

In the context of this report, a receptor is an ecological feature that is known to be utilised by the Qualifying Interests (QI) or Special Conservation Interests (SCI) of a European site. A source is any identifiable element of the proposed project that is known to interact with ecological processes. A pathway is any connection or link between the source and the receptor⁴.

An important element of the AA process is the identification of the Conservation Objectives, QIs and/ or SCIs of European sites requiring assessment. QIs are the habitat features and species listed in Annexes I and II of the Habitats Directive for which each European site has been designated and afforded protection. SCIs are wetland habitats and bird species listed within Annexes I and II of the Birds Directive. It is also vital that the threats to the ecological / environmental conditions that are required to support QIs and SCIs are considered as part of the assessment.

² While the actual zone of influence is likely to be much smaller, the initial 15km radius has been applied as a starting point which can be amended later in the assessment process (where appropriate as supported by a detailed rationale) - further detail on this is identified in section 3.2

³ This is particularly relevant for all sites with hydrological connectivity or other significant ecological pathways

⁴ qualifying interest or special conservation interests of the European site in question and the known sensitivities of these key ecological receptors



The potential for in-combination effects with other plans and projects is also assessed having regard to the identified impacts of the proposed project relative to the spatial temporal effects along the ecological pathways identified (see Section 3.2).

The likelihood of significant effects on the European Sites is then interrogated having regard to the sensitivity of each European site with pathways for impacts associated with the proposed project on its own and in combination with other plans and projects. Where significant effects are determined to be likely, or where there is uncertainty regarding the likelihood of significant effects, the proposed project will be required under law to be subjected to stage 2 AA and the preparation of a Natura Impact Statement (NIS).

Having regard to the European Commission Communication on the Precautionary Principle (European Commission, 2000) the:

“absence of scientific evidence on the significant negative effect of an action cannot be used as justification for approval of this action. When applied to Article 6(3) procedure, the precautionary principle implies that the absence of a negative effect on Natura 2000 sites has to be demonstrated before a plan or project can be authorised. In other words, if there is a lack of certainty as to whether there will be any negative effects, then the plan or project cannot be approved.”

This AA screening is based on best scientific knowledge and has utilised ecological expertise. In addition, a detailed online review of published scientific literature and ‘grey’ literature was conducted. This included a detailed review of the National Parks and Wildlife Website including mapping and available reports for relevant sites and in particular sensitive qualifying interests/special conservation interests described and their conservation objectives.



2. EXISTING SITE AND PROJECT DESCRIPTION

2.1 Receiving Environment

The development site is located off Lehaunstown Lane, Laughtanstown, Co. Dublin. The site is located within the Cherrywood Planning Scheme Strategic Development Zone (SDZ).

It consists of a rectangular plot of land in agricultural use with an area of approximately 3.58 hectares. The site comprises a dry neutral grassland.

The southern and western boundaries consist of mature hedge rows. The north-western corner of the site shares a boundary with a private residence. This boundary consists of hedging and planting reinforced with sections of block wall. The northern boundary consists of mature hedging and ditch. A combined drain runs along this northern boundary cutting across the site at the lowest level and following the valley floor. An overhead ESB line runs across the NW corner of the site.

Existing one-off houses, accessed from Lehaunstown Lane are located along the northwest boundary of the site with one of the properties, a single-storey bungalow occupying the northwest corner of what would once have been part of the original field that makes up this site. The adjacent land to the south and west consists of fields.

The site is currently accessed from Lehaunstown Lane via a narrow, gated path that is understood to be the original field access.

The soils on site are fine loamy drift with siliceous stones with a mix of granite and limestone till subsoils.

A topographical survey for the site shows it slopes down from an elevation of 46 m at the western boundary towards the water course on its eastern boundary at 23 m elevation.

There are no known protected heritage features present on-site or in the immediate vicinity of the site.

The area surrounding the site is primarily urbanised in nature. There are also various improved grasslands, hedgerows, scrub and treelines in the surrounding area.

The site is located within Hydrometric Area No. 10 Ovoca-Vartry and within the Dargle_040 sub catchment.

The site is located immediately adjacent to the Carrickmines Stream (10C04) (and riparian area) which ultimately flows into the Irish Sea approximately 2 km to the east of the site. As such there is direct connectivity between the site and the Irish Sea.

Three tufa springs are situated directly to the south of the site. Certain areas of the site lie within the catchment for these tufa springs.

A Site Location Map depicting the site and the surrounding area and hydrology is presented in Figure 2-1.



- Legend**
- Site Boundary
 - Townlands
 - ~ Rivers

TITLE:	Site Location and Hydrological Connectivity	
PROJECT:	Lehaunstown Lane Development AA Screening	
FIGURE NO:	2.1	
CLIENT:	Dún Laoghaire Rathdown County Council	
SCALE:	1:5,000	REVISION: 0
DATE:	10/12/2025	PAGE SIZE: A3

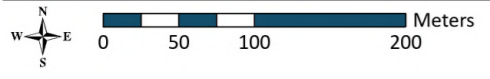



Proposed Project

The proposed development consists of 109 residential units made up of terraced houses, duplexes and apartment buildings ranging in height from 2 to 4 storeys organised around a hierarchy of pedestrian-oriented spaces together with associated 47 surface and 43 underground parking spaces, ESB substations, 188 cycle parking spaces, communal and public open space and associated landscaping.

The development site will be accessed via a new road connecting to The Parade. This road is being delivered through Section 179A of the Planning and Development Act, as amended.

The proposed development is predicated on a strong, distinctive urban form and a pedestrian friendly public realm. The public open spaces are defined by terraces of residential units – houses and apartments with an emphasis on pedestrian connectivity within the context of the Cherrywood SDZ.

The project, a residential enclave defined by existing field boundaries and overlooking the Carrickmines River valley, consists of terraced houses, duplexes and apartment buildings ranging in height from 2 to 4 storeys organised around a hierarchy of pedestrian-oriented spaces that look to mitigate the impact of cars. These spaces are referred to as 1.) 'The Mall', an approach road that connects with the proposed adjacent infrastructural road to the west, and a central public space –2,) 'The Square' which acts as the primary focus for the community. Car parking is provided as on-street parking, off-street parking, and underground parking for apartments.

The project looks to work with existing site characteristics and constraints so as to create a coherent development that responds to context. In particular, the project looks to 1) engage with the existing and proposed Green Infrastructure in particular the riparian landscape of the Carrickmines River Valley; 2) Avail of views eastwards over the valley towards the sea; 3) Incorporate existing protected hedgerows that bound the site into an overall landscape concept; 4) Work with the existing topography which varies significantly in gradient from 1:16 to 1:6.

A Site Plan depicting the layout of the proposed development is presented in Figure 2-2.

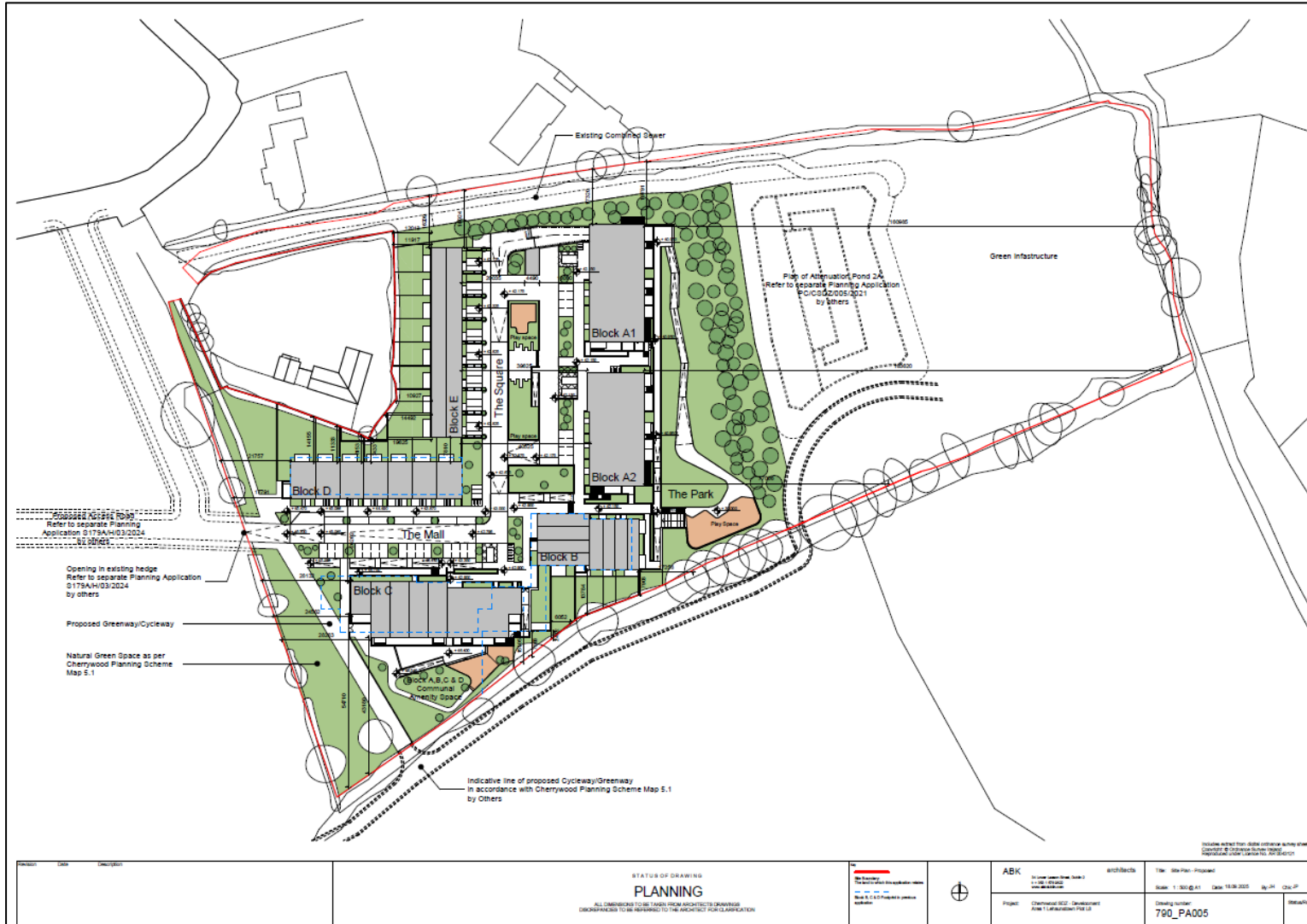

Figure 2-2: Site Plan



2.2 Potential Interactions of the Proposed Project with the Receiving Environment

The construction phase of the proposed development has potential to generate the following sources of environmental impacts:

- Resource use
- Loss of dry neutral grassland and minor hedgerow/trees.
- Run-off of polluting material to the environment (e.g., cement material, silt).
- Impacts on hydrology/hydrogeology.
- Noise emissions from construction works, vehicles and plant.
- Dust emissions from construction works, e.g. earthworks.
- Increased traffic from construction vehicles.
- Energy and resource use.

The operational phase of the proposed development has the potential to generate the following sources of environmental impacts

- Noise emissions associated with residential activity.
- Lighting impacts.
- Greenhouse gas (GHG) emissions associated with energy use at the proposed development.
- Increased traffic in the local area
- Energy and resource use.



3. SCREENING FOR APPROPRIATE ASSESSMENT

3.1 Identification of European Sites that may be affected by the Proposed project

This section of the screening process describes the European sites which have potential to interact with the Zone of Influence (ZOI) of the proposed project. The zone of influence is the area which the sources for impacts are likely to have an effect on - emanating outwards from the subject lands. An assessment of the sources for potential interaction with the receiving environment (see Section 2.3) was undertaken - this identified that effects from the proposed project are likely to be localised to within 1 km of the redline - in the absence of hydrological pathways - given the nature of the sources identified. The Environment, Heritage and Local Government (2009) Guidance on AA recommends a 15 km zone to be considered. There are two key considerations when identifying potential effects to key ecological receptors (KERs):

- The first is the distance from which potential sources for effects can radiate from the proposed project - referred to as the zone of influence (ZOI)
- The second is the potential for sensitive receptors (QIs/SCIs) to interact with the ZOI which is a further pathway consideration zone (PCZ). The PCZ examines ecological connectivity corridors, dominant ranging patterns of species, linkages through the landscape through hydrology etc.

Therefore, a radius of 1 km has been adopted as the ZOI and a 15 km radius⁵ was adopted as the PCZ for this AA - however, further considerations were given to hydrological pathways from the proposed project extending beyond the 15km limit.

European sites identified to have ecological connectivity pathways for potential effects from the proposed project are listed in Table 3-1 and illustrated in Figure 3-1 below. Information on European sites is presented in Appendices 1 - 4.

In order to determine the potential effects of the proposal, information on the qualifying features, known vulnerabilities and threats to site integrity pertaining to any potentially affected European sites has been reviewed. Background information on threats to individual sites and vulnerability of habitats and species that was used during this assessment included the following:

- Ireland's Article 17 Report to the European Commission "Status of EU Protected Habitats and Species in Ireland" (NPWS, 2019);
- Ireland's Article 12 Report to the European Commission "Bird species' status and trends reporting format for the period 2008-2012-" (NPWS, 2012)
- Site Synopses⁶; and
- NATURA 2000 Standard Data Forms⁷.

⁵ It is understood that sites designated for vagile species are known to utilise isolated resources across the landscape which could intersect with the localised ZOI; however, beyond 15km potential effects to such species are not identified to be significant due the broad home range available to these species and the availability of alternate resources at a landscape scale; in the context of the sources for potential effects identified above.

⁶ NPWS (2019); NPWS Database of protected site data and associated documents for each European site; available at <https://www.npws.ie/protected-sites>; last accessed December 2025.

⁷ NPWS (2019); NPWS Database of protected site data and associated documents for each European site; available at <https://www.npws.ie/protected-sites>; last accessed last accessed December 2025.



The assessment considers the SSCOs of each of the sites within the ZOI and PCZ. Since the conservation objectives for the European sites focus on maintaining the favourable conservation condition of the QIs/SCIs of each site, the screening process has concentrated on assessing the potential effects of the proposed project against the QIs/SCIs of each site. The conservation objectives for each site have been taken into account throughout the assessment process (See Appendix 4 for list of conservation objectives).

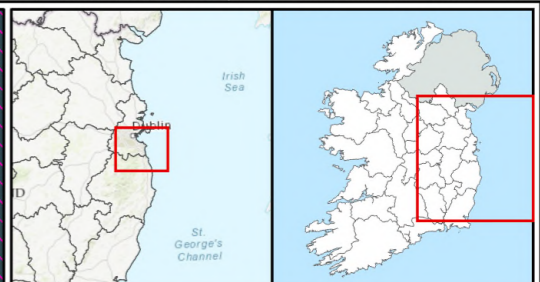
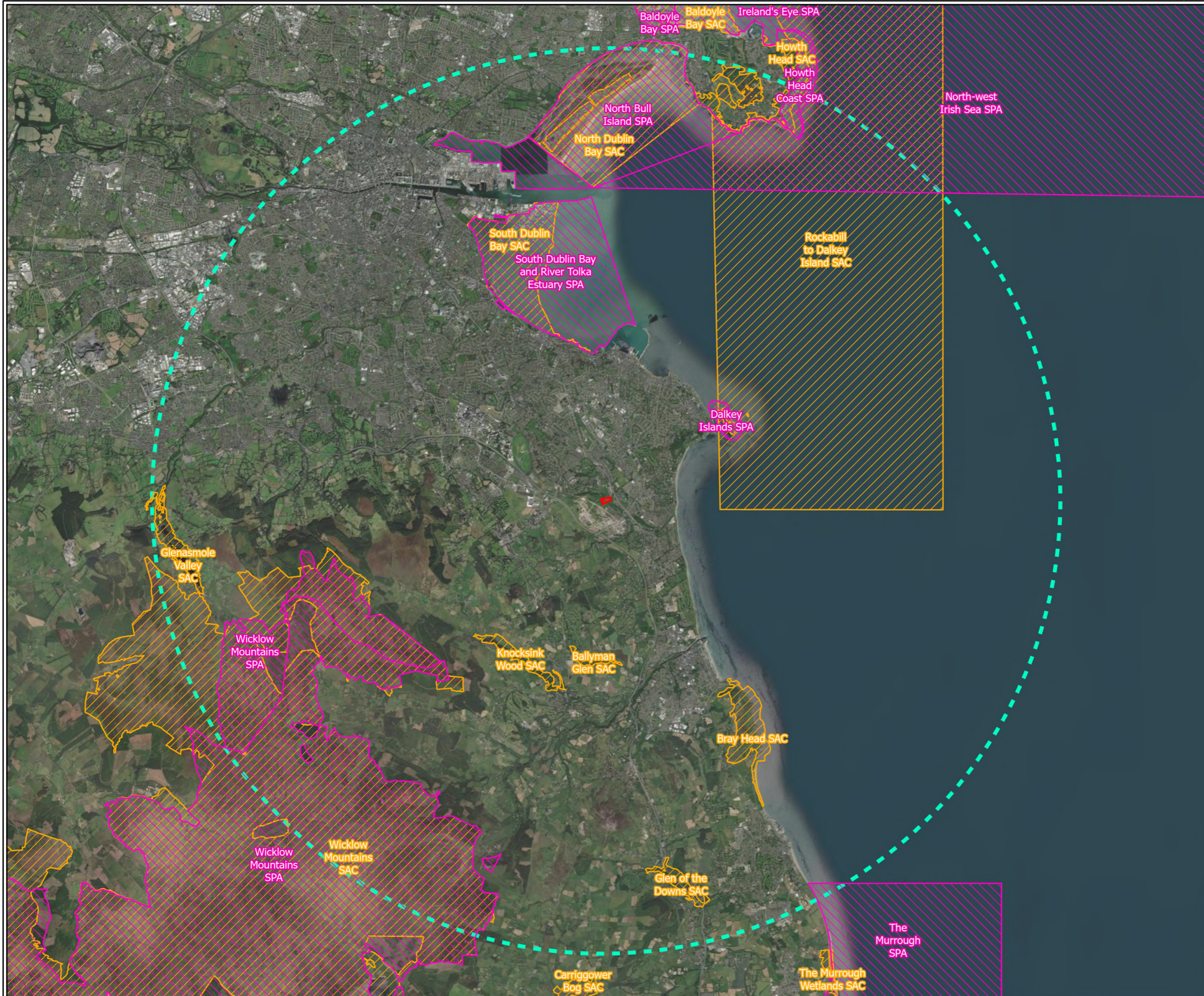

Legend

- Site Boundary
- 15km
- Special Protection Areas
- Special Area of Conservation

TITLE:	European Sites within Zone of Influence	
PROJECT:	Lehaunstown Lane Development AA Screening	
FIGURE NO.:	3.1	
CLIENT:	Dún Laoghaire Rathdown County Council	
SCALE:	1:125,000	REVISION: 0
DATE:	10/12/2025	PAGE SIZE: A3

FEHILY TIMONEY Cork | Dublin | Carlow www.fehilytimoney.ie





Table 3-1: Screening assessment of the potential effects arising from the proposed project on European sites within the Zone of Influence and Pathway Consideration Zone (listed according to distance)

Site Code	Site Name	Distance (km)	Qualifying Feature (qualifying interests & special conservation interests)	Potential Effects	Pathway for Significant Effects
003000	Rockabill to Dalkey Island SAC	3.64	Reefs [1170], Harbour porpoise (<i>Phocoena phocoena</i>) [1351]	The SAC is sensitive to hydrological interactions and direct land use management activities. The proposed project is indirectly linked to the SAC through the marine environment which introduces significant dilution effects. There are no sources with meaningful ecological pathways for effects to this SAC considering the sensitivity of the QI species.	No
004172	Dalkey Islands SPA	4.31	Roseate tern (<i>Sterna dougallii</i>) [A192], Common tern (<i>Sterna hirundo</i>) [A193], Arctic tern (<i>Sterna paradisaea</i>) [A194]	The SPA is sensitive to hydrological interactions, disturbance effects and direct land use management activities. The proposed project is indirectly linked to the SPA through the marine environment which introduces significant dilution effects. There are no sources with meaningful ecological pathways for effects to this SPA considering the sensitivity of the SCI species. There are no habitats on site which provide suitable habitat for the tern species for which the site is designated.	No
000713	Ballyman Glen SAC	4.84	Alkaline fens [7230], Petrifying springs with tufa formation (Cratoneurion) [7220]	The SAC is sensitive to groundwater interactions, disturbance effects and direct land use management activities. Given the sources for impacts identified in Section 2 and the context, there are no pathways for effects to the SAC.	No
004024	South Dublin Bay and River Tolka Estuary SPA	4.87	Redshank (<i>Tringa totanus</i>) [A162], Roseate Tern (<i>Sterna dougallii</i>) [A192], Common tern (<i>Sterna hirundo</i>) [A193], Dunlin (<i>Calidris alpina</i>) [A149], Bar-tailed Godwit (<i>Limosa lapponica</i>) [A157], Light-bellied Brent Goose (<i>Branta bernicla hrota</i>) [A046], Arctic tern (<i>Sterna paradisaea</i>) [A194], Ringed Plover (<i>Charadrius</i>	The hydrologically sensitive habitats and species of this SPA are highly sensitive to changes in siltation loads, the distribution of silt loads, pollutants, water levels, and anthropogenic disturbance.	No



Site Code	Site Name	Distance (km)	Qualifying Feature (qualifying interests & special conservation interests)	Potential Effects	Pathway for Significant Effects
			hiaticula) [A137], Oystercatcher (Haematopus ostralegus) [A130], Grey Plover (Pluvialis squatarola) [A141], Wetland and Waterbirds [A999], Knot (Calidris canutus) [A143], Sanderling (Calidris alba) [A144], Black-headed Gull (Chroicocephalus ridibundus) [A179]	The proposed project is indirectly linked to the SPA through the marine environment which introduces significant dilution effects. There are no sources with meaningful ecological pathways for effects to this SPA considering the sensitivity of the SCI species. There are no habitats on site which provide suitable habitat for the wading bird species for which the site is designated.	
000210	South Dublin Bay SAC	4.90	Annual vegetation of drift lines [1210], Salicornia and other annuals colonising mud and sand [1310], Embryonic shifting dunes [2110], Mudflats and sandflats not covered by seawater at low tide [1140]	The hydrologically sensitive habitats of this SAC are highly sensitive to changes in siltation loads, the distribution of silt loads, pollutants and water levels, and anthropogenic disturbance. The proposed project is indirectly linked to the SAC through the marine environment which introduces significant dilution effects. There are no sources with meaningful ecological pathways for effects to this SAC considering the sensitivity of the QI species.	No
000725	Knocksink Wood SAC	5.56	Petrifying springs with tufa formation (Cratoneurion) [7220], Alluvial forests with Alnus glutinosa and Fraxinus excelsior (Alno-Padion, Alnion incanae, Salicion albae) [91E0], Old sessile oak woods with Ilex and Blechnum in the British Isles [91A0]	The SAC is sensitive to groundwater interactions, surface water interactions, disturbance effects and direct land use management activities. Given the sources for impacts identified in Section 2 and the context, there are no pathways for effects to the SAC.	No
000714	Bray Head SAC	7.14	Vegetated sea cliffs of the Atlantic and Baltic Coasts [1230], European dry heaths [4030]	The SAC is sensitive to direct land use management activities. Given the sources for impacts identified in Section 2 and the context, there are no pathways for effects to the SAC.	No
002122	Wicklow Mountains SAC	7.43	Siliceous rocky slopes with chasmophytic vegetation [8220], Alpine and Boreal heaths [4060], Old sessile oak woods with Ilex and Blechnum in the British Isles [91A0], European dry heaths [4030], Blanket bogs * if active bog [7130], Natural dystrophic lakes and ponds	The SAC is sensitive to disturbance effects, direct land use management activities and hydrological interactions.	No



Site Code	Site Name	Distance (km)	Qualifying Feature (qualifying interests & special conservation interests)	Potential Effects	Pathway for Significant Effects
			[3160], Otter (<i>Lutra lutra</i>) [1355], Siliceous scree of the montane to snow levels (<i>Androsacetalia alpinae</i> and <i>Galeopsietalia ladani</i>) [8110], Oligotrophic waters containing very few minerals of sandy plains (<i>Littorelletalia uniflorae</i>) [3110], Species-rich <i>Nardus</i> grasslands, on siliceous substrates in mountain areas - and submountain areas in Continental Europe [6230], Calcareous rocky slopes with chasmophytic vegetation [8210], Calaminarian grasslands of the <i>Violetalia calaminariae</i> [6130], Northern Atlantic wet heaths with <i>Erica tetralix</i> [4010]	Given the sources for impacts identified in Section 2 and the context, there are no pathways for effects to the SAC.	
004040	Wicklow Mountains SPA	7.43	Merlin (<i>Falco columbarius</i>) [A098], Peregrine falcon (<i>Falco peregrinus</i>) [A103]	The SPA is sensitive to disturbance effects and direct land use management activities. There are no sources with meaningful ecological pathways for effects to this SPA considering the sensitivity of the SCI species. There are no habitats on site which provide suitable habitat for the bird of prey species for which the site is designated.	No
004236	North-west Irish Sea SPA	10.33	Red-throated Diver (<i>Gavia stellata</i>) [A001], Great Northern Diver (<i>Gavia immer</i>) [A003], Fulmar (<i>Fulmarus glacialis</i>) [A009], Manx Shearwater (<i>Puffinus puffinus</i>) [A013], Cormorant (<i>Phalacrocorax carbo</i>) [A017], Shag, (<i>Phalacrocorax aristotelis</i>) [A018], Common Scoter (<i>Melanitta nigra</i>) [A065], Black-headed Gull (<i>Chroicocephalus ridibundus</i>) [A179], Common Gull (<i>Larus canus</i>) [A182], Lesser Black-backed Gull (<i>Larus fuscus</i>) [A183], Herring Gull (<i>Larus argentatus</i>) [A184], Great Black-backed Gull (<i>Larus marinus</i>) [A187], Kittiwake (<i>Rissa tridactyla</i>) [A188], Roseate Tern (<i>Sterna dougallii</i>) [A192], Common Tern (<i>Sterna hirundo</i>) [A193], Arctic Tern (<i>Sterna paradisaea</i>) [A194], Guillemot (<i>Uria aalge</i>) [A199], Razorbill (<i>Alca torda</i>) [A200], Puffin (<i>Fratercula</i>	The proposed project is indirectly linked to the SPA through the marine environment which introduces significant dilution effects. There are no sources with meaningful ecological pathways for effects to this SPA considering the sensitivity of the SCI species. There are no habitats on site which provide suitable habitat for the tern species for which the site is designated.	No



Site Code	Site Name	Distance (km)	Qualifying Feature (qualifying interests & special conservation interests)	Potential Effects	Pathway for Significant Effects
			arctica) [A204], Little Gull (<i>Hydrocoloeus minutus</i>) [A862], Little Tern (<i>Sternula albifrons</i>) [A885]		
004006	North Bull Island SPA	10.36	Golden Plover (<i>Pluvialis apricaria</i>) [A140], Black-tailed Godwit (<i>Limosa limosa</i>) [A156], Pintail (<i>Anas acuta</i>) [A054], Wetland and Waterbirds [A999], Dunlin (<i>Calidris alpina</i>) [A149], Oystercatcher (<i>Haematopus ostralegus</i>) [A130], Light-bellied Brent Goose (<i>Branta bernicla hrota</i>) [A046], Black-headed Gull (<i>Chroicocephalus ridibundus</i>) [A179], Grey Plover (<i>Pluvialis squatarola</i>) [A141], Turnstone (<i>Arenaria interpres</i>) [A169], Shelduck (<i>Tadorna tadorna</i>) [A048], Redshank (<i>Tringa totanus</i>) [A162], Teal (<i>Anas crecca</i>) [A052], Sanderling (<i>Calidris alba</i>) [A144], Curlew (<i>Numenius arquata</i>) [A160], Shoveler (<i>Anas clypeata</i>) [A056], Knot (<i>Calidris canutus</i>) [A143], Bar-tailed Godwit (<i>Limosa lapponica</i>) [A157]	The hydrologically sensitive species of this SPA are highly sensitive to changes in siltation loads, the distribution of silt loads, pollutants, water levels and anthropogenic disturbance. The proposed project is indirectly linked to the SPA through the marine environment which introduces significant dilution effects. There are no sources with meaningful ecological pathways for effects to this SPA considering the sensitivity of the SCI species. There are no habitats on site which provide suitable habitat for the wading bird species for which the site is designated.	No
000206	North Dublin Bay SAC	10.38	Fixed coastal dunes with herbaceous vegetation - grey dunes [2130], Petalwort (<i>Petalophyllum ralfsii</i>) [1395], Mudflats and sandflats not covered by seawater at low tide [1140], Embryonic shifting dunes [2110], Shifting dunes along the shoreline with <i>Ammophila arenaria</i> - white dunes [2120], Annual vegetation of drift lines [1210], Humid dune slacks [2190], <i>Salicornia</i> and other annuals colonising mud and sand [1310], Mediterranean salt meadows (<i>Juncetalia maritimi</i>) [1410], Atlantic salt meadows (<i>Glauco-Puccinellietalia maritima</i>) [1330]	The SAC is sensitive to land use management and hydrological and groundwater interactions. Given the sources for impacts identified in Section 2 and the context, there are no pathways for effects to the SAC.	No
000202	Howth Head SAC	12.84	European dry heaths [4030], Vegetated sea cliffs of the Atlantic and Baltic Coasts [1230]	The SAC is sensitive to direct land use management activities and hydrological interactions. Given the sources for impacts identified in Section 2 and the context, there are no pathways for effects to the SAC.	No



Site Code	Site Name	Distance (km)	Qualifying Feature (qualifying interests & special conservation interests)	Potential Effects	Pathway for Significant Effects
001209	Glenasmole Valley SAC	13.59	Molinia meadows on calcareous, peaty or clayey-silt-laden soils (Molinion caeruleae) [6410], Petrifying springs with tufa formation (Cratoneurion) [7220], Semi-natural dry grasslands and scrubland facies on calcareous substrates (Festuco-Brometalia) * important orchid sites [6210]	<p>The SAC is sensitive to direct land use management activities, groundwater and hydrological interactions.</p> <p>Given the sources for impacts identified in Section 2 and the context, there are no pathways for effects to the SAC.</p>	No
004113	Howth Head Coast SPA	13.52	Kittiwake (Rissa tridactyla) [A188]	<p>The SPA is sensitive to hydrological interactions, disturbance effects and direct land use management activities.</p> <p>The proposed project is indirectly linked to the SPA through the marine environment which introduces significant dilution effects. There are no sources with meaningful ecological pathways for effects to this SPA considering the sensitivity of the SCI species. There are no habitats on site which provide suitable habitat for the wading bird species for which the site is designated.</p>	No



3.2 Other plans and projects considered for potential in-combination effects

Article 6(3) of the Habitats Directive requires an assessment of whether a plan or project may generate adverse effects on European sites in-combination with other plans or projects. An assessment of the in-combination effects of the proposed project was undertaken. All appropriately focussed plans and projects that may interact with the proposed project were considered during this in-combination assessment. This in-combination considered the sources of impact associated with the proposed project, in addition to the following criteria:

- Direct or indirect connectivity to a European site.
- Proximity to a European site.
- Scale of the proposed development.
- Range of potential impacts
- Sources of impact that may affect ecological receptors.
- Additive or interacting impacts

The in-combination assessment for the proposed project is presented in Appendix 5. This assessment was informed by an exhaustive review of planning history within 500 m of the development site over the last 5 years.

The proposed project is consistent with the Dún Laoghaire – Rathdown County Council Development Plan 2022-2028 and the Cherrywood SDZ and aligns with the Strategic Environmental Objectives for these plans. It does not have the potential to interact with these plans to create 'in-combination' adverse effects on any European site.

Other planned projects in the area include:

- Residential development (e.g., development in the Cherrywood Strategic Development Zone).
- Transport infrastructure development (e.g., BusConnects Bray to City Centre Core Bus Corridor Scheme).
- Surface water drainage development.
- Amenity/recreation development.

The proposed development does not have the potential to result in likely, significant effects on the integrity of European sites, in-combination with any other development.



4. AA SCREENING CONCLUSION

This stage one screening for AA of the proposed project demonstrates that the proposed project is not likely to have significant effects on any European site.

The AA screening process has considered potential effects which may arise during the construction and operational phases as a result of the implementation of the proposed project. Through an assessment of the pathways for effects and an evaluation of the sources for impacts, taking account of the processes involved and the distance of separation from European sites, it has been evaluated that there are no likely significant adverse effects on the qualifying interests, special conservation interest or the conservation objectives of any designated European site.

The proposed project is 3.64 km away from the closest SAC and 4.31 km away from the closest SPA. Given the characteristics, small-scale and short-term nature of the sources for impacts from the proposed project, it is concluded that the proposed project will not give rise to any significant adverse effects on any designated European sites, alone or in combination with other plans or projects. This evaluation is made in view of the conservation objectives of the habitats or species for which these sites have been designated.



DESIGNING AND DELIVERING
A SUSTAINABLE FUTURE

APPENDIX 1

Background Information on
European Sites

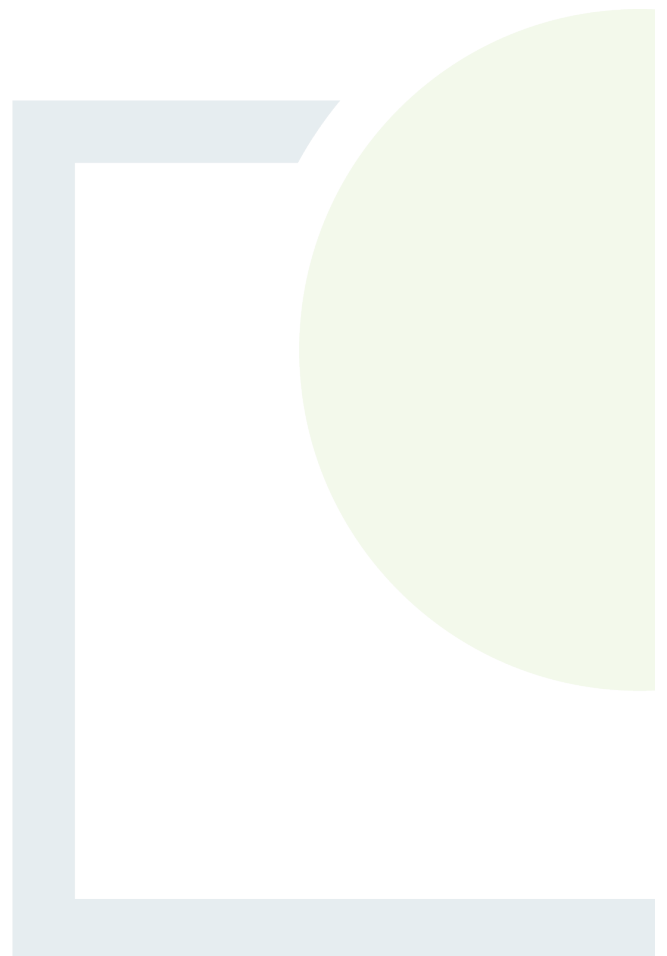

European Sites with Functional Connectivity (Ecological Pathways) to the Area Including their Qualifying Interests, Known Threats and Pressures

Site Code	Site Name	Qualifying Feature	Pressures Codes	Known Threats and Pressures
000202	Howth Head SAC	European dry heaths [4030], Vegetated sea cliffs of the Atlantic and Baltic Coasts [1230]	C01, A04.03, X, E01, C01.01.01, J01.01, I01, G05.04, D01.01, G01.02	Mining and quarrying, Abandonment of pastoral systems lack of grazing, No threats or pressures, Urbanised areas, human habitation, Sand and gravel quarries, burning down, Invasive non-native species, Vandalism, Paths, tracks, cycling tracks, Walking, horseriding and non-motorised vehicles
000206	North Dublin Bay SAC	Shifting dunes along the shoreline with <i>Ammophila arenaria</i> - white dunes [2120], <i>Salicornia</i> and other annuals colonising mud and sand [1310], <i>Petalwort</i> (<i>Petalophyllum ralfsii</i>) [1395], Annual vegetation of drift lines [1210], Embryonic shifting dunes [2110], Mediterranean salt meadows (<i>Juncetalia maritimi</i>) [1410], Mudflats and sandflats not covered by seawater at low tide [1140], Humid dune slacks [2190], Atlantic salt meadows (<i>Glauco-Puccinellietalia maritimae</i>) [1330], Fixed coastal dunes with herbaceous vegetation - grey dunes [2130]	K03.06, J01.01, H01.09, G01.02, G05.05, F02.03.01, A04, G02.01, I01, E01, E02, H01.03, E03, G01.01, F02.03	Antagonism with domestic animals, Burning down, Diffuse pollution to surface waters due to other sources not listed, Walking, horseriding and non-motorised vehicles, Intensive maintenance of public parks or cleaning of beaches, Bait digging or collection, Grazing, Golf course, Invasive non-native species, Urbanised areas, human habitation, Industrial or commercial areas, Other point source pollution to surface water, Discharges, Nautical sports, Leisure fishing
000210	South Dublin Bay SAC	<i>Salicornia</i> and other annuals colonising mud and sand [1310], Embryonic shifting dunes [2110], Mudflats and sandflats not covered by seawater at low tide [1140], Annual vegetation of drift lines [1210]	E02, K02.02, D01.02, G01.01.02, M01, E03, J02.01.02, K02, H03, G01.01, G01.02, D01.01, E01, F02.03.01	Industrial or commercial areas, Accumulation of organic material, Roads, motorways, non-motorized nautical sports, Changes in abiotic conditions, Discharges, Reclamation of land from sea, estuary or marsh, Biocenotic evolution, succession, Marine water pollution, Nautical sports, Walking, horseriding and non-motorised vehicles, Paths, tracks, cycling tracks, Urbanised areas, human habitation, Bait digging or collection
000713	Ballyman Glen SAC	Alkaline fens [7230], Petrifying springs with tufa formation (<i>Cratoneurion</i>) [7220]	A01, E01.01, A08, E01.02, A04, C01.01, E03.01, D01.02, A10.01, H01.03, H02.01, B01	Cultivation, Continuous urbanisation, Fertilisation, Discontinuous urbanisation, Grazing, Sand and gravel extraction, Disposal of household or recreational facility waste, Roads, motorways, Removal of hedges and copses or scrub, other point source pollution to surface water, Groundwater pollution by leakages from contaminated sites, Forest planting on open ground
000714	Bray Head SAC	Vegetated sea cliffs of the Atlantic and Baltic Coasts [1230], European dry heaths [4030]	A10.01, D01.01, K01.01, K02.01, G01.03, G05.04, E01, J01.01, A04.02.01	Removal of hedges and copses or scrub, Paths, tracks, cycling tracks, Erosion, Species composition change (succession), Motorised vehicles, Vandalism, Urbanised areas, human habitation, Burning down, Non intensive cattle grazing

Site Code	Site Name	Qualifying Feature	Pressures Codes	Known Threats and Pressures
000725	Knocksink Wood SAC	Alluvial forests with <i>Alnus glutinosa</i> and <i>Fraxinus excelsior</i> (Alno-Padion, <i>Alnion incanae</i> , <i>Salicion albae</i>) [91E0], Old sessile oak woods with <i>Ilex</i> and <i>Blechnum</i> in the British Isles [91A0], Petrifying springs with tufa formation (Cratoneurion) [7220]	G05.07, B01, D01.02, I01, A04, G05.06, G05.04, G02.08, G03, E01.02, E03.01, D01.01, B02.03, G01.02, D05, B01.02	Missing or wrongly directed conservation measures, Forest planting on open ground, Roads, motorways, Invasive non-native species, Grazing, Tree surgery, felling for public safety, removal of roadside trees, Vandalism, Camping and caravans, Interpretative centres, Discontinuous urbanisation, Disposal of household or recreational facility waste, Paths, tracks, cycling tracks, Removal of forest undergrowth, Walking, horseriding and non-motorised vehicles, Improved access to site, Artificial planting on open ground (non-native trees)
001209	Glensmole Valley SAC	Petrifying springs with tufa formation (Cratoneurion) [7220], Molinia meadows on calcareous, peaty or clayey-silt-laden soils (<i>Molinia caerulea</i>) [6410], Semi-natural dry grasslands and scrubland facies on calcareous substrates (<i>Festuco-Brometalia</i>) * important orchid sites [6210]	A03.03, A04.02.03, A04, A08, J02, B01.02, F02.03, A04.02.02, H02.07, A03, D01, I01, A04.02.01, B01.01, E01.02, H01.08, B02.02, C01.03, D01.03, H01.05, B02.01.02	Abandonment or lack of mowing, Non intensive horse grazing, Grazing, Fertilisation, Human induced changes in hydraulic conditions, Artificial planting on open ground (non-native trees), Leisure fishing, Non intensive sheep grazing, Diffuse groundwater pollution due to non-sewered population, Mowing or cutting of grassland, Roads, paths and railroads, Invasive non-native species, Non intensive cattle grazing, Forest planting on open ground (native trees), Discontinuous urbanisation, Diffuse pollution to surface waters due to household sewage and waste waters, Forestry clearance, Peat extraction, Car parks and parking areas, Diffuse pollution to surface waters due to agricultural and forestry activities, Forest replanting (non-native trees)
002122	Wicklow Mountains SAC	Siliceous scree of the montane to snow levels (<i>Androsacetalia alpinae</i> and <i>Galeopsietalia ladani</i>) [8110], Otter (<i>Lutra lutra</i>) [1355], Old sessile oak woods with <i>Ilex</i> and <i>Blechnum</i> in the British Isles [91A0], European dry heaths [4030], Species-rich <i>Nardus</i> grasslands, on siliceous substrates in mountain areas and submountain areas in Continental Europe [6230], Northern Atlantic wet heaths with <i>Erica tetralix</i> [4010], Natural dystrophic lakes and ponds [3160], Blanket bogs * if active bog [7130], Oligotrophic waters containing very few minerals of sandy plains (<i>Littorelletalia uniflorae</i>) [3110], Siliceous rocky slopes with chasmophytic vegetation [8220], Alpine and Boreal heaths [4060], Calcareous rocky slopes with chasmophytic vegetation [8210], Calaminarian grasslands of the <i>Violetalia calaminariae</i> [6130]	A05.02, C01.03, K04.05, F03, G01.04, G01, I01, G02.09, G01.02, A04, G01.03.02, K01.01, B06, G05.04, D01.01, F04.02, E01, B02.05, G05.07, G05.01, G04.01, G05.09, F03.02.02, G05.06, J01.01, L05, E03.01	Stock feeding, Peat extraction, Damage by herbivores (including game species), Hunting and collection of wild animals (terrestrial), Mountaineering, rock climbing, speleology, Outdoor sports and leisure activities, recreational activities, Invasive non-native species, Wildlife watching, Walking, horseriding and non-motorised vehicles, Grazing, Off-road motorized driving, Erosion, Grazing in forests or woodland, Vandalism, Paths, tracks, cycling tracks, Collection (fungi, lichen, berries etc.), Urbanised areas, human habitation, Non-intensive timber production (leaving dead wood or old trees untouched), Missing or wrongly directed conservation measures, Trampling, overuse, Military manoeuvres, Fences, fencing, Taking from nest (e.g. falcons), Tree surgery, felling for public safety, removal of roadside trees, Burning down, Collapse of terrain, landslide, Disposal of household or recreational facility waste

Site Code	Site Name	Qualifying Feature	Pressures Codes	Known Threats and Pressures
003000	Rockabill to Dalkey Island SAC	Reefs [1170], Harbour porpoise (<i>Phocoena phocoena</i>) [1351]	J02.11, J02.02, D02, E03, F02.02, X, D03.02, H06.01	Siltation rate changes, dumping, depositing of dredged deposits, Removal of sediments (mud...), Utility and service lines, Discharges, Professional active fishing, No threats or pressures, Shipping lanes, Noise nuisance, noise pollution
004006	North Bull Island SPA	Black-tailed Godwit (<i>Limosa limosa</i>) [A156], Grey Plover (<i>Pluvialis squatarola</i>) [A141], Wetland and Waterbirds [A999], Turnstone (<i>Arenaria interpres</i>) [A169], Pintail (<i>Anas acuta</i>) [A054], Oystercatcher (<i>Haematopus ostralegus</i>) [A130], Light-bellied Brent Goose (<i>Branta bernicla hrota</i>) [A046], Knot (<i>Calidris canutus</i>) [A143], Bar-tailed Godwit (<i>Limosa lapponica</i>) [A157], Sanderling (<i>Calidris alba</i>) [A144], Shelduck (<i>Tadorna tadorna</i>) [A048], Teal (<i>Anas crecca</i>) [A052], Black-headed Gull (<i>Chroicocephalus ridibundus</i>) [A179], Redshank (<i>Tringa totanus</i>) [A162], Curlew (<i>Numenius arquata</i>) [A160], Golden Plover (<i>Pluvialis apricaria</i>) [A140], Dunlin (<i>Calidris alpina</i>) [A149], Shoveler (<i>Anas clypeata</i>) [A056]	D01.02, E01.04, E02, G02.01, D01.05, G03, G01.01, E01.01, G01.02, D03.02, E03, F02.03.01	Roads, motorways, Other patterns of habitation, Industrial or commercial areas, Golf course, Bridge, viaduct, Interpretative centres, Nautical sports, Continuous urbanisation, Walking, horseriding and non-motorised vehicles, Shipping lanes, Discharges, Bait digging or collection
004024	South Dublin Bay and Tolka Estuary SPA	Oystercatcher (<i>Haematopus ostralegus</i>) [A130], Ringed Plover (<i>Charadrius hiaticula</i>) [A137], Dunlin (<i>Calidris alpina</i>) [A149], Wetland and Waterbirds [A999], Light-bellied Brent Goose (<i>Branta bernicla hrota</i>) [A046], Knot (<i>Calidris canutus</i>) [A143], Black-headed Gull (<i>Chroicocephalus ridibundus</i>) [A179], Common tern (<i>Sterna hirundo</i>) [A193], Arctic tern (<i>Sterna paradisaea</i>) [A194], Redshank (<i>Tringa totanus</i>) [A162], Sanderling (<i>Calidris alba</i>) [A144], Grey Plover (<i>Pluvialis squatarola</i>) [A141], Roseate Tern (<i>Sterna dougallii</i>) [A192], Bar-tailed Godwit (<i>Limosa lapponica</i>) [A157]	E01, F02.03, G01.02, J02.01.02, F02.03.01, G01.01, D01.02, E02, E03, K02.03	Urbanised areas, human habitation, Leisure fishing, Walking, horseriding and non-motorised vehicles, Reclamation of land from sea, estuary or marsh, Bait digging or collection, Nautical sports, Roads, motorways, Industrial or commercial areas, Discharges, Eutrophication (natural)
004040	Wicklow Mountains SPA	Merlin (<i>Falco columbarius</i>) [A098], Peregrine falcon (<i>Falco peregrinus</i>) [A103]	G01.02, C01.03, A04, B, G03, D01.01	Walking, horseriding and non-motorised vehicles, Peat extraction, Grazing, Sylviculture, forestry, Interpretative centres, Paths, tracks, cycling tracks

Site Code	Site Name	Qualifying Feature	Pressures Codes	Known Threats and Pressures
004236	North-west Irish Sea SPA	Red-throated Diver (<i>Gavia stellata</i>) [A001], Great Northern Diver (<i>Gavia immer</i>) [A003], Fulmar (<i>Fulmarus glacialis</i>) [A009], Manx Shearwater (<i>Puffinus puffinus</i>) [A013], Cormorant (<i>Phalacrocorax carbo</i>) [A017], Shag, (<i>Phalacrocorax aristotelis</i>) [A018], Common Scoter (<i>Melanitta nigra</i>) [A065], Black-headed Gull (<i>Chroicocephalus ridibundus</i>) [A179], Common Gull (<i>Larus canus</i>) [A182], Lesser Black-backed Gull (<i>Larus fuscus</i>) [A183], Herring Gull (<i>Larus argentatus</i>) [A184], Great Black-backed Gull (<i>Larus marinus</i>) [A187], Kittiwake (<i>Rissa tridactyla</i>) [A188], Roseate Tern (<i>Sterna dougallii</i>) [A192], Common Tern (<i>Sterna hirundo</i>) [A193], Arctic Tern (<i>Sterna paradisaea</i>) [A194], Guillemot (<i>Uria aalge</i>) [A199], Razorbill (<i>Alca torda</i>) [A200], Puffin (<i>Fratercula arctica</i>) [A204], Little Gull (<i>Hydrocoloeus minutus</i>) [A862], Little Tern (<i>Sternula albifrons</i>) [A885]	Natura 2000 Form not available.	Natura 2000 Form not available.
004113	Howth Head Coast SPA	Kittiwake (<i>Rissa tridactyla</i>) [A188]	J01, G01.02	Fire and fire suppression, Walking, horseriding and non-motorised vehicles
004172	Dalkey Islands SPA	Arctic tern (<i>Sterna paradisaea</i>) [A194], Common tern (<i>Sterna hirundo</i>) [A193], Roseate tern (<i>Sterna dougallii</i>) [A192]	G01.02, A04, G01.01, E01	Walking, horseriding and non-motorised vehicles, Grazing, Nautical sports, Urbanised areas, human habitation



DESIGNING AND DELIVERING
A SUSTAINABLE FUTURE

APPENDIX 2

Further Information on the
Qualifying Interests of SACs
That Have Undergone
Assessment

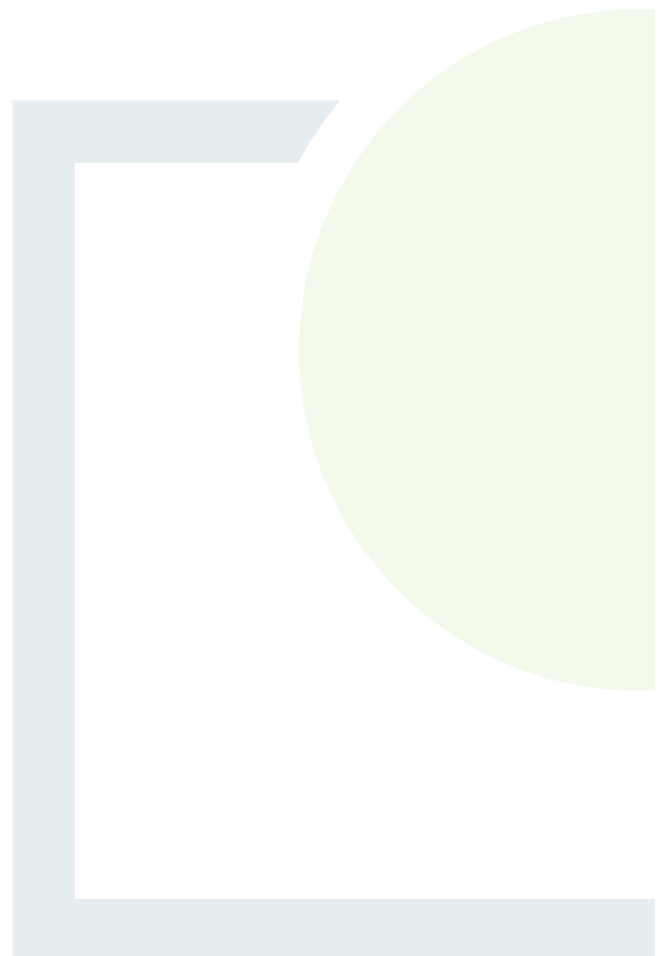

Qualifying Interests of SACs That Have Undergone Assessment Including Summaries of Current Threats and Sensitivities

EU Code	Qualifying Interests	Article 17 Report Summary - Threats and Pressures	Threats and Pressures Codes	Known Threats and Pressures	Sensitivity of Qualifying Interests
[1140]	Mudflats and sandflats not covered by seawater at low tide	Pressures on mudflats and sandflats are partly caused by pollution from agricultural, forestry and wastewater sources, as well as impacts associated with marine aquaculture, particularly the Pacific oyster (<i>Magallana gigas</i>).	A28, F20, G16	Agricultural activities generating marine pollution, Residential or recreational activities and structures generating marine pollution (excl. marine macro- and micro- particular pollution, Marine aquaculture generating marine pollution	Surface and marine water dependent. Moderately sensitive to hydrological change. Moderate sensitivity to pollution. Changes to salinity and tidal regime. Coastal development.
[1170]	Reefs	The main pressures on reefs come from fishing methods that damage the seafloor.	G01, G03	Marine fishing and shellfish harvesting (professional, recreational) causing reduction of species/prey populations and disturbance of species, Marine fish and shellfish harvesting (professional, recreational) activities causing physical loss and disturbance of seafloor habitats	Sensitive to disturbance and pollution.
[1210]	Annual vegetation of drift lines	Most of the pressures on drift lines are associated with activities such as recreation and coastal defences, which can interfere with sediment dynamics.	C01, F01, F06, F07, F08	Extraction of minerals (e.g. rock, metal ores, gravel, sand, shell), Conversion from other land uses to housing, settlement or recreational areas (excluding drainage and modification of coastline, estuary and coastal conditions), Development and maintenance of beach areas for tourism and recreation incl. beach nourishment and beach cleaning, Sports, tourism and leisure activities, Modification of coastline, estuary and coastal conditions for development, use and protection of residential, commercial, industrial and recreational infrastructure and areas (including sea defence or coast protection works and infrastructures)	Overgrazing and erosion. Changes in management.

EU Code	Qualifying Interests	Article 17 Report Summary - Threats and Pressures	Threats and Pressures Codes	Known Threats and Pressures	Sensitivity of Qualifying Interests
[1230]	Vegetated sea cliffs of the Atlantic and Baltic coasts	A number of significant pressures were identified, including trampling by walkers, invasive non-native species, gravel extraction, and sea-level and wave exposure changes due to climate change.	C01, E01, F07, F08, I02, N03, N04	Extraction of minerals (e.g. rock, metal ores, gravel, sand, shell), Roads, paths, railroads and related infrastructure (e.g. bridges, viaducts, tunnels), Sports, tourism and leisure activities, Modification of coastline, estuary and coastal conditions for development, use and protection of residential, commercial, industrial and recreational infrastructure and areas (including sea defence or coast protection works and infrastructures), Other invasive alien species (other than species of Union concern), Increases or changes in precipitation due to climate change, Sea-level and wave exposure changes due to climate change	Land use activities such as tourism and/or agricultural practices. Direct alteration to the habitat or effects such as burning or drainage.
[1310]	Salicornia and other annuals colonising mud and sand	Pressures on salicornia mud are caused by alien species and overgrazing by livestock	A09, I02	Intensive grazing or overgrazing by livestock, Other invasive alien species (other than species of Union concern)	Marine water dependent. Medium sensitivity to hydrological change. Changes in salinity and tidal regime. Infilling, reclamation, invasive species.

EU Code	Qualifying Interests	Article 17 Report Summary - Threats and Pressures	Threats and Pressures Codes	Known Threats and Pressures	Sensitivity of Qualifying Interests
[1330]	Atlantic salt meadows (Glauco-Puccinellietalia maritimae)	The main pressures on Atlantic salt meadows are from agriculture, including ecologically unstable grazing regimes and land reclamation, and the invasive non-native species common cord-grass (<i>Spartina anglica</i>).	A09, A33, A36, F07, F08, I02	Intensive grazing or overgrazing by livestock, Modification of hydrological flow or physical alternation of water bodies for agriculture (excluding development and operation of dams), Agriculture activities not referred to above, Sports, tourism and leisure activities, Modification of coastline, estuary and coastal conditions for development, use and protection of residential, commercial, industrial and recreational infrastructure and areas (including sea defence or coast protection works and infrastructures), Other invasive alien species (other than species of Union concern)	Marine and groundwater dependent. Medium sensitivity to hydrological change. Changes in salinity and tidal regime. Overgrazing, erosion and accretion.
[1351]	Harbour Porpoise (<i>Phocoena phocoena</i>)	Pressures acting on this species in Irish waters mainly involve commercial vessel-based activities such as impacts arising from geophysical seismic exploration or from local/regional prey removal by fisheries.	C09, G01	Geotechnical surveying, Marine fishing and shellfish harvesting (professional, recreational) causing reduction of species/prey populations and disturbance of species	Sensitive to disturbance, prey availability and pollution.
[1355]	Otter (<i>Lutra lutra</i>)	There are no pressures facing this species	Xxp, Xxt	No pressures, No threats	Surface and marine water dependent. Moderately sensitive to hydrological change. Sensitivity to pollution.
[1395]	Petalwort (<i>Petalophyllum ralfsii</i>)	There are no pressures facing this species.	Xxp, Xxt	No pressures, No threats	None identified.

EU Code	Qualifying Interests	Article 17 Report Summary - Threats and Pressures	Threats and Pressures Codes	Known Threats and Pressures	Sensitivity of Qualifying Interests
[1410]	Mediterranean salt meadows (Juncetalia maritimi)	Most of the pressures on Mediterranean salt meadows are associated with agriculture, including overgrazing, undergrazing and land reclamation.	A09, A10, A33, A36	Intensive grazing or overgrazing by livestock, Extensive grazing or undergrazing by livestock, Modification of hydrological flow or physical alternation of water bodies for agriculture (excluding development and operation of dams), Agriculture activities not referred to above	Marine and groundwater dependent. Medium sensitivity to hydrological change. Changes in salinity and tidal regime. Coastal development and reclamation.

EU Code	Qualifying Interests	Article 17 Report Summary - Threats and Pressures	Threats and Pressures Codes	Known Threats and Pressures	Sensitivity of Qualifying Interests
[2110]	Embryonic shifting dunes	The majority of pressures on this habitat are associated with recreation and coastal defences, which can interfere with sediment dynamics.	C01, E03, F01, F06, F07, F08, L01, L02	Extraction of minerals (e.g. rock, metal ores, gravel, sand, shell), Shipping lanes, ferry lanes and anchorage infrastructure (e.g. canalisation, dredging), Conversion from other land uses to housing, settlement or recreational areas (excluding drainage and modification of coastline, estuary and coastal conditions), Development and maintenance of beach areas for tourism and recreation incl. beach nourishment and beach cleaning, Sports, tourism and leisure activities, Modification of coastline, estuary and coastal conditions for development, use and protection of residential, commercial, industrial and recreational infrastructure and areas (including sea defence or coast protection works and infrastructures), Abiotic natural processes (e.g. erosion, silting up, drying out, submersion, salinization), Natural succession resulting in species composition change (other than by direct changes of agricultural or forestry practices)	Overgrazing, and erosion. Changes in management.

EU Code	Qualifying Interests	Article 17 Report Summary - Threats and Pressures	Threats and Pressures Codes	Known Threats and Pressures	Sensitivity of Qualifying Interests
[2120]	Shifting dunes along the shoreline with white dunes (Ammophila arenaria)	Most of the pressures on marram dunes are caused by the interference on sediment dynamics due to recreation and coastal defences.	E01, E03, F01, F06, F07, F08, I02, L01	Roads, paths, railroads and related infrastructure (e.g. bridges, viaducts, tunnels), Shipping lanes, ferry lanes and anchorage infrastructure (e.g. canalisation, dredging), Conversion from other land uses to housing, settlement or recreational areas (excluding drainage and modification of coastline, estuary and coastal conditions), Development and maintenance of beach areas for tourism and recreation incl. beach nourishment and beach cleaning, Sports, tourism and leisure activities, Modification of coastline, estuary and coastal conditions for development, use and protection of residential, commercial, industrial and recreational infrastructure and areas (including sea defence or coast protection works and infrastructures), Other invasive alien species (other than species of Union concern), Abiotic natural processes (e.g. erosion, silting up, drying out, submersion, salinization)	Overgrazing, and erosion. Changes in management.

EU Code	Qualifying Interests	Article 17 Report Summary - Threats and Pressures	Threats and Pressures Codes	Known Threats and Pressures	Sensitivity of Qualifying Interests
[2130]	Fixed coastal dunes with herbaceous vegetation (grey dunes)	Pressures on fixed dunes are associated with recreation and ecologically unsuitable grazing practices.	A02, A09, A10, F07, F08, I02, L02	Conversion from one type of agricultural land use to another (excluding drainage and burning), Intensive grazing or overgrazing by livestock, Extensive grazing or undergrazing by livestock, Sports, tourism and leisure activities, Modification of coastline, estuary and coastal conditions for development, use and protection of residential, commercial, industrial and recreational infrastructure and areas (including sea defence or coast protection works and infrastructures), Other invasive alien species (other than species of Union concern), Natural succession resulting in species composition change (other than by direct changes of agricultural or forestry practices)	Overgrazing, and erosion. Changes in management.
[2190]	Humid dune slacks	Pressures on the habitat come from a number of sources. Including agricultural fertilisers, sports and leisure activities (e.g. walking, off-road driving and golf courses) and drainage. Succession to scrub is also a problem, particularly where it is linked to desiccation of the slack.	A19, A31, F07, I02, L02	Application of natural fertilisers on agricultural land, Drainage for use as agricultural land, Sports, tourism and leisure activities, Other invasive alien species (other than species of Union concern), Natural succession resulting in species composition change (other than by direct changes of agricultural or forestry practices)	Overgrazing, and erosion. Changes in management. Sensitive to hydrological change.

EU Code	Qualifying Interests	Article 17 Report Summary - Threats and Pressures	Threats and Pressures Codes	Known Threats and Pressures	Sensitivity of Qualifying Interests
[3110]	Oligotrophic waters containing very few minerals of sandy plains (Littorelletalia uniflorae)	This habitat is under significant pressure from eutrophication, and from drainage and other damage to peatland. Damage to peatland can result in hydrological changes in lakes, increased organic matter, water colour and turbidity, changes in sediment characteristics, acidification and enrichment.	A26, A31, B23, B27, C05, F12	Agricultural activities generating diffuse pollution to surface or ground waters, Drainage for use as agricultural land, Forestry activities generating pollution to surface or ground waters, Modification of hydrological conditions, or physical alteration of water bodies and drainage for forestry (including dams), Peat extraction, Discharge of urban waste water (excluding storm overflows and/or urban run-offs) generating pollution to surface or ground water	Surface and groundwater dependant. Highly sensitive to hydrological changes. Highly sensitive to pollution.
[3160]	Natural dystrophic lakes and ponds	The pressures on this habitat are associated with pollution from agricultural and forestry activities and also from drainage.	A26, A31, B23, B27, C05, D08	Agricultural activities generating diffuse pollution to surface or ground waters, Drainage for use as agricultural land, Forestry activities generating pollution to surface or ground waters, Modification of hydrological conditions, or physical alteration of water bodies and drainage for forestry (including dams), Peat extraction, Energy production and transmission activities generating pollution to surface or ground waters	Surface and groundwater dependant. Highly sensitive to hydrological changes. Highly sensitive to pollution

EU Code	Qualifying Interests	Article 17 Report Summary - Threats and Pressures	Threats and Pressures Codes	Known Threats and Pressures	Sensitivity of Qualifying Interests
[4010]	Northern Atlantic wet heaths with Erica tetralix	Overgrazing, burning, wind farm development and erosion are the main pressures associated with this habitat, along with nitrogen deposition from agricultural activities that generate air pollution.	A09, A11, A27, B01, D01, L01, N01, N02	Intensive grazing or overgrazing by livestock, Burning for agriculture, Agricultural activities generating air pollution, Conversion to forest from other land uses, or afforestation (excluding drainage), Wind, wave and tidal power, including infrastructure, Abiotic natural processes (e.g. erosion, silting up, drying out, submersion, salinization), Temperature changes (e.g. rise of temperature & extremes) due to climate change	Surface and groundwater dependent. Highly sensitive to hydrological changes. Inappropriate management.
[4030]	European dry heaths	A number of significant pressures were recorded for this habitat in the current reporting period, particularly overgrazing by sheep and burning for agriculture with afforestation and wind farms also being recognised as pressures.	A09, A11, B01, D01, N01, N02	Intensive grazing or overgrazing by livestock, burning for agriculture, Conversion to forest from other land uses, or afforestation (excluding drainage), Wind, wave and tidal power, including infrastructure, Temperature changes (e.g. rise of temperature & extremes) due to climate change	Moderately sensitive to hydrological change. Changes in management. Changes in nutrient status.
[4060]	Alpine and Boreal heaths	Overgrazing by livestock, tourism (hill walking) and agricultural activities that cause air pollution are considered significant pressures for this habitat.	A09, A27, F07, N01, N02	Intensive grazing or overgrazing by livestock, Agricultural activities generating air pollution, Sports, tourism and leisure activities, Temperature changes (e.g. rise of temperature & extremes) due to climate change	Changes in management. Changes in nutrient or base status. Moderately sensitive to hydrological change.

EU Code	Qualifying Interests	Article 17 Report Summary - Threats and Pressures	Threats and Pressures Codes	Known Threats and Pressures	Sensitivity of Qualifying Interests
[6130]	Calaminarian grasslands of the Murawy galmanowa (Violetalia calaminariae)	Pressures on this habitat are associated with abiotic natural processes (leaching of metals) and succession, as well as impacts from recreational activities (walking/hiking).	F07, L01, L02	Sports, tourism and leisure activities, Abiotic natural processes (e.g. erosion, silting up, drying out, submersion, salinization), Natural succession resulting in species composition change (other than by direct changes of agricultural or forestry practices)	Changes in management such as grazing regime. Changes in nutrient or base status. Changes to vegetation composition. Introduction of alien species.
[6210]	Semi-natural dry grasslands and scrubland facies on calcareous substrates (Festuco-Brometalia)* important orchid sites	The significant pressures related to this habitat are mainly associated with agricultural intensification causing loss of species-rich communities, or abandonment of farmland resulting in succession to scrub.	A02, A09, A10, C01, I02, I04	Conversion from one type of agricultural land use to another (excluding drainage and burning), Intensive grazing or overgrazing by livestock, Extensive grazing or undergrazing by livestock, Extraction of minerals (e.g. rock, metal ores, gravel, sand, shell), Other invasive alien species (other than species of Union concern), Problematic native species	Changes in management such as grazing regime. Changes in nutrient or base status. Changes to vegetation composition. Introduction of alien species.
[6230]	Species-rich Nardus grasslands, on siliceous substrates in mountain areas (and submountain areas, in Continental Europe)	The main pressures on this habitat are due to bracken encroachment and succession.	I04, L02	Problematic native species, Natural succession resulting in species composition change (other than by direct changes of agricultural or forestry practices)	Changes in management such as grazing regime. Changes in nutrient or base status. Changes to vegetation composition. Introduction of alien species.

EU Code	Qualifying Interests	Article 17 Report Summary - Threats and Pressures	Threats and Pressures Codes	Known Threats and Pressures	Sensitivity of Qualifying Interests
[6410]	Molinia meadows on calcareous, peaty or clayey-silt-laden soils (Molinion caeruleae)	The main pressures on the habitat are associated with agricultural intensification (e.g. land drainage, fertiliser application), undergrazing and forestry.	A02, A06, A10, A14, A31, B01	Conversion from one type of agricultural land use to another (excluding drainage and burning), Abandonment of grassland management (e.g. cessation of grazing or of mowing), Extensive grazing or undergrazing by livestock, Livestock farming (without grazing), Drainage for use as agricultural land, Conversion to forest from other land uses, or afforestation (excluding drainage)	Changes in management such as grazing regime. Changes in nutrient or base status. Changes to vegetation composition. Introduction of alien species.
[7130]	Blanket bogs (* if active bog)	The main pressures on blanket bogs are overgrazing, burning, afforestation, peat extraction, and agricultural activities causing nitrogen deposition. Erosion, drainage and wind farm construction are also pressures relating to this habitat.	A09, A11, A27, B01, C05, D01, K02, L01, N01, N02	Intensive grazing or overgrazing by livestock, Burning for agriculture, Agricultural activities generating air pollution, Conversion to forest from other land uses, or afforestation (excluding drainage), Peat extraction, Wind, wave and tidal power, including infrastructure, Drainage, Abiotic natural processes (e.g. erosion, silting up, drying out, submersion, salinization), Temperature changes (e.g. rise of temperature & extremes) due to climate change	Surface water interactions. Drainage and land use management are the key things.

EU Code	Qualifying Interests	Article 17 Report Summary - Threats and Pressures	Threats and Pressures Codes	Known Threats and Pressures	Sensitivity of Qualifying Interests
[7220]	Petrifying springs with tufa formation (Cratoneurion)	Pressures related to this habitat are associated with drainage, pollution to ground and surface waters, recreational activities, infrastructure, overgrazing and abandonment of grassland management.	A06, A10, E01, F07, H08, J01, K02, K04, L02	Abandonment of grassland management (e.g. cessation of grazing or of mowing), Extensive grazing or undergrazing by livestock, Roads, paths, railroads and related infrastructure (e.g. bridges, viaducts, tunnels), Sports, tourism and leisure activities, Other human intrusions and disturbance not mentioned above (Dumping, accidental and deliberate disturbance of bat roosts (e.g. caving)), Mixed source pollution to surface and ground waters (limnic and terrestrial), Drainage, Modification of hydrological flow, Natural succession resulting in species composition change (other than by direct changes of agricultural or forestry practices)	Surface and groundwater dependant. Highly sensitive to hydrological changes. Highly sensitive to pollution.

EU Code	Qualifying Interests	Article 17 Report Summary - Threats and Pressures	Threats and Pressures Codes	Known Threats and Pressures	Sensitivity of Qualifying Interests
[7230]	Alkaline fens	The main pressures facing this habitat are land abandonment (and associated succession), overgrazing, drainage and pollution.	A06, A09, A26, J01, K01, K02, K04, L02, N02, N03	Abandonment of grassland management (e.g. cessation of grazing or of mowing), Intensive grazing or overgrazing by livestock, Agricultural activities generating diffuse pollution to surface or ground waters, Mixed source pollution to surface and ground waters (limnic and terrestrial), Abstraction from groundwater, surface water or mixed water, Drainage, Modification of hydrological flow, Natural succession resulting in species composition change (other than by direct changes of agricultural or forestry practices), Temperature changes (e.g. rise of temperature & extremes) due to climate change, Increases or changes in precipitation due to climate change	Surface and groundwater dependent. Highly sensitive to hydrological changes. Inappropriate management.
[8110]	Siliceous scree of the montane to snow levels (<i>Androsacetalia alpinae</i> and <i>Galeopsietalia ladani</i>)	The main pressures on siliceous scree come from overgrazing, undergrazing and succession.	A09, A10, L02	Intensive grazing or overgrazing by livestock, Extensive grazing or undergrazing by livestock, Natural succession resulting in species composition change (other than by direct changes of agricultural or forestry practices)	Erosion, overgrazing and recreation.
[8210]	Calcareous rocky slopes with chasmophytic vegetation	The majority of pressures related to this habitat are associated with overgrazing and the non-native invasive species New Zealand willowherb (<i>Epilobium brunnescens</i>).	A09, A27, I02	Intensive grazing or overgrazing by livestock, Agricultural activities generating air pollution, Other invasive alien species (other than species of Union concern)	Erosion, overgrazing and recreation.

EU Code	Qualifying Interests	Article 17 Report Summary - Threats and Pressures	Threats and Pressures Codes	Known Threats and Pressures	Sensitivity of Qualifying Interests
[8220]	Siliceous rocky slopes with chasmophytic vegetation	Pressure on this habitat is associated with the non-native invasive species New Zealand willowherb (<i>Epilobium brunnescens</i>).	I02	Other invasive alien species (other than species of Union concern)	Erosion, overgrazing and recreation.
[91A0]	Old sessile oak woods with <i>Ilex</i> and <i>Blechnum</i> in the British Isles	The significant pressure facing this habitat are associated with invasive non-native species such as <i>Rhododendron ponticum</i> , cherry laurel (<i>Prunus laurocerasus</i>) and beech (<i>Fagus sylvatica</i>) and overgrazing by deer.	A09, B09, I02, I04, M07	Intensive grazing or overgrazing by livestock, Clear-cutting, removal of all trees, Other invasive alien species (other than species of Union concern), Problematic native species, Storm, cyclone	Changes in management. Changes in nutrient or base status. Introduction of alien species.



**FEILY
TIMONEY**

**DESIGNING AND DELIVERING
A SUSTAINABLE FUTURE**

APPENDIX 3

Further Information on the
Special Conservation Interests
of North West Irish Sea SPAs
That Have Undergone
Assessment

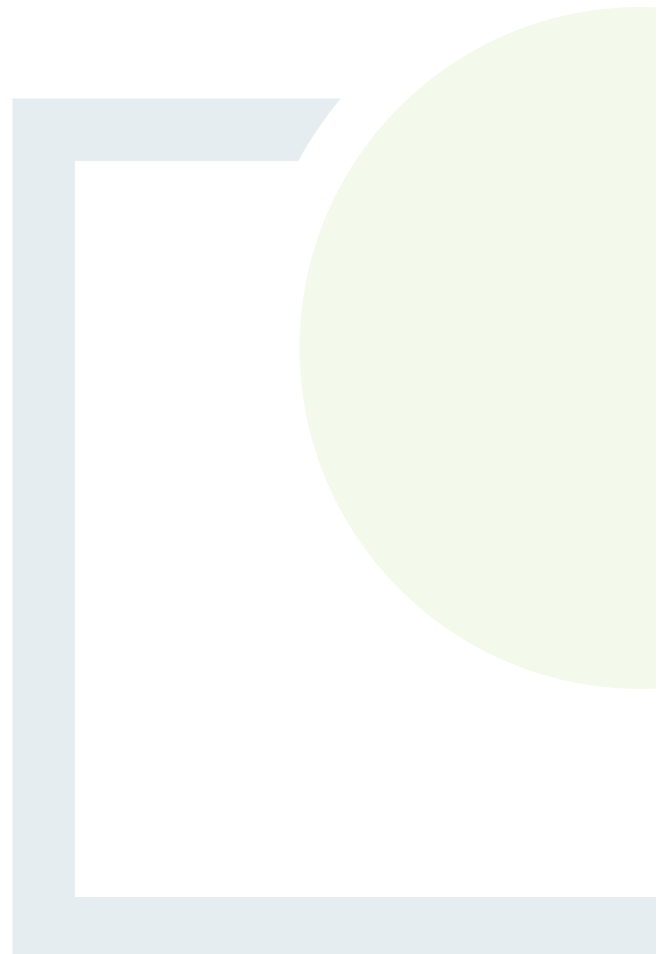

Special Conservation Interests and Vulnerabilities of SPAs That Have Undergone Assessment

Species Code	Common Name	Scientific Name	Threats and Pressures Codes	Known Threats and Pressures
A048	Common Shelduck	Tadorna tadorna	F01, F02, G01, H03, M01	Marine and Freshwater Aquaculture, Fishing and harvesting aquatic resources, Outdoor sports and leisure activities, recreational activities, Marine water pollution, Changes in abiotic conditions
A054	Northern Pintail	Anas acuta	C03, F01, F03, G01, H01, H03, H07, J02	Renewable abiotic energy use, Marine and Freshwater Aquaculture, Hunting and collection of wild animals (terrestrial), Outdoor sports and leisure activities, recreational activities, Pollution to surface waters (limnic & terrestrial, marine & brackish), Marine water pollution, Other forms of pollution, Human induced changes in hydraulic conditions
A056	Northern Shoveler	Anas clypeata	C03, F03, G01, H01, H03, H07	Renewable abiotic energy use, Hunting and collection of wild animals (terrestrial), Outdoor sports and leisure activities, recreational activities, Pollution to surface waters (limnic & terrestrial, marine & brackish), Marine water pollution, Other forms of pollution
A098	Merlin	Falco columbarius	A02, B01, B02, C03, M02	Modification of cultivation practices, Forest planting on open ground, Forest and Plantation management & use, Renewable abiotic energy use, Changes in biotic conditions
A130	Eurasian Oystercatcher	Haematopus ostralegus	C03, F01, F02, G01, H03, J02	Renewable abiotic energy use, Marine and Freshwater Aquaculture, Fishing and harvesting aquatic resources, Outdoor sports and leisure activities, recreational activities, Marine water pollution, Human induced changes in hydraulic conditions
A137	Common Ringed Plover	Charadrius hiaticula	C03, F01, F02, G01, H03, J02, J03, M01	Renewable abiotic energy use, Marine and Freshwater Aquaculture, Fishing and harvesting aquatic resources, Outdoor sports and leisure activities, recreational activities, Marine water pollution, Human induced changes in hydraulic conditions, Other Ecosystem Modifications, Changes in abiotic conditions
A140	European Golden Plover	Pluvialis apricaria	A02, A04, B01, C01, C03, F01, G01, H03, J01, K03, M02	Modification of cultivation practices, Grazing, Forest planting on open ground, Mining and quarrying, Renewable abiotic energy use, Marine and Freshwater Aquaculture, Outdoor sports and leisure activities, recreational activities, Marine water pollution, Fire and Fire suppression, Interspecific faunal relations, Changes in biotic conditions

Species Code	Common Name	Scientific Name	Threats and Pressures Codes	Known Threats and Pressures
A141	Grey Plover	Pluvialis squatarola	C03, F01, F02, G01, H03, J02, J03, M01	Renewable abiotic energy use, Marine and Freshwater Aquaculture, Fishing and harvesting aquatic resources, Outdoor sports and leisure activities, recreational activities, Marine water pollution, Human induced changes in hydraulic conditions, Other Ecosystem Modifications, Changes in abiotic conditions
A143	Red Knot	Calidris canutus	C03, F01, F02, G01, H03, J02, J03, M01	Renewable abiotic energy use, Marine and Freshwater Aquaculture, Fishing and harvesting aquatic resources, Outdoor sports and leisure activities, recreational activities, Marine water pollution, Human induced changes in hydraulic conditions, Other Ecosystem Modifications, Changes in abiotic conditions
A144	Sanderling	Calidris alba	C03, F01, G01, H03, M01	Renewable abiotic energy use, Marine and Freshwater Aquaculture, Outdoor sports and leisure activities, recreational activities, Marine water pollution, Changes in abiotic conditions
A149	Dunlin	Calidris alpina	C03, F01, F02, G01, H03, J02, J03, M01	Renewable abiotic energy use, Marine and Freshwater Aquaculture, Fishing and harvesting aquatic resources, Outdoor sports and leisure activities, recreational activities, Marine water pollution, Human induced changes in hydraulic conditions, Other Ecosystem Modifications, Changes in abiotic conditions
A157	Bar-Tailed Godwit	Limosa lapponica	C03, F01, F02, G01, H03, J02, J03, M01	Renewable abiotic energy use, Marine and Freshwater Aquaculture, Fishing and harvesting aquatic resources, Outdoor sports and leisure activities, recreational activities, Marine water pollution, Human induced changes in hydraulic conditions, Other Ecosystem Modifications, Changes in abiotic conditions
A162	Common Redhank	Tringa totanus	C03, F01, F02, G01, H03, J02, J03, M01	Renewable abiotic energy use, Marine and Freshwater Aquaculture, Fishing and harvesting aquatic resources, Outdoor sports and leisure activities, recreational activities, Marine water pollution, Human induced changes in hydraulic conditions, Other Ecosystem Modifications, Changes in abiotic conditions
A169	Ruddy Turnstone	Arenaria interpres	C03, F01, G01, H03, J03, M01	Renewable abiotic energy use, Marine and Freshwater Aquaculture, Outdoor sports and leisure activities, recreational activities, Marine water pollution, Other Ecosystem Modifications, Changes in abiotic conditions

Species Code	Common Name	Scientific Name	Threats and Pressures Codes	Known Threats and Pressures
A179	Black-Headed Gull	Larus ridibundus	A04, C03, F02, H03, J03, M01	Grazing, Renewable abiotic energy use, Fishing and harvesting aquatic resources, Marine water pollution, Other Ecosystem Modifications, Changes in abiotic conditions
A188	Black-Legged Kittiwake	Rissa tridactyla	C03, F02, H03	Renewable abiotic energy use, Fishing and harvesting aquatic resources, Marine water pollution
A193	Common Tern	Sterna hirundo	C03, D01, D03, G01, I01	Renewable abiotic energy use, Roads, paths and railroads, Shipping lanes, ports, marine constructions, Outdoor sports and leisure activities, recreational activities, Invasive non-native species
A194	Arctic Tern	Sterna paradisaea	C03, D01, G01, I01, M01	Renewable abiotic energy use, Roads, paths and railroads, Outdoor sports and leisure activities, recreational activities, Invasive non-native species, Changes in abiotic conditions



DESIGNING AND DELIVERING
A SUSTAINABLE FUTURE

APPENDIX 4

Conservation Objectives

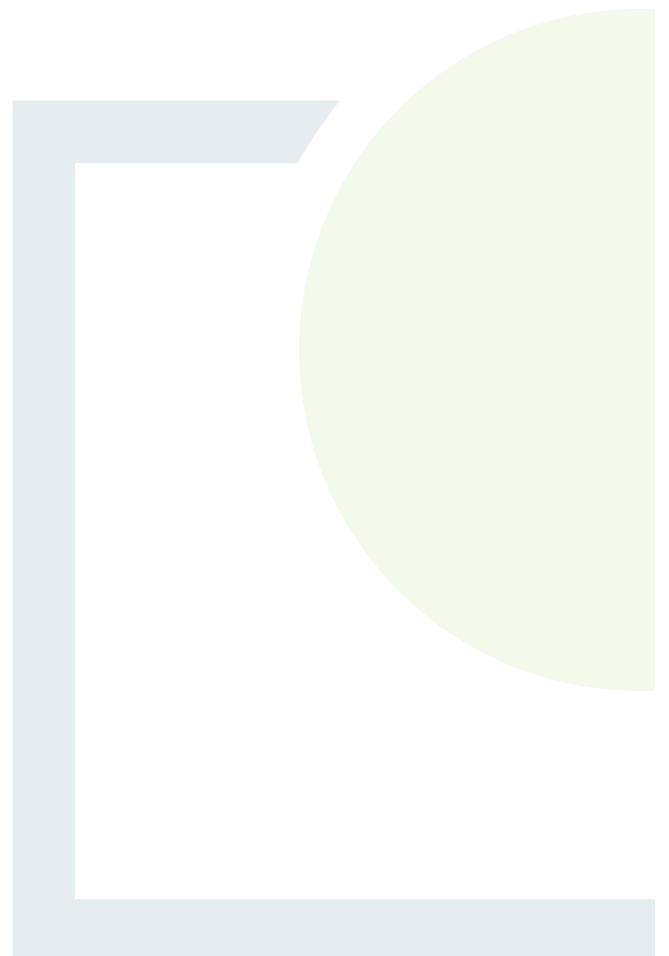

Conservation objectives that have been considered by the assessment are included in the following NPWS/Department of Culture, Heritage and the Gaeltacht documents

- NPWS (2016) Conservation Objectives for Howth Head SAC [IE0000202] Version 1.
- NPWS (2013) Conservation Objectives for North Dublin Bay SAC [IE0000206] Version 1.
- NPWS (2013) Conservation Objectives for South Dublin Bay SAC [IE0000210] Version 1.
- NPWS (2019) Conservation Objectives for Ballyman Glen SAC [IE0000713] Version 1.
- NPWS (2017) Conservation Objectives for Bray Head SAC [IE0000714] Version 1.
- NPWS (2021) Conservation Objectives for Knocksink Wood SAC [IE0000725] Version 1.
- NPWS (2021) Conservation Objectives for Glenasmole Valley SAC [IE0001209] Version 1.
- NPWS (2017) Conservation Objectives for Wicklow Mountains SAC [IE0002122] Version 1.
- NPWS (2013) Conservation Objectives for Rockabill to Dalkey Island SAC [IE0003000] Version 1.
- NPWS (2015) Conservation Objectives for North Bull Island SPA [IE0004006] Version 1.
- NPWS (2015) Conservation Objectives for South Dublin Bay and River Tolka Estuary SPA [IE0004024] Version 1.
- NPWS (2023) Conservation Objectives for North-west Irish Sea SPA [IE0004236] Version 1.
- NPWS (2024) Generic Conservation Objectives for Wicklow Mountains SPA [IE0004040] Version 1.
- NPWS (2024) Generic Conservation Objectives for Howth Head Coast SPA [IE0004113] Version 1.
- NPWS (2024) Generic Conservation Objectives for Dalkey Islands SPA [IE0004172] Version 1.



**FEHILY
TIMONEY**

**DESIGNING AND DELIVERING
A SUSTAINABLE FUTURE**

APPENDIX 5

Projects considered for in-
combinations effects

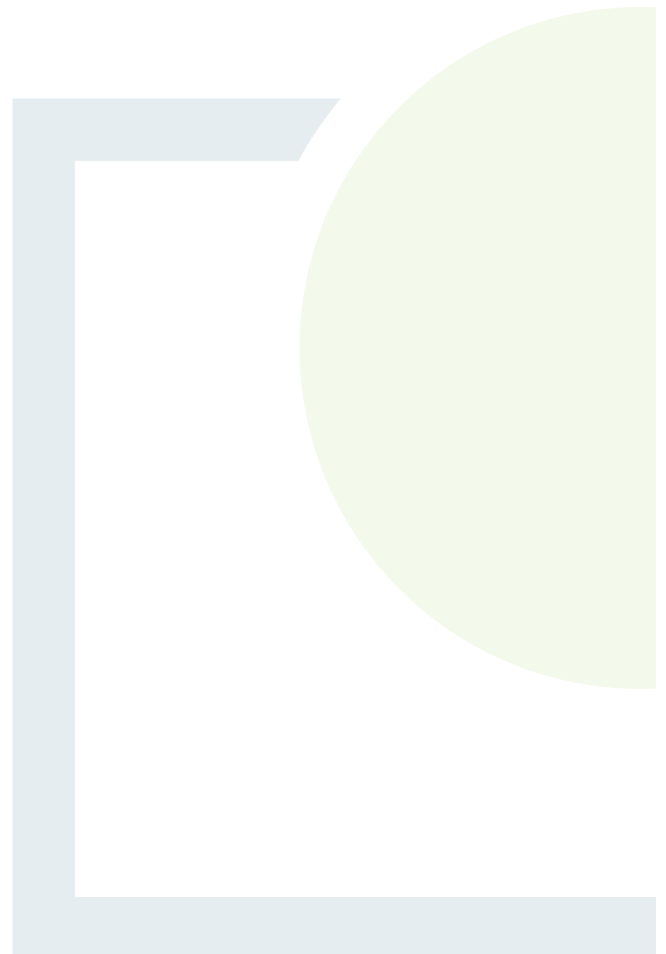

In-Combination Assessment		
Planning Reference	Planning Status	In-Combination Assessment
Dún Laoghaire–Rathdown County Council - Planning History Review		
DZ22A/0093	GRANT PERMISSION FOR RETENTION	The proposed development does not have the potential to result in likely, significant effects on the integrity of European sites, in-combination with this development.
DZ22A/0133	GRANT PERMISSION	The proposed development does not have the potential to result in likely, significant effects on the integrity of European sites, in-combination with this development.
DZ20A/0946	GRANT PERMISSION	The proposed development does not have the potential to result in likely, significant effects on the integrity of European sites, in-combination with this development.
DZ15A/0813/E	GRANT EXTENSION OF DURATION OF PERM.	The proposed development does not have the potential to result in likely, significant effects on the integrity of European sites, in-combination with this development.
DZ25A/0489/WEB	GRANT PERMISSION FOR RETENTION	The proposed development does not have the potential to result in likely, significant effects on the integrity of European sites, in-combination with this development.
DZ22A/0770	GRANT PERMISSION	The proposed development does not have the potential to result in likely, significant effects on the integrity of European sites, in-combination with this development.

In-Combination Assessment		
Planning Reference	Planning Status	In-Combination Assessment
DZ22A/0623	GRANT PERMISSION	The proposed development does not have the potential to result in likely, significant effects on the integrity of European sites, in-combination with this development.
DZ22A/0820	GRANT PERMISSION	The proposed development does not have the potential to result in likely, significant effects on the integrity of European sites, in-combination with this development.
DZ20A/0552	GRANT PERMISSION	The proposed development does not have the potential to result in likely, significant effects on the integrity of European sites, in-combination with this development.
DZ21A/0699	GRANT PERMISSION	The proposed development does not have the potential to result in likely, significant effects on the integrity of European sites, in-combination with this development.
DZ25A/0161/WEB	GRANT PERMISSION	The proposed development does not have the potential to result in likely, significant effects on the integrity of European sites, in-combination with this development.
DZ24A/1030/WEB	GRANT PERMISSION	The proposed development does not have the potential to result in likely, significant effects on the integrity of European sites, in-combination with this development.
DZ21A/0932	GRANT PERMISSION	The proposed development does not have the potential to result in likely, significant effects on the integrity of European sites, in-combination with this development.
D23B/0194	GRANT PERMISSION	The proposed development does not have the potential to result in likely, significant effects on the integrity of European sites, in-combination with this development.

In-Combination Assessment		
Planning Reference	Planning Status	In-Combination Assessment
DZ24A/0291/WEB	GRANT PERMISSION	The proposed development does not have the potential to result in likely, significant effects on the integrity of European sites, in-combination with this development.
DZ21A/1042	GRANT PERMISSION	The proposed development does not have the potential to result in likely, significant effects on the integrity of European sites, in-combination with this development.
DZ21A/0806	GRANT PERMISSION	The proposed development does not have the potential to result in likely, significant effects on the integrity of European sites, in-combination with this development.
DZ17A/0714/E	GRANT EXTENSION OF DURATION OF PERM.	The proposed development does not have the potential to result in likely, significant effects on the integrity of European sites, in-combination with this development.
DZ24A/0291/WEB	GRANT PERMISSION	The proposed development does not have the potential to result in likely, significant effects on the integrity of European sites, in-combination with this development.
DZ21A/0334	GRANT PERMISSION	The proposed development does not have the potential to result in likely, significant effects on the integrity of European sites, in-combination with this development.
DZ24A/0291/WEB	GRANT PERMISSION	The proposed development does not have the potential to result in likely, significant effects on the integrity of European sites, in-combination with this development.
DZ24A/0696/WEB	GRANT PERMISSION	The proposed development does not have the potential to result in likely, significant effects on the integrity of European sites, in-combination with this development.

In-Combination Assessment		
Planning Reference	Planning Status	In-Combination Assessment
DZ23A/0468	GRANT PERMISSION	The proposed development does not have the potential to result in likely, significant effects on the integrity of European sites, in-combination with this development.
DZ23A/0812	GRANT PERMISSION	The proposed development does not have the potential to result in likely, significant effects on the integrity of European sites, in-combination with this development.
DZ22A/0729	GRANT PERMISSION	The proposed development does not have the potential to result in likely, significant effects on the integrity of European sites, in-combination with this development.
PC/CSDZ/013/22	APPROVE	The proposed development does not have the potential to result in likely, significant effects on the integrity of European sites, in-combination with this development.
DZ21A/0414	GRANT PERMISSION	The proposed development does not have the potential to result in likely, significant effects on the integrity of European sites, in-combination with this development.
PC/CSDZ/005/2021	APPROVE	The proposed development does not have the potential to result in likely, significant effects on the integrity of European sites, in-combination with this development.
DZ23A/0106	GRANT PERMISSION	The proposed development does not have the potential to result in likely, significant effects on the integrity of European sites, in-combination with this development.
DZ25A/0014/WEB	GRANT PERMISSION	The proposed development does not have the potential to result in likely, significant effects on the integrity of European sites, in-combination with this development.

In-Combination Assessment		
Planning Reference	Planning Status	In-Combination Assessment
D23B/0190	GRANT PERMISSION	The proposed development does not have the potential to result in likely, significant effects on the integrity of European sites, in-combination with this development.
D23A/0273	GRANT PERMISSION	The proposed development does not have the potential to result in likely, significant effects on the integrity of European sites, in-combination with this development.
DZ23A/0005	GRANT PERMISSION	The proposed development does not have the potential to result in likely, significant effects on the integrity of European sites, in-combination with this development.
D23A/0174	GRANT PERMISSION & GRANT RETENTION	The proposed development does not have the potential to result in likely, significant effects on the integrity of European sites, in-combination with this development.
DZ23A/0120	DECLARE APPLICATION WITHDRAWN	The proposed development does not have the potential to result in likely, significant effects on the integrity of European sites, in-combination with this development.
REF8125	S5 DEC EXEMPT	The proposed development does not have the potential to result in likely, significant effects on the integrity of European sites, in-combination with this development.
D22B/0418	GRANT PERMISSION FOR RETENTION	The proposed development does not have the potential to result in likely, significant effects on the integrity of European sites, in-combination with this development.
D21B/0501	GRANT PERMISSION	The proposed development does not have the potential to result in likely, significant effects on the integrity of European sites, in-combination with this development.

In-Combination Assessment		
Planning Reference	Planning Status	In-Combination Assessment
D22A/0486	GRANT PERMISSION	The proposed development does not have the potential to result in likely, significant effects on the integrity of European sites, in-combination with this development.
D21A/0955	GRANT PERMISSION	The proposed development does not have the potential to result in likely, significant effects on the integrity of European sites, in-combination with this development.
D20A/0957	GRANT PERMISSION	The proposed development does not have the potential to result in likely, significant effects on the integrity of European sites, in-combination with this development.
D24A/0372/WEB	GRANT PERMISSION	The proposed development does not have the potential to result in likely, significant effects on the integrity of European sites, in-combination with this development.
D24B/0318/WEB	GRANT PERMISSION	The proposed development does not have the potential to result in likely, significant effects on the integrity of European sites, in-combination with this development.
D23A/0318	GRANT PERMISSION	The proposed development does not have the potential to result in likely, significant effects on the integrity of European sites, in-combination with this development.
D24B/0113/WEB	GRANT PERMISSION	The proposed development does not have the potential to result in likely, significant effects on the integrity of European sites, in-combination with this development.
DZ23A/0083	GRANT PERMISSION	The proposed development does not have the potential to result in likely, significant effects on the integrity of European sites, in-combination with this development.

In-Combination Assessment		
Planning Reference	Planning Status	In-Combination Assessment
DZ24A/0621/WEB	GRANT PERMISSION	The proposed development does not have the potential to result in likely, significant effects on the integrity of European sites, in-combination with this development.
DZ25A/0515/WEB	GRANT PERMISSION	The proposed development does not have the potential to result in likely, significant effects on the integrity of European sites, in-combination with this development.
DZ19A/0863/E	GRANT EXTENSION OF DURATION OF PERM.	The proposed development does not have the potential to result in likely, significant effects on the integrity of European sites, in-combination with this development.
D22A/0559	GRANT PERMISSION	The proposed development does not have the potential to result in likely, significant effects on the integrity of European sites, in-combination with this development.
D21A/0550	GRANT PERMISSION	The proposed development does not have the potential to result in likely, significant effects on the integrity of European sites, in-combination with this development.
D24B/0228/WEB	GRANT PERMISSION	The proposed development does not have the potential to result in likely, significant effects on the integrity of European sites, in-combination with this development.
D22A/0463	GRANT PERMISSION	The proposed development does not have the potential to result in likely, significant effects on the integrity of European sites, in-combination with this development.
D24A/0278/WEB	GRANT PERMISSION	The proposed development does not have the potential to result in likely, significant effects on the integrity of European sites, in-combination with this development.

In-Combination Assessment		
Planning Reference	Planning Status	In-Combination Assessment
D22A/0091	GRANT PERMISSION	The proposed development does not have the potential to result in likely, significant effects on the integrity of European sites, in-combination with this development.
DZ25A/0318/WEB	GRANT PERMISSION	The proposed development does not have the potential to result in likely, significant effects on the integrity of European sites, in-combination with this development.
PC/PKS/03/24	APPROVAL FOR THE PROPOSAL TO PROCEED	The proposed development does not have the potential to result in likely, significant effects on the integrity of European sites, in-combination with this development.
D22A/0350	GRANT PERMISSION	The proposed development does not have the potential to result in likely, significant effects on the integrity of European sites, in-combination with this development.
An Coimisiún Pleanála - Planning History Review		
314193	Grant permission with revised conditions	The proposed development does not have the potential to result in likely, significant effects on the integrity of European sites, in-combination with this development.
317574	Approve without Conditions	The proposed development does not have the potential to result in likely, significant effects on the integrity of European sites, in-combination with this Plan amendment.
317698	Grant permission with revised conditions	The proposed development does not have the potential to result in likely, significant effects on the integrity of European sites, in-combination with this development.

In-Combination Assessment		
Planning Reference	Planning Status	In-Combination Assessment
317742	Approve with Conditions	The proposed development does not have the potential to result in likely, significant effects on the integrity of European sites, in-combination with this Plan amendment.
320893	Grant permission with revised conditions	The proposed development does not have the potential to result in likely, significant effects on the integrity of European sites, in-combination with this development.
321401	Case is due to be decided by 14/04/2025	The proposed development does not have the potential to result in likely, significant effects on the integrity of European sites, in-combination with this development.
322666	Case is due to be decided by 02/10/25	The proposed development does not have the potential to result in likely, significant effects on the integrity of European sites, in-combination with this development.
323476	Case is due to be decided by 02/01/2026	The proposed development does not have the potential to result in likely, significant effects on the integrity of European sites, in-combination with this development.



**DESIGNING AND DELIVERING
A SUSTAINABLE FUTURE**

www.fehilytimoney.ie

 **Cork**

 **Dublin**

 **Carlow**

