

Note:  
 -Solar hot water or Photo Voltaics  
 will be provided on appropriate  
 facing roofs to comply with  
 Renewable Energy requirement

- Materials legend
1. Facing brick
  2. Coloured Render
  3. Render
  4. Alu Clad Timber Windows/Doors
  5. Fibre Cement slates
  6. Timber Screen

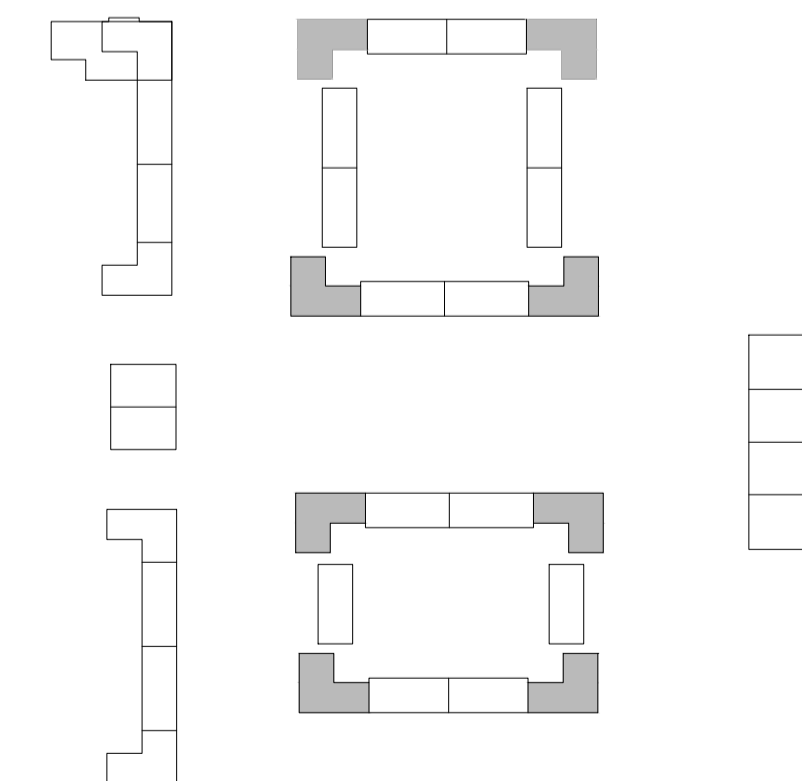
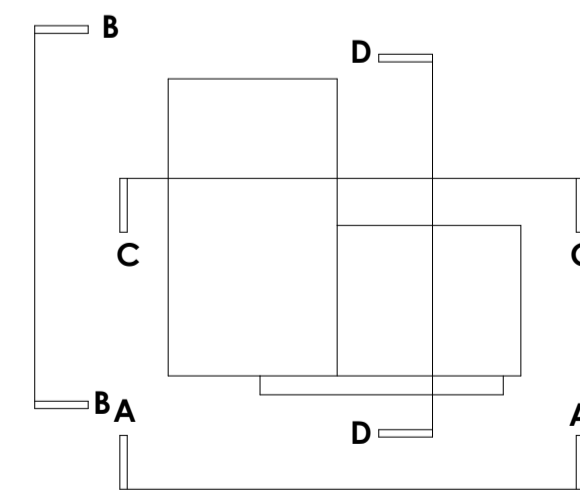

Rev.	Date	Drawn	Description

Do not scale from this Drawing, use figured dimensions only. Check all dimensions on site before commencing work. Report any discrepancies to Architect before proceeding. This Drawing and Designs thereon are copyright of the County Council. ©

© - Ordnance Survey Ireland. All rights reserved.  
 Licence number 2009/25/CCMAJ  
 Dun Laoghaire-Rathdown County Council.



Job  
**Rosemount Court  
 redevelopment**

Drg  
**Type A  
 3 bed 6 person**

Scale -	1:100	Status -	Part VIII
Date -	20150309	CAD Ref -	
Job No -	659	Drawing No -	
Drm. NS		Chd.	659/04
		Rev -	00

Architects Department  
 County Hall, Marine Road, Dun Laoghaire, Co. Dublin.  
 Phone: (01) 204-4700 Fax: (01) 2300291