



① Block P - East Elevation
1 : 200



② Block P - North Elevation
1 : 200



④ Block P - West Elevation
1 : 200



③ Block P - South Elevation
1 : 200

Block P - Elevations

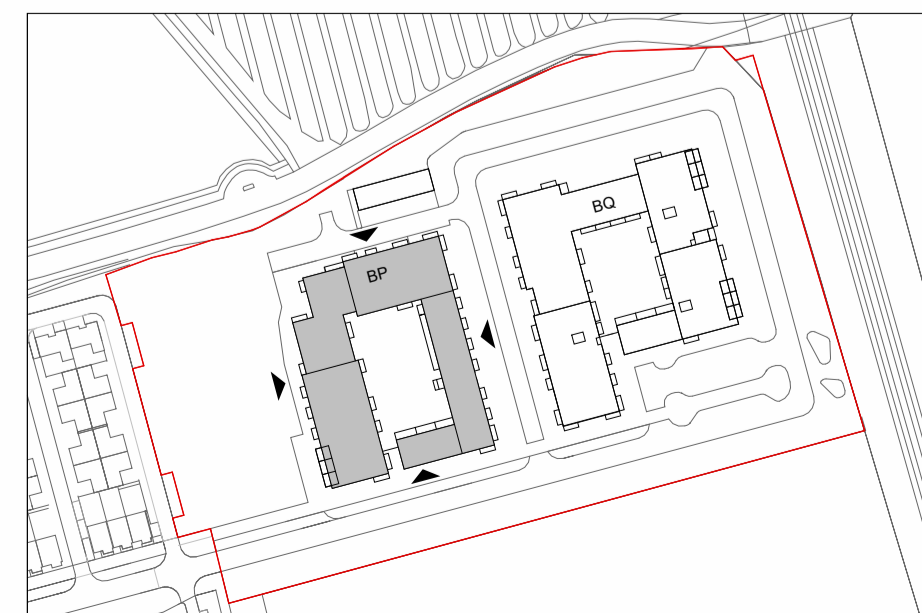

Revision Description	Date	Rev. No.	Issued by
Issued for Information	18-11-2025	P01	MN
Issued for Information	01-12-2025	P02	MN
Issued for Information	09-12-2025	P03	MN
Issued for Information	16-12-2025	P04	MN
Issued for Information	12-01-2026	P05	MN
DLRCC Submission	16-01-2026	C01	MN
Issued for Information	10-02-2026	P06	MN
Issued for Information	25-03-2026	P07	MN
DLRCC Submission	08-05-2026	C02	MN
DLRCC Application	15-06-2026	A3-C01	MN

Any reference to fire safety design or performance is presented for coordination purposes only. Refer only to the granted Fire Safety Certificate, and fire consultant's information for fire safety design, specification and performance.
 Figure dimensions only to be used. This drawing is copyright of O'Mahony Pike Architects Ltd. All information is shared as per approved use in accordance with ISO 19650-2:2018, Table 5; Standard Codes for Suitability of Models and Documents and the BEP. If the 'Status' field is empty, this information has been shared at S0 - WIP.

omahony pike

architecture | urban design | Dublin | Cork
 email: info@omahonypike.com | The Chapel | One South Mall
 tel: +353 1 202 7400 | Mount St. Anne's | Cork City
 fax: +353 1 283 0822 | Milltown, Dublin 6 | Co. Cork
 www.omahonypike.com | D06 XN52 Ireland | T12 CCN3 Ireland

Project: Woodbrook, Dart Gateway
Location: Woodbrook
Client: Aeval Unlimited Company

Project Code: 1618G
Project Lead: SD
Drawn By: MN
Job No.: 1618G
Purpose: For Planning

Scale @ A1: 1 : 200
Date: 15-06-2026
Revision: A3-C01
Status: A3

Drawing Title: Block P - Elevations
Drawing No.: 1618G-OMP-BP-ZZ-DR-A-2001

Source File: Autodesk Docs/1618G-Woodbrook Dart Gateway/1618G-OMP-BP-ZZ-M3-A-0002.rvt