



1 Block Q - East Elevation  
1 : 200



2 Block Q - North Elevation  
1 : 200



3 Block Q - South Elevation  
1 : 200



4 Block Q - West Elevation  
1 : 200

Block Q - Elevations

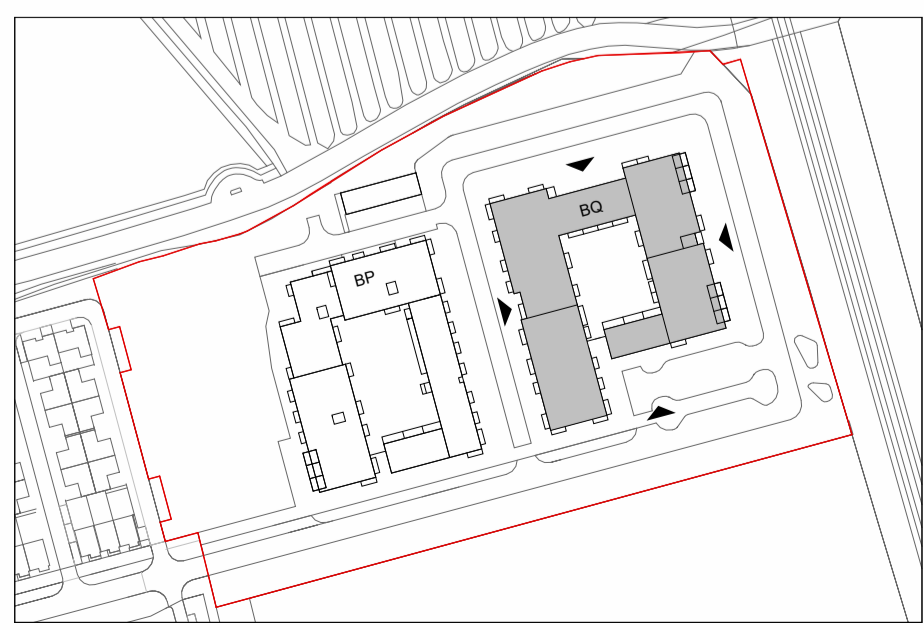

Revision Description	Date	Rev. No.	Issued by
Issued for Information	18-11-2025	P01	MN
Issued for Information	01-12-2025	P02	MN
Issued for Information	08-12-2025	P03	MN
Issued for Information	16-12-2025	P04	MN
Issued for Information	12-01-2026	P05	MN
DLRCC Submission	16-01-2026	C01	MN
Issued for Information	10-02-2026	P06	MN
Issued for Information	25-03-2026	P07	MN
DLRCC Submission	08-05-2026	C02	MN
DLRCC Application	15-06-2026	A3-C01	MN

Any reference to fire safety design or performance is presented for coordination purposes only. Refer only to the granted Fire Safety Certificate, and fire consultant's information for fire safety design, specification and performance.

Figured dimensions only to be used. This drawing is copyright of O'Mahony Pike Architects Ltd. All information is shared as per approved use in accordance with ISO 19650-2:2018, Table 5; Standard Codes for Suitability of Models and Documents and the BEP. If the 'Status' field is empty, this information has been shared at S0 - WIP.

architecture | urban design  
 tel: +353 1 202 7400  
 fax: +353 1 283 0822  
 www.omahonypike.com

Dublin  
 The Chapel  
 Mount St. Anne's  
 Milltown, Dublin 6  
 D06 XN52 Ireland

Cork  
 One South Mall  
 Cork City  
 Co. Cork  
 T12 CCN3 Ireland

Project Code: 1618G  
 Project Lead: SD  
 Drawn By: MN  
 Job No.: 1618G  
 Purpose: For Planning

Scale @ A1: 1 : 200  
 Date: 15-06-2026  
 Revision: A3-C01  
 Status: A3

Project: Woodbrook, Dart Gateway  
 Location: Woodbrook  
 Client: Aeval Unlimited Company

Drawing Title: Block Q - Elevations  
 Drawing No.: 1618G-OMP-BQ-ZZ-DR-A-2001

Source File: Autodesk Docs/15188G-Woodbrook Dart Gateway/1618G-OMP-BQ-ZZ-M3-A-0002.rvt