



3 Block Q - Courtyard East Elevation  
1 : 200



2 Block Q - Courtyard South Elevation  
1 : 200



4 Block Q - Courtyard West Elevation  
1 : 200



1 Block Q - Courtyard North Elevation  
1 : 200

Block Q - Courtyard Elevations

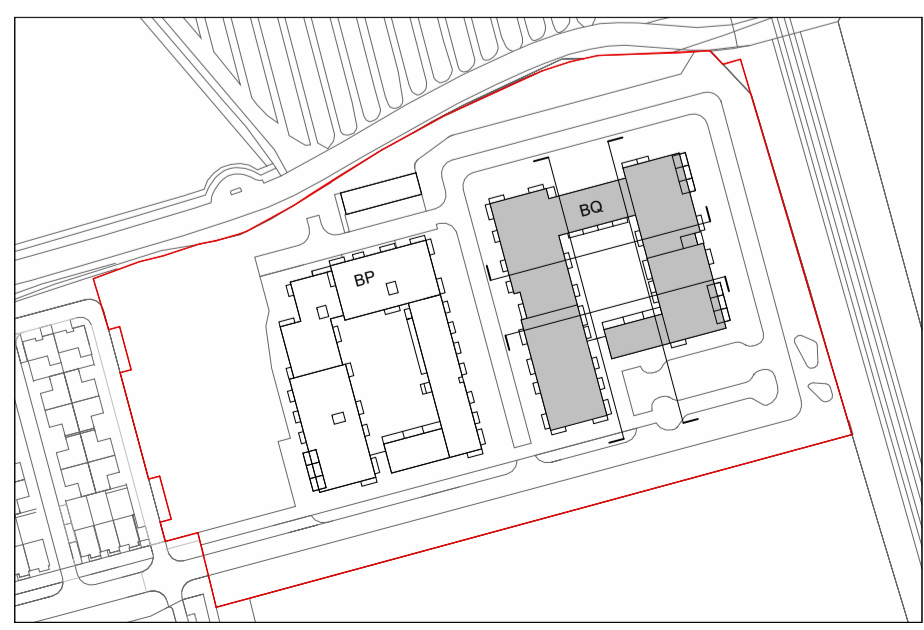

Revision Description	Date	Rev. No.	Issued by
Issued for Information	18-11-2025	P01	MN
Issued for Information	01-12-2025	P02	MN
Issued for Information	08-12-2025	P03	MN
Issued for Information	16-12-2025	P04	MN
Issued for Information	12-01-2026	P05	MN
DLRCC Submission	16-01-2026	C01	MN
Issued for Information	10-02-2026	P06	MN
Issued for Information	25-03-2026	P07	MN
DLRCC Submission	08-05-2026	C02	MN
DLRCC Application	15-06-2026	A3-C01	MN

Any reference to fire safety design or performance is presented for coordination purposes only. Refer only to the granted Fire Safety Certificate, and fire consultant's information for fire safety design, specification and performance.  
 Figure dimensions only to be used. This drawing is copyright of O'Mahony Pike Architects Ltd. All information is shared as per approved use in accordance with ISO 19650-2:2018, Table 5; Standard Codes for Suitability of Models and Documents and the BEP. If the 'Status' field is empty, this information has been shared at S0 - WIP.

**omahony pike**  
 architecture | urban design | dublin | cork  
 email: info@omahonypike.com | tel: +353 1 202 7400 | fax: +353 1 283 0822 | www.omahonypike.com  
 The Chapel | One South Mall | Mount St. Anne's | Cork City | Milltown, Dublin 6 | Co. Cork | D06 XN52 Ireland | T12 CCN3 Ireland

**Project:** Woodbrook, Dart Gateway  
**Location:** Woodbrook  
**Client:** Aeval Unlimited Company

**Project Code:** 1618G  
**Project Lead:** SD  
**Drawn By:** MN  
**Job No.:** 1618G  
**Purpose:** For Planning

**Scale @ A1:** 1 : 200  
**Date:** 15-06-2026  
**Revision:** A3-C01  
**Status:** A3

**Drawing Title:** Block Q - Courtyard Elevations  
**Drawing No.:** 1618G-OMP-BQ-ZZ-DR-A-2002

Source File: Autodesk Docs://1518G-Woodbrook-Dart-Gateway/1618G-OMP-BQ-ZZ-M3-A-0002.rvt