

- THIS DRAWING IS TO BE READ IN CONJUNCTION WITH ALL ENGINEERS & ARCHITECTS DRAWINGS. FIGURED DIMENSIONS ONLY (NOT SCALING) TO BE USED. WHERE A CONFLICT OF INFORMATION EXISTS OR IF IN ANY DOUBT - 'ASK'
- CONSULTANTS TO BE INFORMED IMMEDIATELY OF ANY DISCREPANCIES BEFORE WORK PROCEEDS

MAINTENANCE REQUIREMENTS FOR PERMEABLE PAVEMENTS

REGULAR MAINTENANCE

BRUSHING AND VACUUMING (STANDARD COSMETIC SWEEP OVER WHOLE SURFACE). ONCE A YEAR, AFTER AUTUMN LEAF FALL, OR REDUCED FREQUENCY AS REQUIRED, BASED ON SITE-SPECIFIC OBSERVATIONS OF CLOGGING OR MANUFACTURER'S RECOMMENDATIONS - PAY PARTICULAR ATTENTION TO AREAS WHERE WATER RUNS ONTO PVIOUS SURFACE FROM ADJACENT IMPERMEABLE AREAS AS THIS AREA IS MOST LIKELY TO COLLECT THE MOST SEDIMENT. STABILIZE AND MOW CONTRIBUTING AND ADJACENT AREAS. FREQUENCY - AS REQUIRED REMOVAL OF WEEDS OR MANAGEMENT USING GLYPHOSATE APPLIED DIRECTLY INTO THE WEEDS BY AN APPLICATOR RATHER THAN SPRAYING. FREQUENCY - AS REQUIRED - ONCE PER YEAR ON LESS FREQUENTLY USED PAVEMENTS

REMEDIAL ACTIONS

REMEDiate ANY LANDSCAPING WHICH, THROUGH VEGETATION MAINTENANCE OR SOIL SLIP, HAS BEEN RAISED TO WITHIN 50mm OF THE LEVEL OF THE PAVING. FREQUENCY - AS REQUIRED REMEDIAL WORK TO ANY DEPRESSIONS, RUTTING AND CRACKED OR BROKEN BLOCKS CONSIDERED DETRIMENTAL TO THE STRUCTURAL PERFORMANCE OR A HAZARD TO USERS, AND REPLACEMENT OF LOST JOINTING MATERIAL. FREQUENCY - AS REQUIRED REHABILITATION OF SURFACE AND UPPER SUBSTRUCTURE BY REMEDIAL SWEEPING. FREQUENCY - EVERY 10 TO 15 YEARS OR AS REQUIRED (IF INFILTRATION PERFORMANCE IS REDUCED DUE TO SIGNIFICANT CLOGGING)

MONITORING

INITIAL INSPECTION: MONTHLY FOR THREE MONTHS AFTER INSTALLATION. INSPECT FOR EVIDENCE OF POOR OPERATION AND/OR WEED GROWTH AND IF REQUIRED, TAKE REMEDIAL ACTION THREE-MONTHLY, 48 H AFTER LARGE STORMS IN FIRST SIX MONTHS: INSPECT SILT ACCUMULATION RATES AND ESTABLISH APPROPRIATE BRUSHING FREQUENCIES. MONITOR INSPECTION CHAMBERS ANNUALLY

NOTE:

ON THIS PROJECT TYPE 'B' SYSTEM WILL APPLY EXCEPT WITHIN 1.5m OF BUILDING FOUNDATION OR 1.5m OF THE SITE BOUNDARY

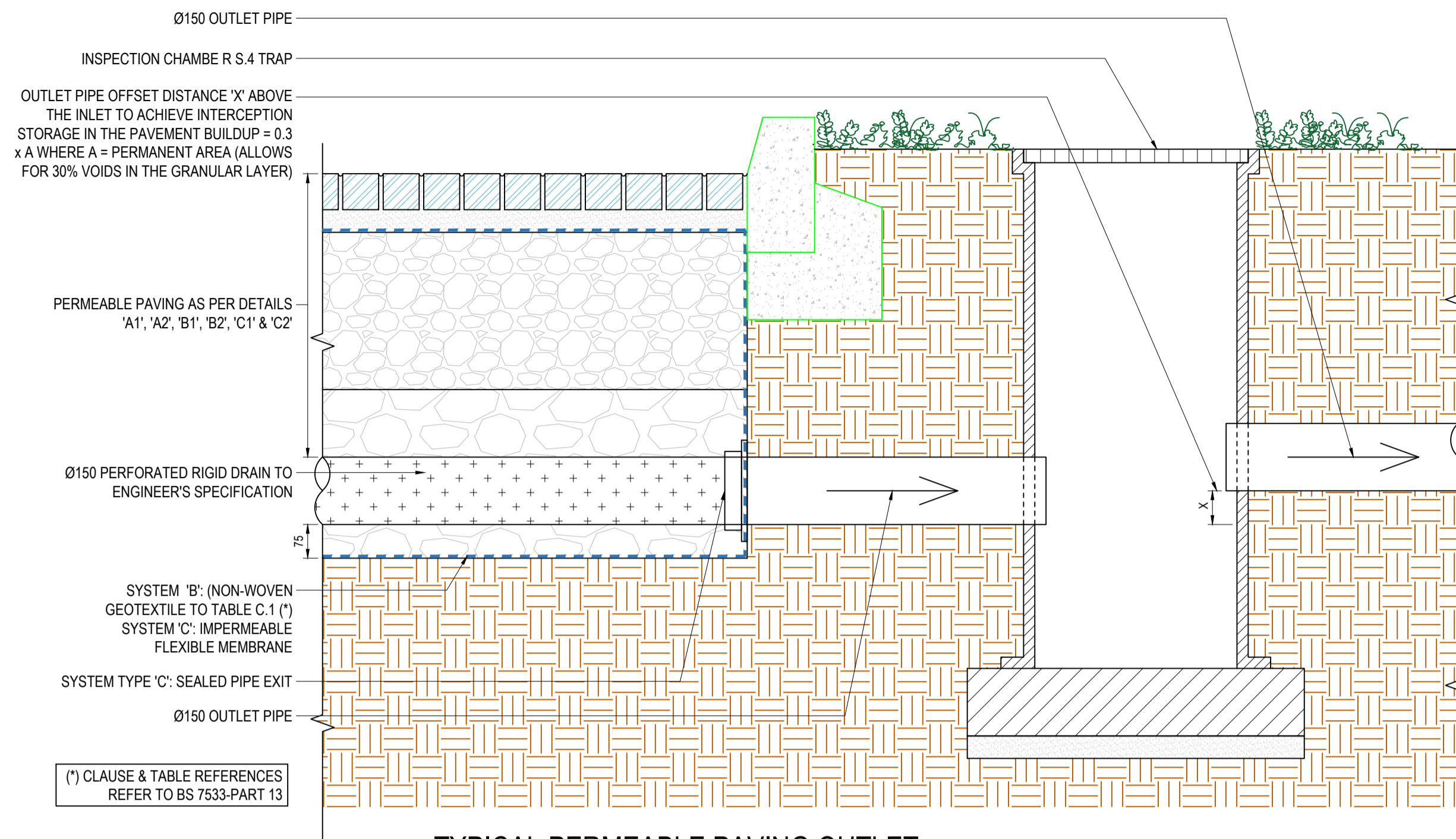

**TYPICAL PERMEABLE PAVING OUTLET
DETAIL, APPLICABLE TO SYSTEMS 'B' & 'C.'**

SCALE 1:10

(*) CLAUSE & TABLE REFERENCES REFER TO BS 7533-PART 13

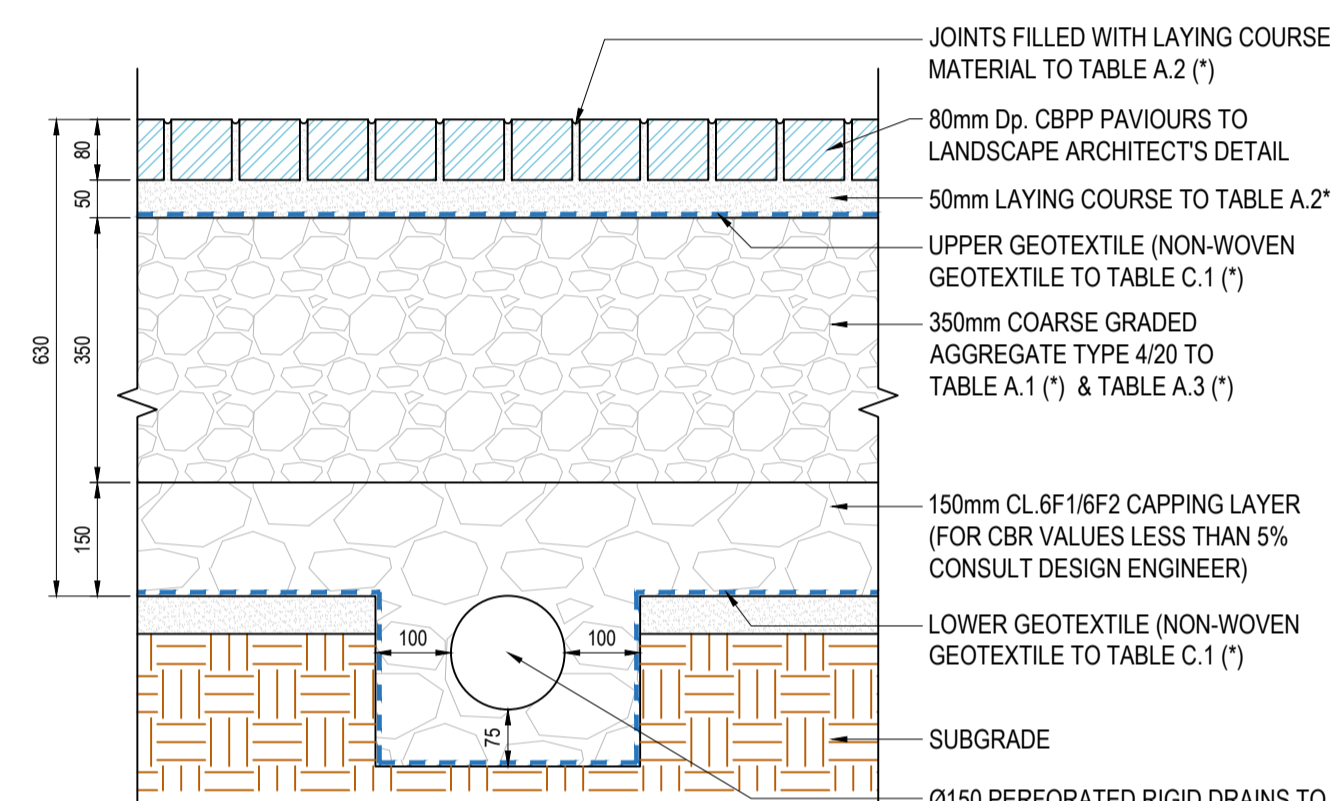

**SYSTEM 'B' PERMEABLE PAVING
TO PEDESTRIAN AREAS
(PARTIAL INFILTRATION)**

SCALE 1:10

(*) CLAUSE & TABLE REFERENCES REFER TO BS 7533-PART 13

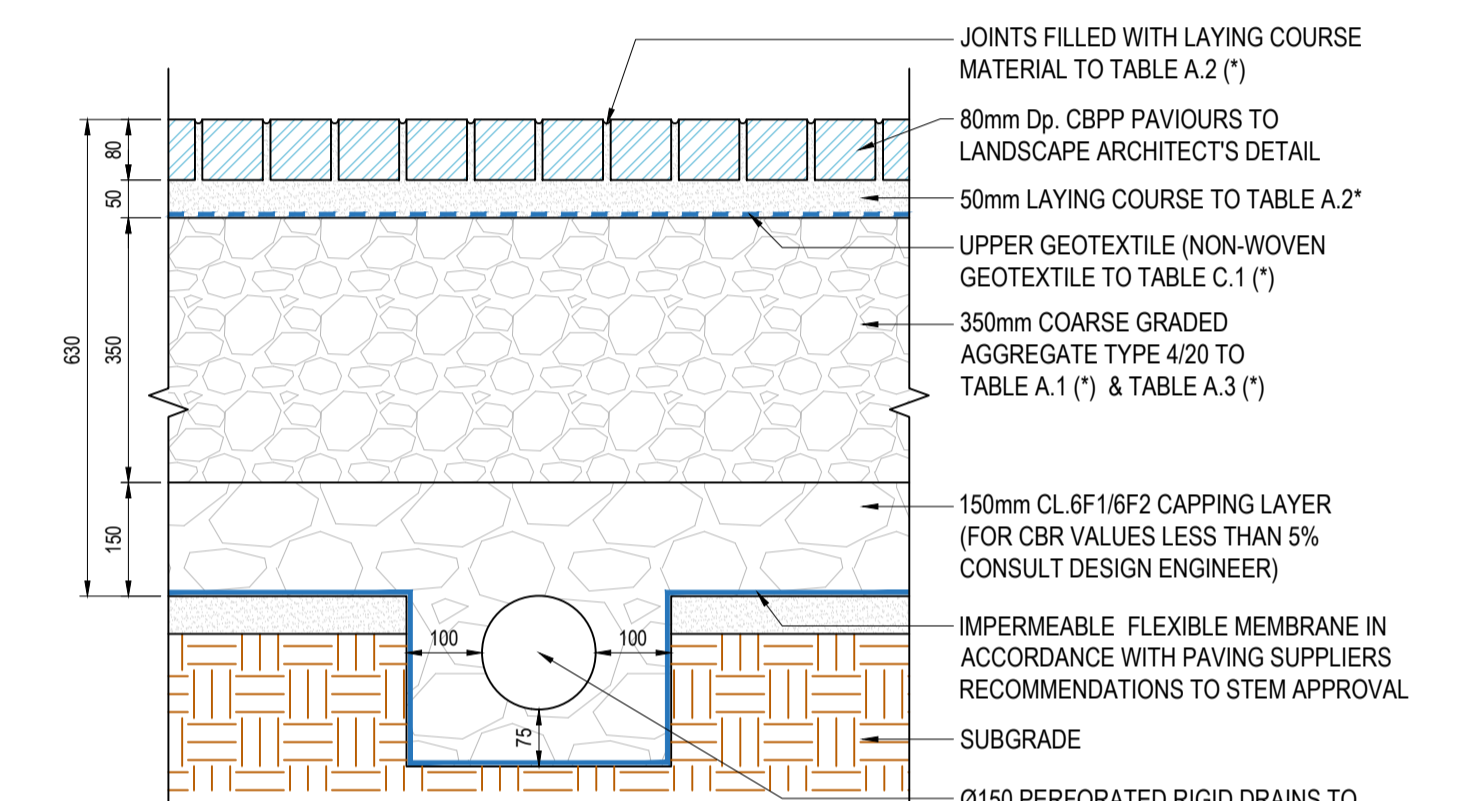

**SYSTEM 'C' PERMEABLE PAVING
TO PEDESTRIAN AREAS
(NO INFILTRATION)**

SCALE 1:10

(*) CLAUSE & TABLE REFERENCES REFER TO BS 7533-PART 13

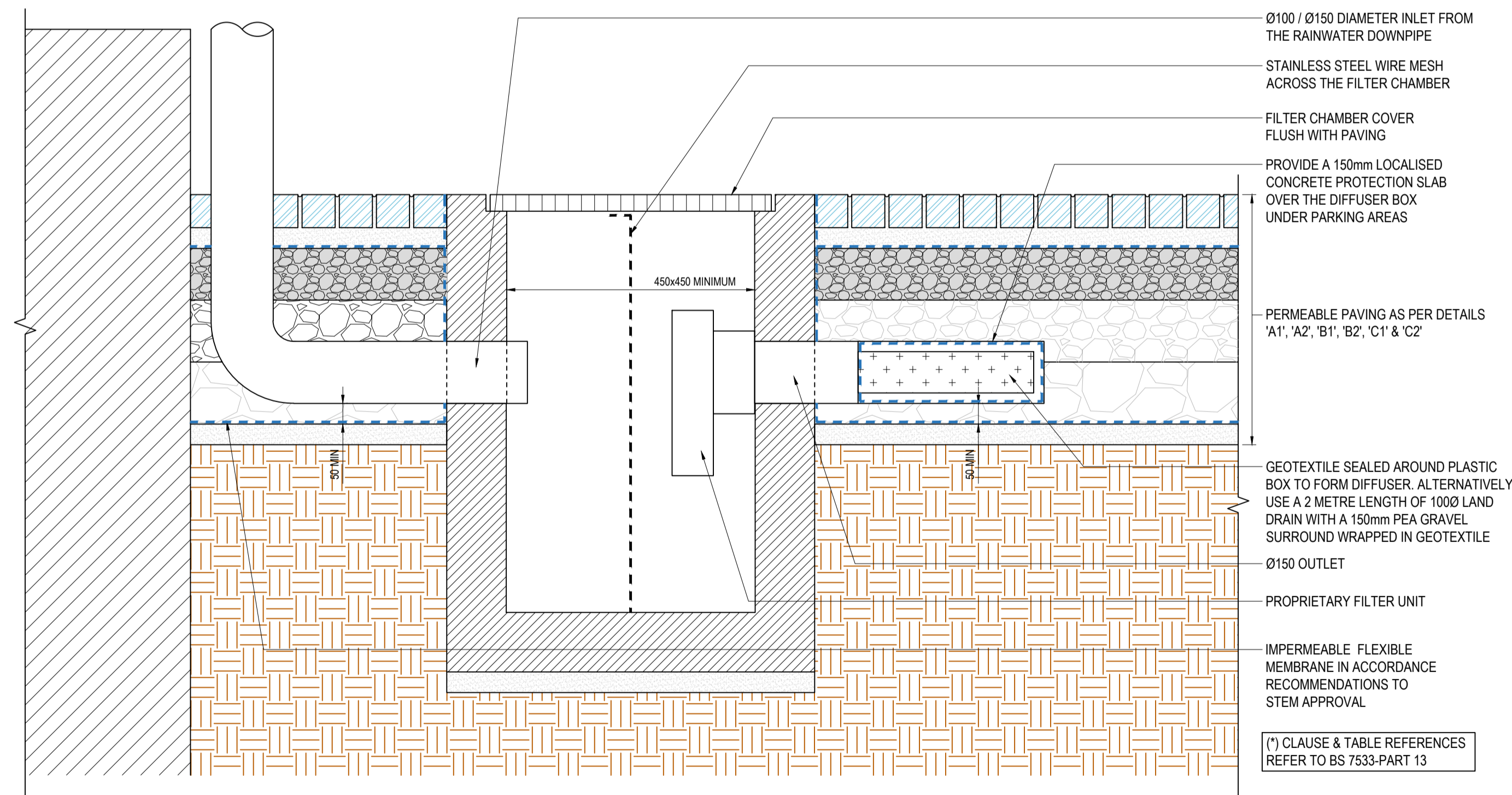

**TYPICAL PERMEABLE PAVING ROOF RAINWATER
PIPE INLET, APPLICABLE TO SYSTEMS 'A', 'B' & 'C.'**

SCALE 1:10

(*) CLAUSE & TABLE REFERENCES REFER TO BS 7533-PART 13

NOTES:

For setting out refer to Architect's drawings. This drawing to be read in conjunction with all other Architectural and Engineering drawings and all other relevant drawings and Specifications. DO NOT SCALE THIS DRAWING. Figured dimensions only to be used in all cases. Verify dimensions on site and report any discrepancies immediately. This drawing is copyright and must not be reproduced, transmitted or stored in any form without the permission of STEM Consulting Engineers Ltd. except as agreed on this project.

P02	BP	AS	FOR PART 8	11.02.2025
P01	BP	AS	FOR COMMENT	30.01.2025
Rev	Dm	Chkd	Amendments	Date

Rev	Dm	Chkd	Amendments	Date
-----	----	------	------------	------

Drawing Sheet Size	A1
--------------------	----

**FOR
PART 8**

Client :	Dun Laoghaire Rathdown County Council
Project :	No. 09 George's Place, Dun Laoghaire
Title :	Typical SuDs Details
Drg No :	24139-STEM-XX-XX-DR-C-411
Scale :	AS SHOWN
Dm By :	BP
Revision :	P02
Status :	S3
Aprvd By :	AS



CIVIL & STRUCTURAL ENGINEERS
4-5 Burton Hall Road,
Sandyford, Dublin,
Ireland, D18 A094
Web: stemtech.ie
E-mail: info@stemtech.ie