

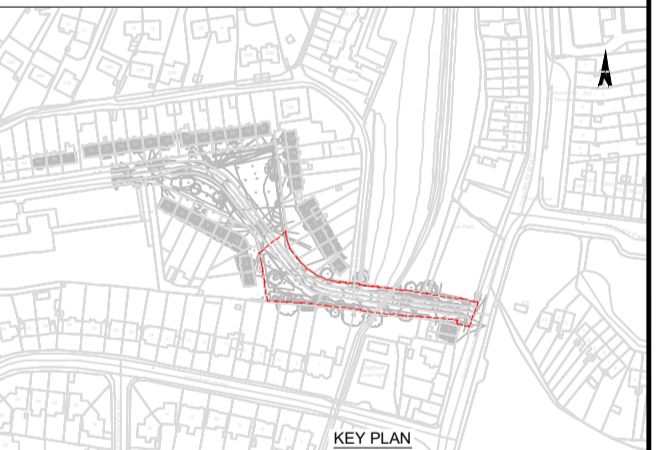

- Notes:
1. This drawing should be read in conjunction with all other drawings and relevant specifications.
 2. Employer's representative to be informed by the contractor of any discrepancies prior to the commencement of the works.
 3. It is responsibility of the contractor to confirm the presence / location of all services during the works.
 4. All boundaries and adjoining roads to be checked on site prior to commencement of works.
 5. Do not scale from this drawing.
 6. Drawings based on topographical survey undertaken by Apex Surveys on November 2025.

LEGEND

[Red dashed line]	AREA PROVIDED BY THE EMPLOYER
[Purple hatched area]	EXISTING TARMAC TO BE RETAINED
[Grey hatched area]	PROPOSED TARMAC
[Light grey line]	EXISTING FOOTPATH
[Dark grey hatched area]	PROPOSED CONCRETE FOOTPATH
[Green hatched area]	PROPOSED GRASSED VERGES
[Orange hatched area]	PROPOSED PARKING SPACES
[Blue line]	PROPOSED KERBS
[Green line]	EXISTING KERB TO REMAIN
[Yellow hatched area]	PROPOSED BUFF BLISTER TACTILE PAVING
[Green hatched area]	PROPOSED PLANTING
[Blue circle]	EXISTING TREES TO BE KEPT IN PLACE
[Blue circle]	PROPOSED BOLLARDS
[Blue square]	EXISTING GULLY TO BE RETAINED
[Blue square]	PROPOSED GULLY



© The National Mapping Division of Taoise Éireann
 All rights reserved. Licence Agreement / CYAL50441399 Dun Laoghaire
 -Rathdown County Council, 2025

Rev.	Date	Revision Details	Drawn	Checked	Approved
C	11/02/2026	For Discussion	SRP	RD	AM
B	05/01/2026	For Discussion	SRP	RD	AM
A	19/12/2025	For Discussion	SRP	RD	AM

© This drawing is the property of SYSTRA Limited and the information can only be reproduced with their prior permission.

SYSTRA
 www.systra.ie
 2nd Floor, Riverview House
 21-23 City Quay, Dublin 2
 D02 FP21
 Tel: +353 1 566 2028

dlr
 Dun Laoghaire Rathdown County Council

Columbanus Road Public Realm Scheme

Preferred Option

Drawn	SRP	Checked	RD	Approved	AM
Original dtp. size	A1	Date	February 2026	Scale	1:250
Drawing Status	For Discussion	Drawing Number	IED1124A01_C_GA_B - Preferred Option	Rev.	C

