

**MAIN FEATURES:**

- 1. Car Park  
Approx. 143no. spaces incl. disabled with car and coach set-down
- 2. Multi-Use Sports Building:  
Building to include reception/admin, internal & external storage, changing rooms, toilets, 60m sprint track, multi-use hall, gymnastics space, café, offices, meeting rooms, viewing terrace, etc
- 3. Running/Walking Trails:  
2.5-3m wide surfaced in compacted gravel or similar
- 4. Stepped Ramp:  
Steep ramp incorporating steps
- 5. Running Track & Field Facilities:  
8 Lane, 400m synthetic track with associated field facilities including long jump and triple jump, water jump, javelin throw, discus and hammer throw, pole vault, shot put and high jump.
- 6. Shared Surface Pedestrian & Cycle Path:  
3m wide compacted gravel surface within current site boundary
- 7. Shared Surface Pedestrian & Cycle Path:  
3m wide running parallel to road - macadam surface
- 8. Vehicular Entrance:  
Granite pillars & steel gate to match the local vernacular and character of the area
- 9. Covered Area for Archers and Bicycle Stands:  
Archers covered space to include Sheffield type bicycle stands on opposite side of wall
- 10. Location for Waste Water Treatment System:  
Treatment system and percolation area to be located within this zone
- 11. Attenuation Wetland  
Bio-retention area/detention basin with water infiltrating into ground

**MAIN FEATURES:**

- 12. Boundary Wall:  
Boundary wall set back and re-built using existing stone and traditional methods
- 13. Boundary Estate Railing:  
1.5m high boundary between the public path and the site to be powder coated to grey colour
- 14. Grass Seating Area  
Seating area alongside track with grass mounding
- 15. Farmers Access:  
Access to be maintained to neighbouring field
- 16. Access to St. Thomas House:  
Existing pillars and gates to be reconstructed to make way for shared surface path
- 17. Safety & Operational Fencing:  
1.5m high paladin type security fencing for safety and orderly operation

**Note:**  
To be read in conjunction with all other drawings & reports

**LEGEND:**

- Site Boundary/Extents
- Existing Contours (0.5m & 2.5m intervals)
- Existing Trees to be Retained (approximate locations) For details see tree survey
- Proposed Woodland Screen Planting
- Floodlights to Track (approximate locations) For details see lighting design
- Existing Overhead Lines to be Retained
- Proposed Contours (0.5m & 2.5m intervals)
- Light Columns/Bollard Lights (approximate locations)

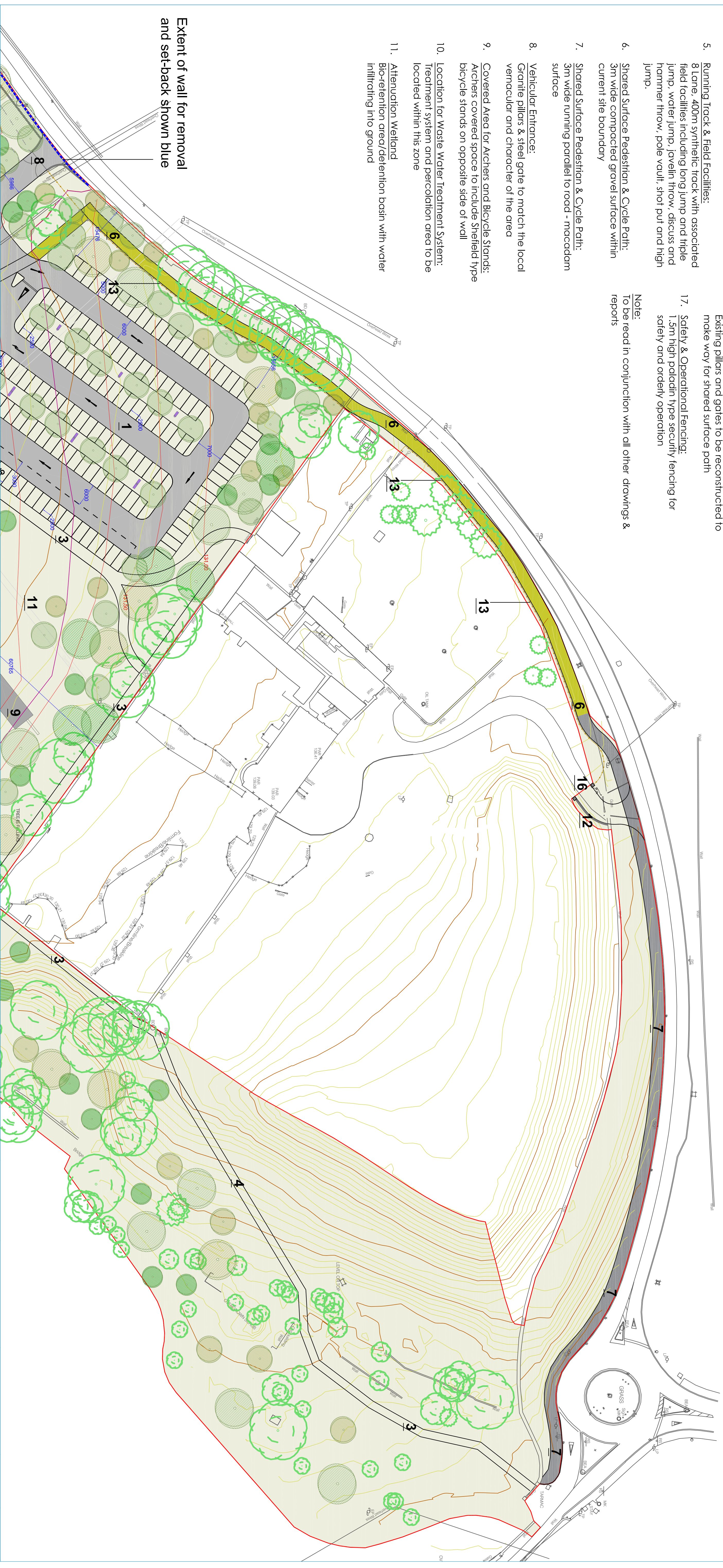

Extent of wall for removal and setback shown blue

Do not scale from this drawing. Use figured dimensions only. Check all dimensions on site before commencing works. Report any discrepancies to the ER before proceeding. All levels to be clarified on site by the ER. This drawing is the copyright of Sean Langhaine Rathdown County Council.