

Do not scale. Use figured dimensions only. All dimensions to be checked on site. Any discrepancies between site and figured dimensions to be brought immediately to the architect's attention. Digital copies cannot be guaranteed. Only information in hard copy can be relied upon for conformity and accuracy. © This drawing is copyright.

GENERAL NOTE
 Any deviation from the proposed specifications to be brought immediately to the architect's attention. All product substitutions to meet the project performance requirements and the minimum requirements of the Building Regulations. All products to be installed in strict accordance with the manufacturer's specification. Any discrepancies between site and figured dimensions to be brought immediately to the architect's attention. Subcontractors to confirm site dimensions with the main contractor prior to manufacture. Subcontractors to supply fabrication drawings to the architect for approval or comment prior to manufacture. All sub-structure, structural steelwork and reinforced concrete to structural engineer's design, detail and specification. Structural precast concrete elements by specialist subcontractor. Any inconsistencies between structural and architectural drawings to be brought immediately to the architect's attention.

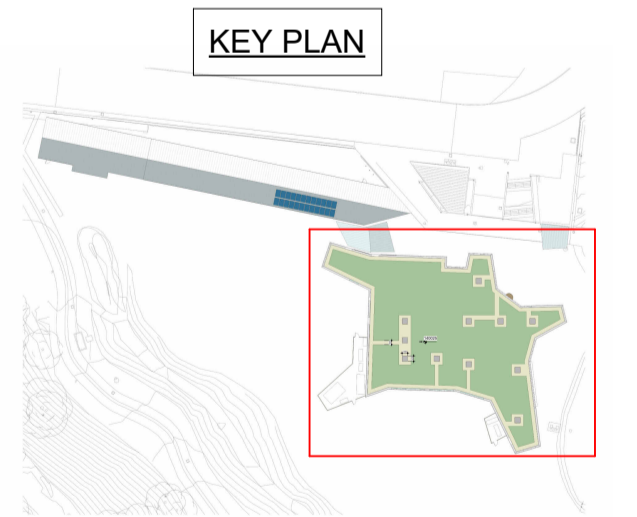
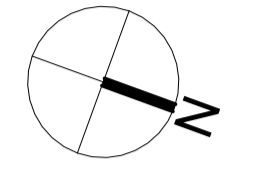

1	05/07/24	TR	PART 8 SUBMISSION
Client:	Dun Laoghaire Rathdown County Council		
Project:	St Thomas Fields		
Drawing title:	Roof Plan (Building)		
Job no:	23008		
Drawing no:	10103		
Scale:	1 : 100@A1	Status:	PLANNING
Drawn:	PD	Checked:	TR
Date created:	09/11/2023	Revision:	1
Drawing Ref:	23008-DMO-Z-DR-A-ZZ-GAP-10103		

Part 8 Submission



Suite 508, The Capel Building, D07 WD23 T +353 1 787 2686 mail@dmod.ie www.dmod.ie

1 Roof Plan (Building)
 1: 100