

1. 2No. Seats with back & armrests
2. Existing Park signage relocated with Granite sett paving beneath.
3. Working area to be cleared of vegetation. Area to be regraded locally to marry sloped access into embankment.
4. Stepped access with handrails and cordroy hazard paving to top and bottom of steps.
5. 2m wide gentle sloped access to Part M Building Regulations.
6. 4m high standard lighting column.
7. Handrail on western side of footpath.
8. 5m length of existing wall capping shall be cleared of vegetation and repaired and repointed .
9. New reconstituted stone gateway structure to be installed and random rubble granite reinstated to butt up to structure.
10. New road kerb.
11. Terrace planters.
12. Feature stone banding.
13. 4No. cycle racks.
14. Existing traffic calming table to be altered to create an accessible crossing.
15. Disabled parking bay.
16. Drop kerb.
17. Remove existing pole.
18. Break out existing brick kerb and resurface arrival area.
19. Existing Gas access chamber to be left unaltered.
20. 2No. cargo bike parking racks.
21. Seating space.
22. Extend stone retaining wall .
23. Feature sett paving threshold.
24. Drop bollards sockets to allow for further car parking control if necessary.
25. 100mm perforated PVC filter drain.

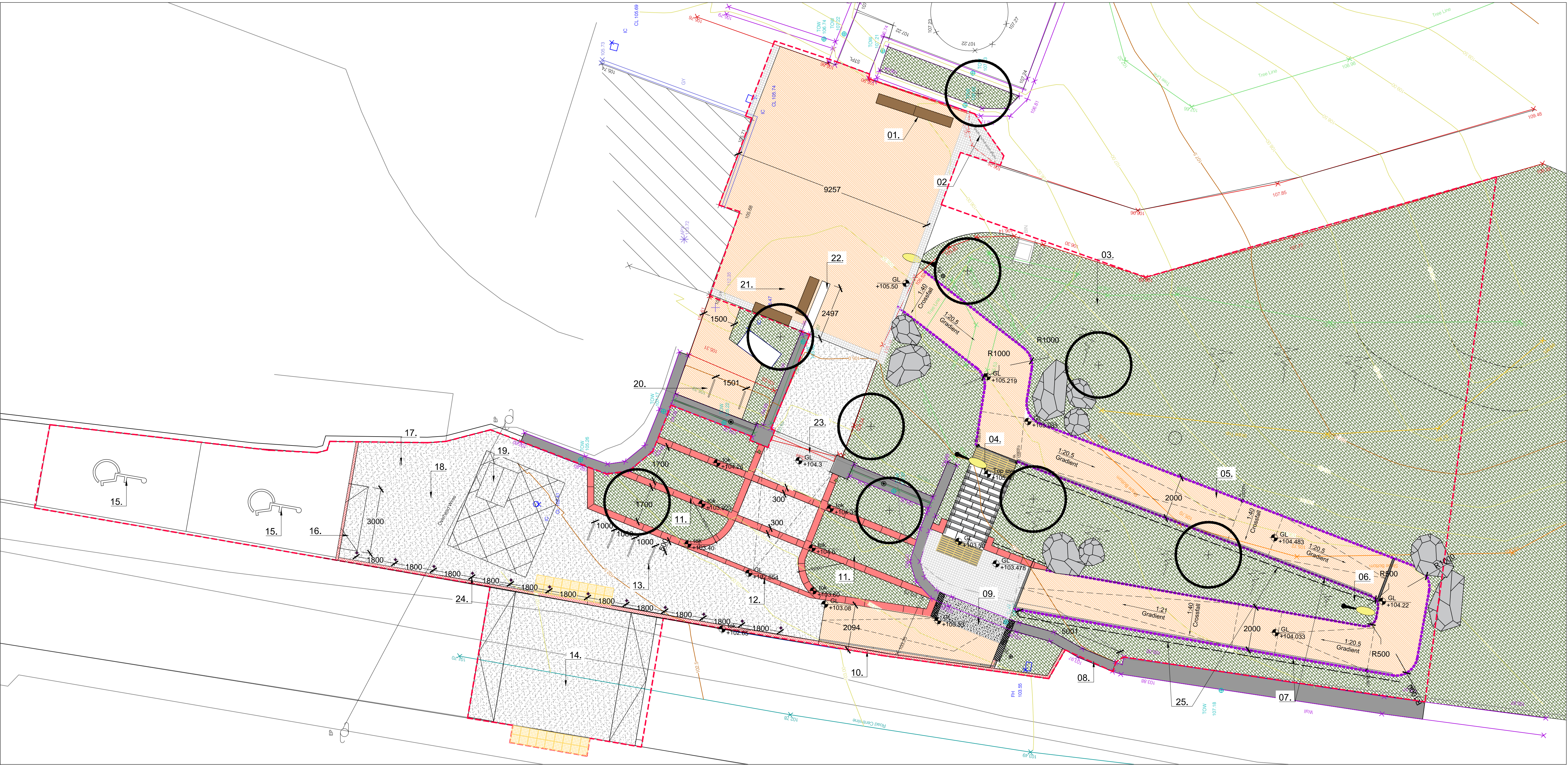

- Specimen tree planting
- 100mm PVC perforated filter drain in stone trench.
- Aco channel Civic Drain
- 50x250x900mm stone pin kerb edging
- New in-situ concrete kerb
- Ornamental Planting
- Proposed New granite kerb / edging
- Concrete footpath construction with resin bonded finish.
- 100x100x60mm granite setts to threshold areas.
- 600x200x400mm granite steps
- 400x400x60mm corduroy granite paving units.
- Selected granite boulders 500-1200mm to be positioned on site as identified on plan.
- Seating
- Drop Bollards
- 4m high Lighting standard
- In-ground Up-lighters
- LEGEND

PLAN PROPOSAL FOR UNIVERSAL ACCESS ENTRANCE
Scale 1:100

Drawing Title:
KILLINEY HILL UNIVERSAL ACCESSIBLE ENTRANCE
General Arrangement

Senior Parks Superintendent : Ruairi O'Dulaing
County Hall, Dun Laoghaire, Co. Dublin.

Drawing Number:	Revision:	Scale:	Date:	Drawn:	Checked:
DLR-PK-2445-003	A	1/100 A1	Sep 2021	MC	EOB

