

EXTRACT FROM OS MAP CABINTEELY PARK

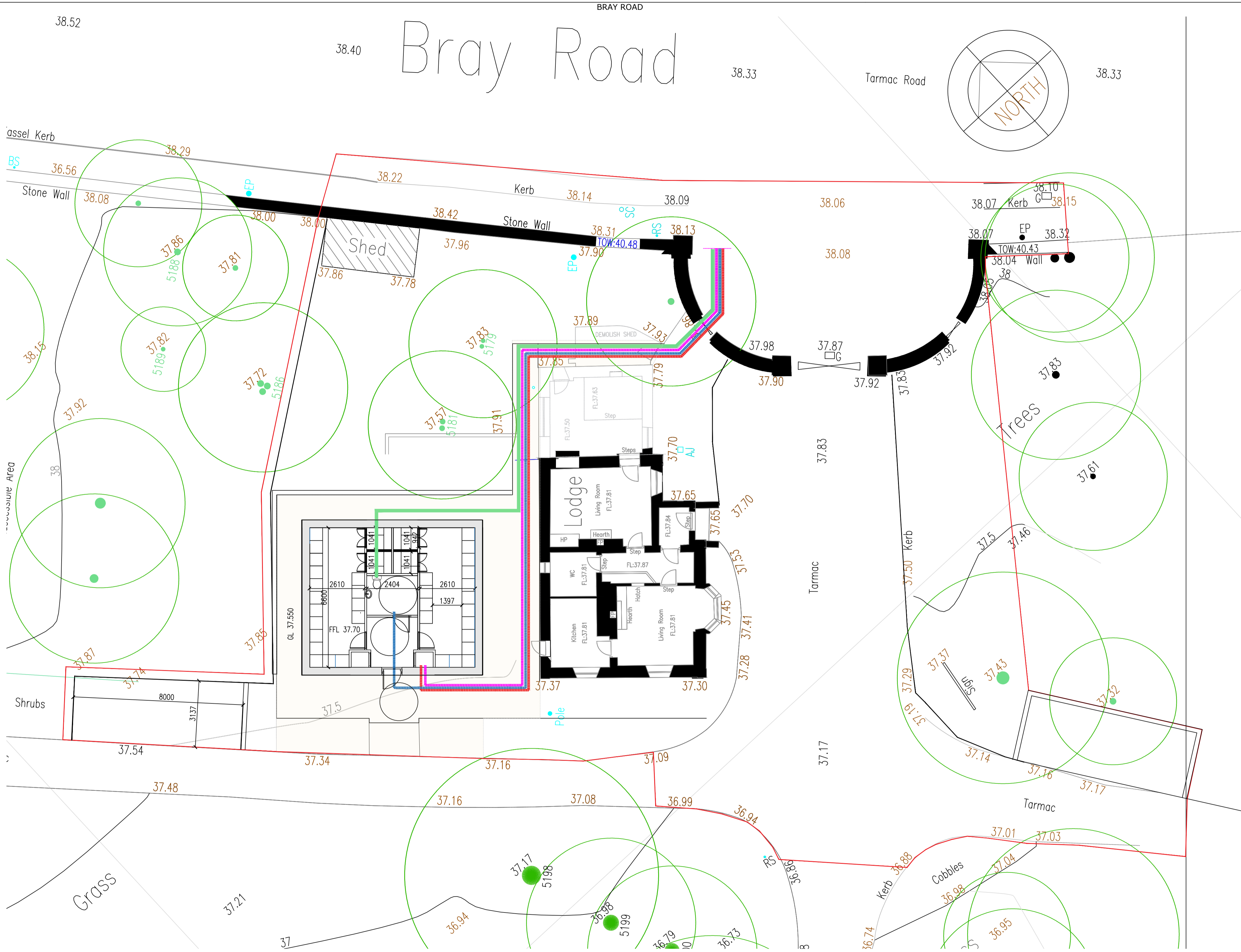

KEY SERVICES DUCTS	
—	MAINS WATER
—	FOUL SEWER
—	ESB
—	EIR

Restoration of Existing Lodge

Existing building to be restored in accordance with conservation principles under the direction of a conservation architect.

Single storey later extension to be removed.

Roof
Repair and reslate existing roof
Additional slates to match existing.

Walls
To be replastered with lime mortar.

Windows and doors
Repair existing joinery and replace to original detail if joinery is missing

Use to be as Park building for compatible Park use.

Proposed Changing Building

Timber framed highly insulated building

Two changing rooms

Equipment Stores

Shared toilet with disabled use

Cedar Cladding sheeting to exterior.

Fibreglass or zinc seamed roof

Velux windows with rain sensors

Photovoltaic panels to generate electric power.

No.	Date	Drawn	Description

Project
Changing Building and restoration of Existing Lodge
Cabinteely Park
Dublin 18

Client; Parks Department
Dun Laoghaire Rathdown
County Hall Dun Laoghaire Co Dublin

Title: PART 8 APPLICATION
Proposed Plan



Scale - 1:100		Status - Part 8	
Date - 3.7.2024	CAD Ref -		
Job No - 9020	Drawing No - 02	Rev -	00
Dm. POC	Chd.		

PROPOSED GROUND FLOOR PLAN
NEW CHANGING AND EXISTING LODGE 1:100