

Nissan Stadium, Yokohama, Japan

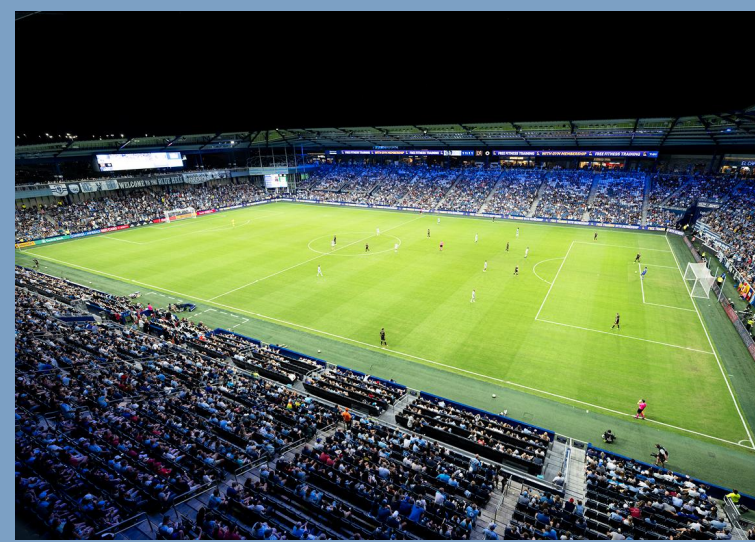

Children's Mercy Park, Sporting KC, Kansas City, Kansas, USA

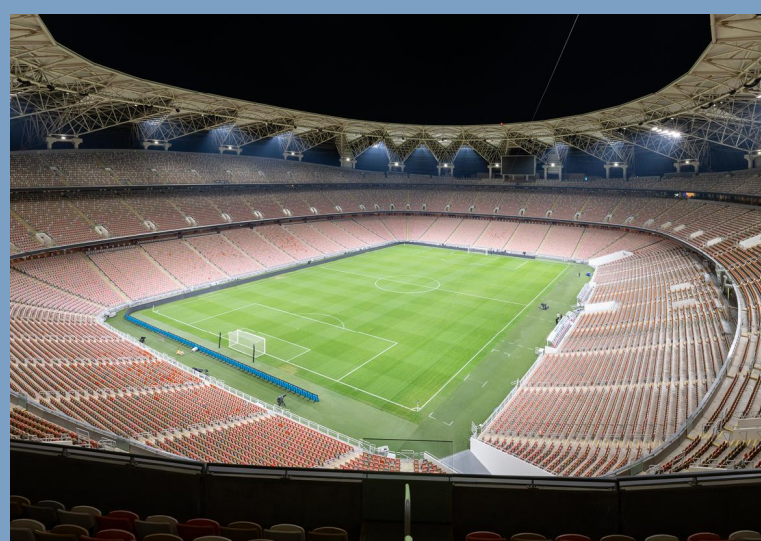

King Abdullah Sports City Stadium, Jeddah, Saudi Arabia



Emirates Stadium, Arsenal FC, London, UK

Kilbogget Park

Loughlinstown, Leinster



Sales Representative: Neil McSherry · Designed By: C.McDole · Design No.: 249052A · October 28, 2025



FLOODLIGHTS

Kilbogget Park

Loughlinstown, Leinster

LIGHTING SYSTEM

Structure/Fixture Summary						
Structure ID	Structure Height	Fixt. Attachment Ht.	Fixture Qty	Fixture Type	Load	Circuit
M1-M4	12.2 m	12.2 m	2	TLC-LED-550	1.08 kW	A
4			8		4.32 kW	

Circuit Summary			
Circuit	Description	Load	Fixture Qty
A		4.32 kW	8

Fixture Type Summary								
Type	Circuit	Source	Wattage	Lumens	L90	L80	L70	Quantity
TLC-LED-550	A	LED 5700K - 75 CRI	540W	67,000	>120,000	>120,000	>120,000	8

Single Fixture Amperage Draw Chart							
Driver Specifications (.90 min power factor)	Line Amperage Per Fixture (max draw)						
	208 (60)	220 (60)	240 (60)	277 (60)	347 (60)	380 (60)	480 (60)
Single Phase Voltage TLC-LED-550	3.2	3.0	2.8	2.4	1.9	1.8	1.4

Light Level Summary

Calculation Grid Summary								
Grid Name	Calculation Metric	Illumination Ave					Circuits	Fixture Qty
		Ave	Min	Max	Min/Max	Min/Ave		
LTW	Max Vertical Illuminance Metric	0.00	0	0	-	0.00	A	8
MUGA	Horizontal Illuminance	225.25	174	257	0.68	0.77	A	8
Spill	Horizontal	22.73	0	295	0.00	0.00	A	8
Spill	Max Vert Illuminance (by Light Bank)	30.71	0	395	0.00	0.00	A	8

Guaranteed Performance: The ILLUMINATION described above is guaranteed per your Musco Warranty document.

Field Measurements: Individual field measurements may vary from computer-calculated predictions.

Electrical System Requirements: Refer to Amperage Draw Chart and/or the "Musco Control System Summary" for electrical sizing.

Installation Requirements: Results assume ± 3% nominal voltage at line side of the driver and structures located within 3 feet (1m) of design locations.



Structure				Fixtures				
QTY	STRUCTURE ID	SIZE	GRADE ELEVATION	ABOVE FIELD LEVEL	FIXTURE TYPE	QTY/POLE	THIS GRID	OTHER GRIDS
4	M1-M4	12.19m	-	12.19m	TLC-LED-550	2	2	0
4	Totals					8	8	0

Above Field Level is height of fixtures above area shown

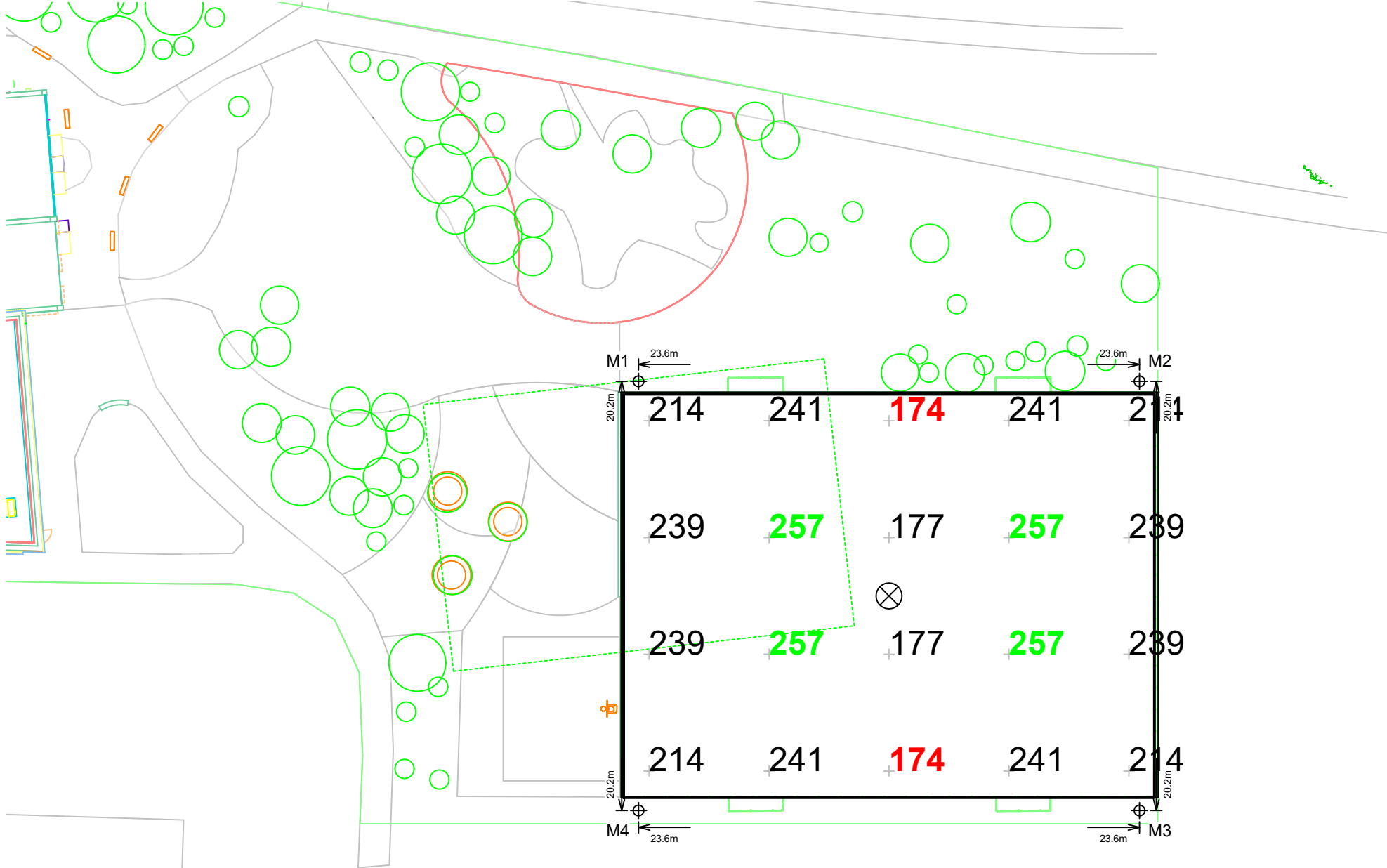

Kilbogget Park

Loughlinstown, Leinster

Grid Summary	
Name:	MUGA
Size:	50.0m x 38.0m
Spacing:	11.3m x 11.0m
Height:	1.0m above grade

Illumination Summary	
	MAINTAINED HORIZONTAL LUX
Entire Grid	
Guaranteed Average:	200
Scan Average:	225.25
Maximum:	257
Minimum:	174
Guaranteed Min/Avg:	0.6
Min/Avg:	0.77
Min/Max:	0.68
UG (adjacent pts):	1.45
CU:	1.00
No. of Points:	20
FIXTURE INFORMATION	
Applied Circuits:	A
No. of Fixtures:	8
Total Load:	4.32 kW

Guaranteed Performance: The ILLUMINATION described above is guaranteed per your Musco Warranty document.

Field Measurements: Individual field measurements may vary from computer-calculated predictions.

Electrical System Requirements: Refer to Amperage Draw Chart and/or the "Musco Control System Summary" for electrical sizing.

Installation Requirements: Results assume ± 3% nominal voltage at line side of the driver and structures located within 3 feet (1m) of design locations.

SCALE IN METERS 1 : 500

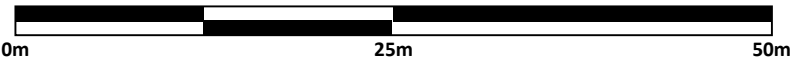

Pole location(s) ⊕ dimensions are relative to 0,0 reference point(s) ⊗



Equipment List For Areas Shown

Structure				Fixtures				
QTY	STRUCTURE ID	SIZE	GRADE ELEVATION	ABOVE FIELD LEVEL	FIXTURE TYPE	QTY/POLE	THIS GRID	OTHER GRIDS
4	M1-M4	12.19m	-	12.19m	TLC-LED-550	2	2	0
4	Totals					8	8	0

Above Field Level is height of fixtures above area shown

Kilbogget Park

Loughlinstown, Leinster

Grid Summary	
Name:	LTW
Size:	50.0m x 38.0m
Spacing:	9.1m x 3.0m
Height:	1.5m above grade

Illumination Summary		MAINTAINED MAX VERTICAL LUX
		Entire Grid
Scan Average:	0.00	
Maximum:	0	
Minimum:	0	
Min/Avg:	0.00	
Min/Max:	-	
UG (adjacent pts):	0.00	
CU:	0.00	
No. of Points:	10	
FIXTURE INFORMATION		
Applied Circuits:	A	
No. of Fixtures:	8	
Total Load:	4.32 kW	

Guaranteed Performance: The ILLUMINATION described above is guaranteed per your Musco Warranty document.

Field Measurements: Individual field measurements may vary from computer-calculated predictions.

Electrical System Requirements: Refer to Amperage Draw Chart and/or the "Musco Control System Summary" for electrical sizing.

Installation Requirements: Results assume ± 3% nominal voltage at line side of the driver and structures located within 3 feet (1m) of design locations.

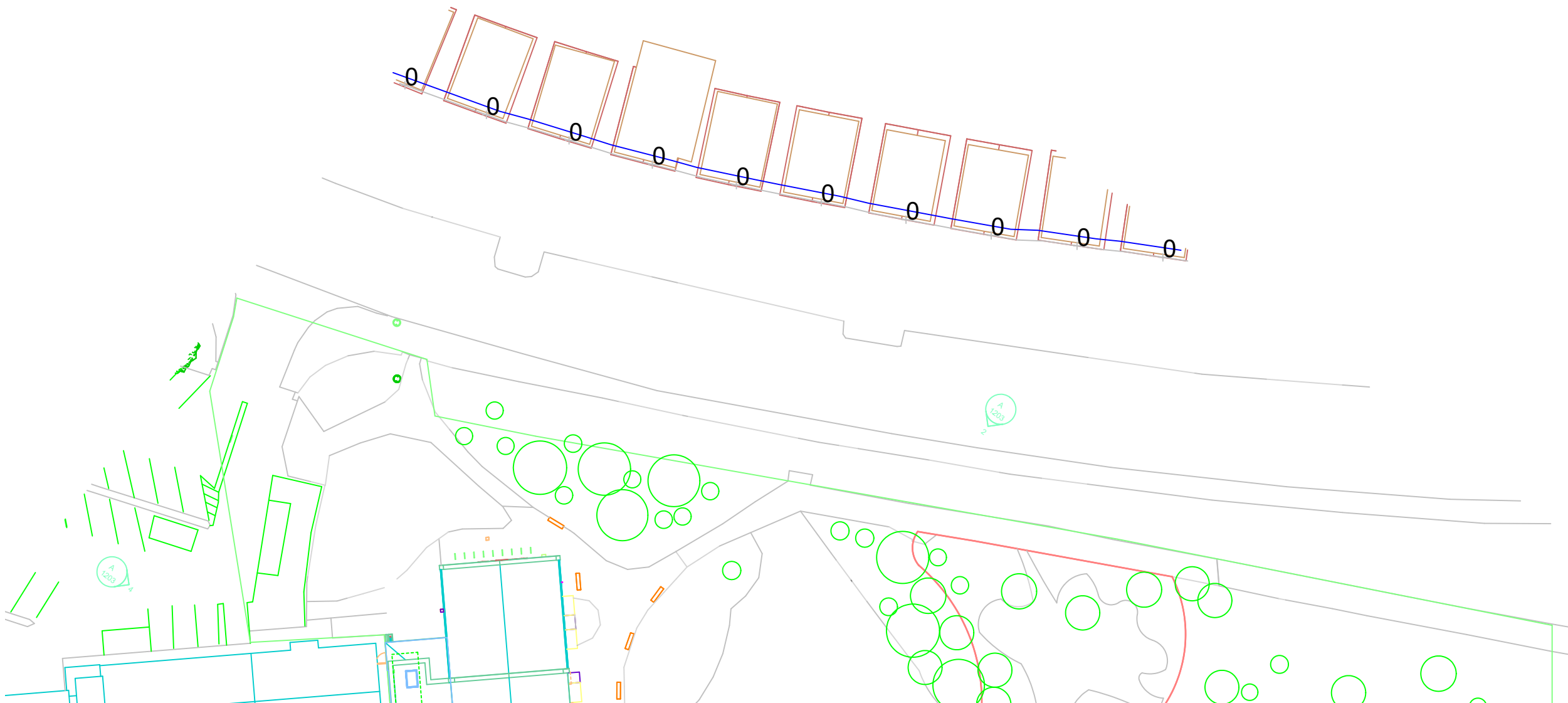

SCALE IN METERS 1 : 500



Pole location(s) ⊕ dimensions are relative to 0,0 reference point(s) ⊗

ENGINEERED DESIGN By: C.McDole • File #249052A • 28-Oct-25



Not to be reproduced in whole or part without the written consent of Musco Sports Lighting, LLC. ©1981, 2025 Musco Sports Lighting, LLC.

ILLUMINATION SUMMARY

Equipment List For Areas Shown

Structure				Fixtures				
QTY	STRUCTURE ID	SIZE	GRADE ELEVATION	ABOVE FIELD LEVEL	FIXTURE TYPE	QTY/POLE	THIS GRID	OTHER GRIDS
4	M1-M4	12.19m	-	12.19m	TLC-LED-550	2	2	0
4	Totals					8	8	0

Above Field Level is height of fixtures above area shown

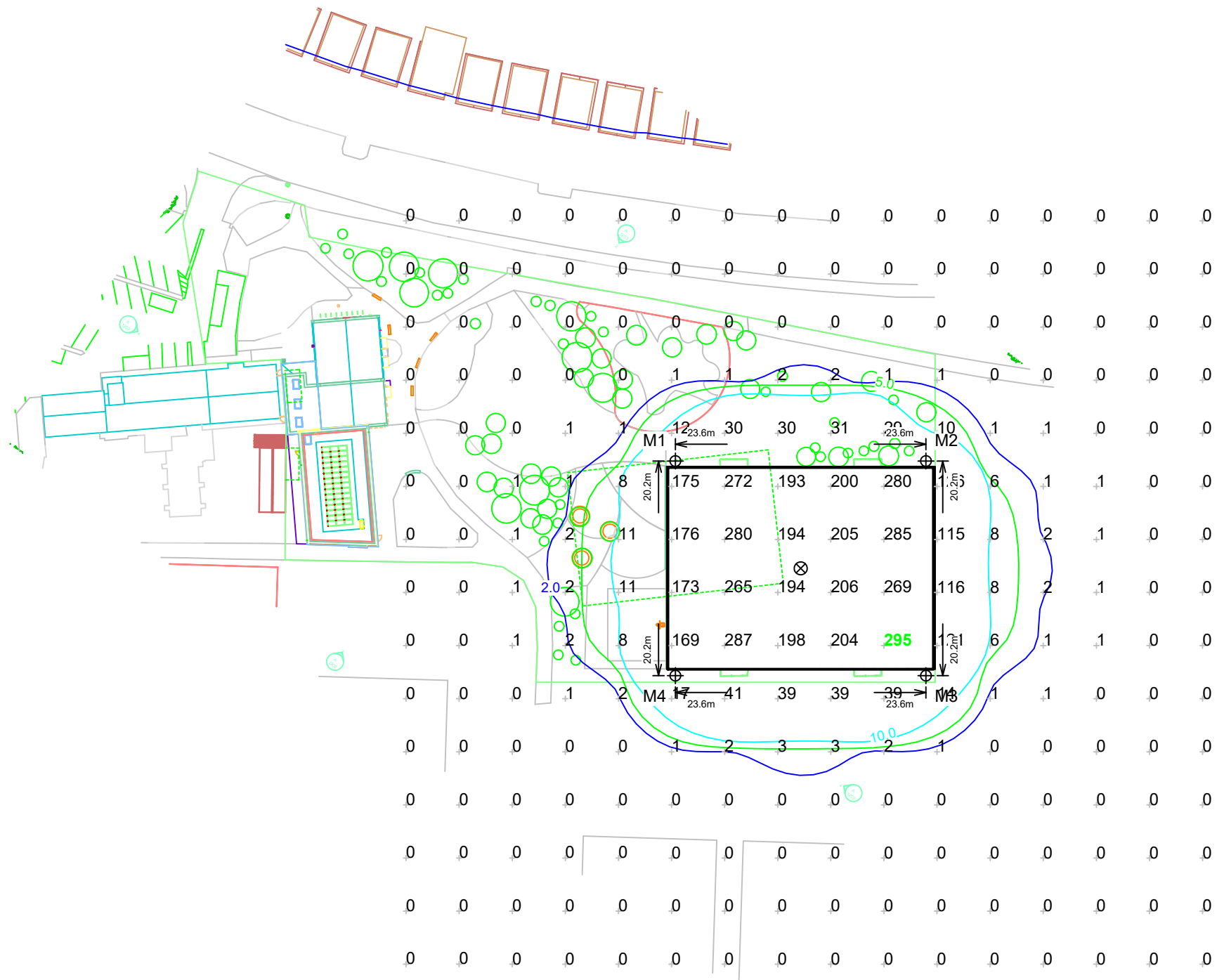

Kilbogget Park

Loughlinstown, Leinster

Grid Summary	
Name:	Spill
Size:	50.0m x 38.0m
Spacing:	10.0m x 10.0m
Height:	0.9m above grade

Illumination Summary	
	MAINTAINED HORIZONTAL LUX
Entire Grid	
Scan Average:	22.73
Maximum:	295
Minimum:	0
Min/Avg:	0.00
Min/Max:	0.00
UG (adjacent pts):	55.96
CU:	1.00
No. of Points:	240
FIXTURE INFORMATION	
Applied Circuits:	A
No. of Fixtures:	8
Total Load:	4.32 kW

Guaranteed Performance: The ILLUMINATION described above is guaranteed per your Musco Warranty document.

Field Measurements: Individual field measurements may vary from computer-calculated predictions.

Electrical System Requirements: Refer to Amperage Draw Chart and/or the "Musco Control System Summary" for electrical sizing.

Installation Requirements: Results assume ± 3% nominal voltage at line side of the driver and structures located within 3 feet (1m) of design locations.

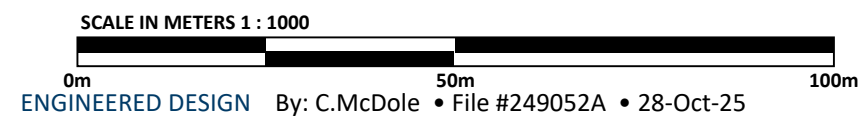

Pole location(s) ⊕ dimensions are relative to 0,0 reference point(s) ⊗



Not to be reproduced in whole or part without the written consent of Musco Sports Lighting, LLC. ©1981, 2025 Musco Sports Lighting, LLC.

ILLUMINATION SUMMARY

Equipment List For Areas Shown

Structure				Fixtures				
QTY	STRUCTURE ID	SIZE	GRADE ELEVATION	ABOVE FIELD LEVEL	FIXTURE TYPE	QTY/POLE	THIS GRID	OTHER GRIDS
4	M1-M4	12.19m	-	12.19m	TLC-LED-550	2	2	0
4	Totals					8	8	0

Above Field Level is height of fixtures above area shown

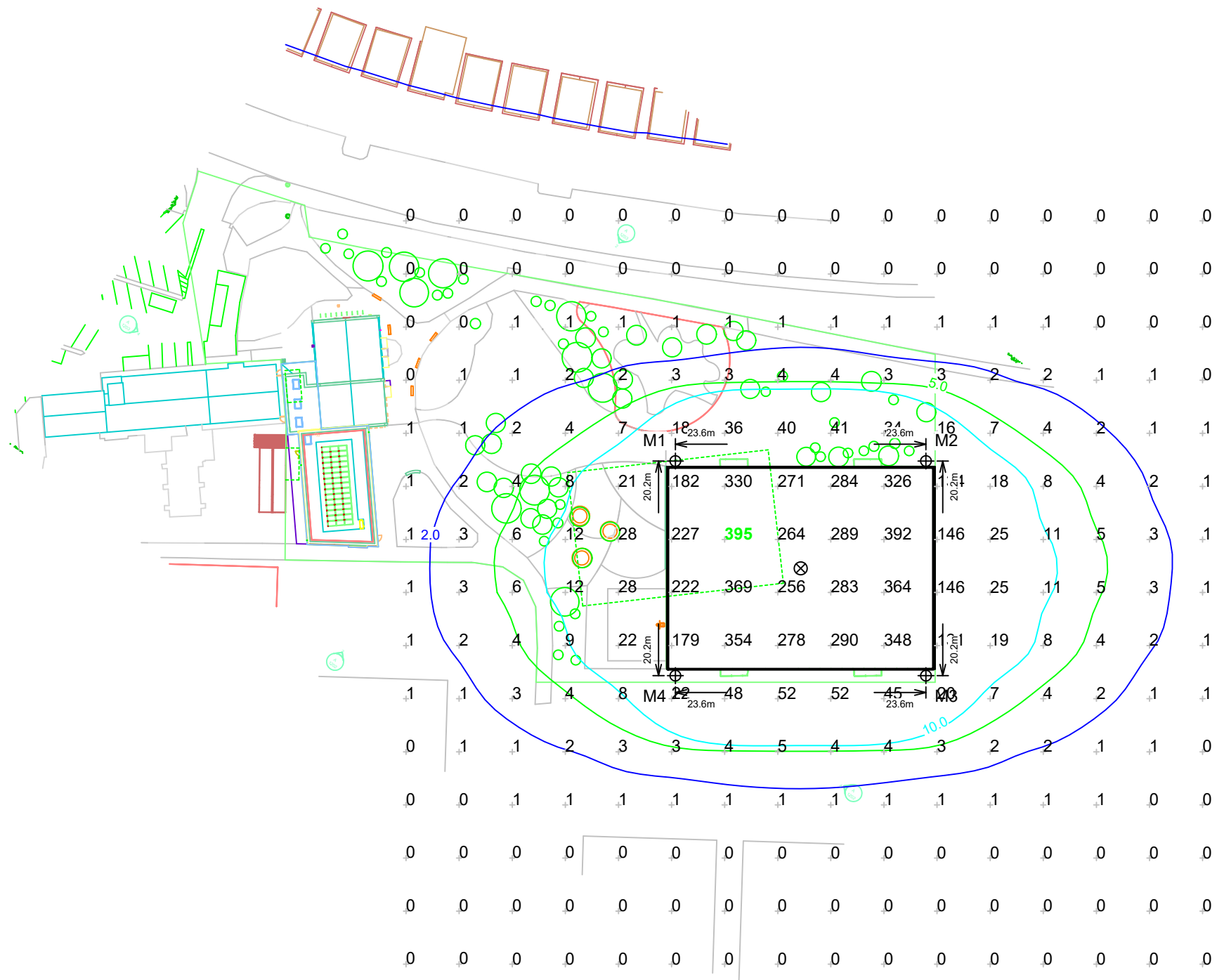

Kilbogget Park

Loughlinstown, Leinster

Grid Summary	
Name:	Spill
Size:	50.0m x 38.0m
Spacing:	10.0m x 10.0m
Height:	0.9m above grade

Illumination Summary	
	ENTIRE GRID
Scan Average:	30.71
Maximum:	395
Minimum:	0
Min/Avg:	0.00
Min/Max:	0.00
UG (adjacent pts):	48.50
CU:	1.00
No. of Points:	240
FIXTURE INFORMATION	
Applied Circuits:	A
No. of Fixtures:	8
Total Load:	4.32 kW

Guaranteed Performance: The ILLUMINATION described above is guaranteed per your Musco Warranty document.

Field Measurements: Individual field measurements may vary from computer-calculated predictions.

Electrical System Requirements: Refer to Amperage Draw Chart and/or the "Musco Control System Summary" for electrical sizing.

Installation Requirements: Results assume ± 3% nominal voltage at line side of the driver and structures located within 3 feet (1m) of design locations.

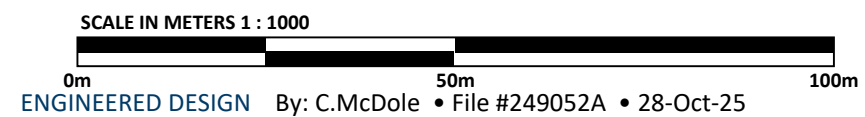

Pole location(s) ⊕ dimensions are relative to 0,0 reference point(s) ⊗



Not to be reproduced in whole or part without the written consent of Musco Sports Lighting, LLC. ©1981, 2025 Musco Sports Lighting, LLC.

ILLUMINATION SUMMARY