

KEY:

Emerg. Rt / Site Road	Steelshield Fence	Heras Fence	Stage Sightline
Toilet Block	Concession	First Aid Post	CCTV Camera
Emergency Exit Route	Drinking Water	Fire Hydrant	Water Pipe
Pedestrian Route	Floodlights (Indicative)	Festoon Lit Walkway	Route and Park Exit
Trackway Panels Are 3m Wide And Are Suitable For Carrying a 16.25 Tonne Fire Appliance.		Water	Enteror Routes
			Pedestrian Access to Woods

— SITE BOUNDARY

Access to and from the coffee shop will be via the Walled Nursery Garden via the Grange Road.

KEY CONTACTS

Licence Compliance - Ange Goliger Tel: 086 0295820  
Fire Safety Officer - David Slattery Tel: 087 9437787  
Fire Safety Officer - Adrian Sutton Tel: 086 3940225

SCALE 1:2500 (@ A1)  
DRAWING BY  
RICHARD WHITE  
FOR  
MELVIN BENN AND FESTIVAL REPUBLIC

CONTACT: MELVIN BENN  
THE FESTIVAL OFFICE  
BORD GAIS ENERGY THEATRE  
GRAND CANAL SQUARE  
DOCKLANDS, DUBLIN 2

TEL (01) 6742476  
GRIDLINES 50M X 50M

REV	DESCRIPTION	DATE
<b>MSA</b> Michael Slattery Associates Fire Safety Engineers Dublin / Belfast / Leeds www.msa.ie 19 Windsor Place Lower Pembroke Place Dublin 2, Ireland Tel: +353(1)6765713 Fax: +353(1)6785247 Building Design & Construction Fire Engineering Design Event Safety & Management Building Fire Safety Management Disabled Access Consultancy Computer Modelling		
PROJECT MARLAY PARK 2015		
TITLE SITE LOCATION		
SCALE 1:2500 @ A1	JOB NO IS109	
DATE 13.04.2015	DWG NO IS109-02	
CHECKED BY	REV	



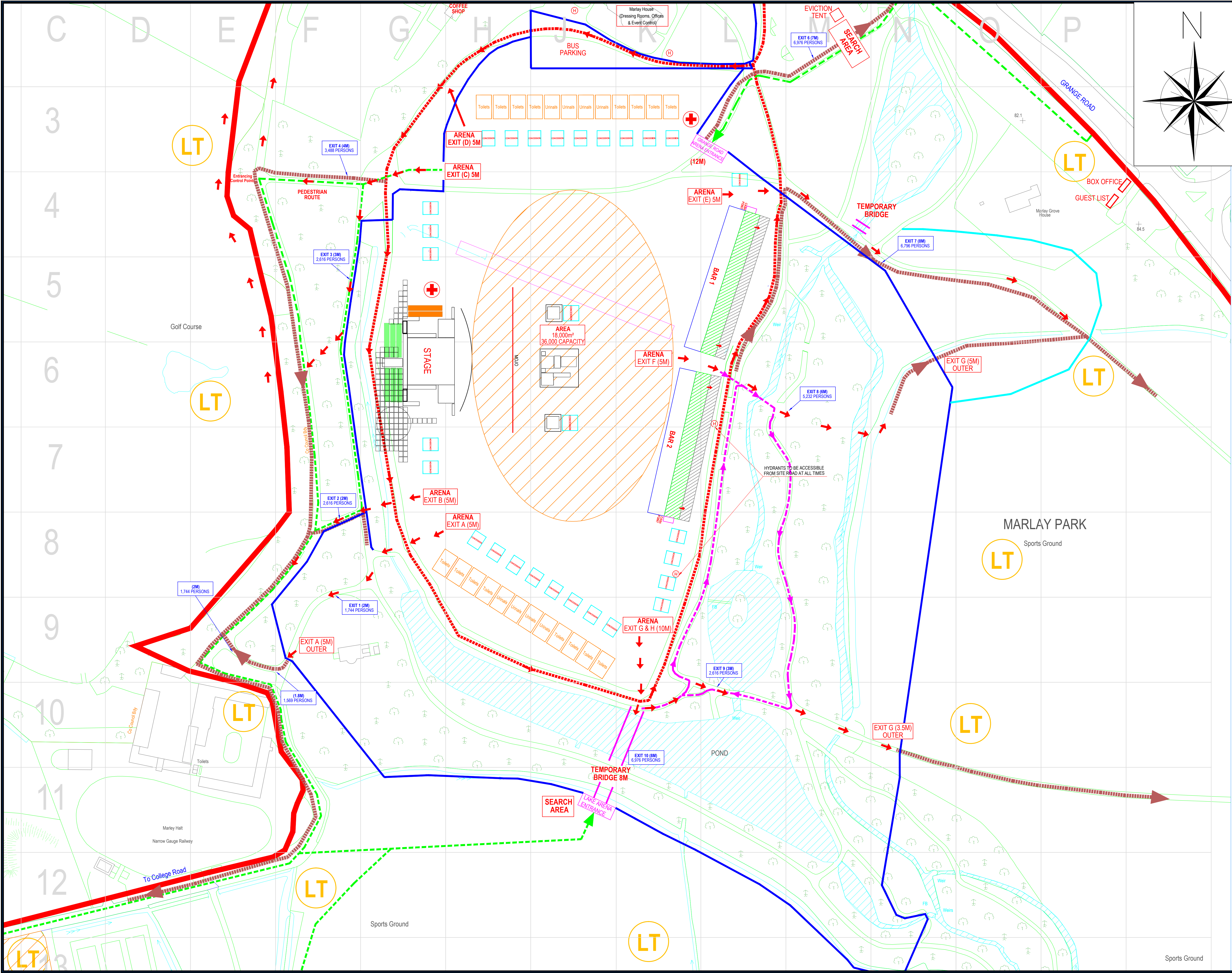

KEY:

Emerg. RL / Site Road	Steelhead Fence	Horse Fence	Stage Sightline
Toilet Block	Concession	First Aid Post	CCTV Camera
Emergency Exit Route	Drinking Water	Fire Hydrant	Water Pipe
Pedestrian Route	Floodlights (Indicative)	Festoon Lit Walkway	Route and Park Exit
Trackway Panels Are 3m Wide And Are Suitable For Carrying a 16.25 Tonne Fire Appliance.			

SITE BOUNDARY

Access to and from the coffee shop will be via the Walled Nursery Garden via the Grange Road.

KEY CONTACTS

Licence Compliance - Ange Goliger Tel: 086 0295820  
Fire Safety Officer - David Slattery Tel: 087 9437787  
Fire Safety Officer - Adrian Sutton Tel: 086 3940225

SCALE 1:1000 (@ A1)  
DRAWING BY  
RICHARD WHITE  
FOR  
MELVIN BENN AND FESTIVAL REPUBLIC

CONTACT: MELVIN BENN  
THE FESTIVAL OFFICE  
BORD GAIS ENERGY THEATRE  
GRAND CANAL SQUARE  
DOCKLANDS, DUBLIN 2

TEL (01) 6742476

GRIDLINES 50M x 50M

REV.	DESCRIPTION	DATE
1	ISSUED FOR TENDERS	13/04/2015
2	REVISED TO REFLECT COMMENTS	13/04/2015
3	REVISED TO REFLECT COMMENTS	13/04/2015
4	REVISED TO REFLECT COMMENTS	13/04/2015
5	REVISED TO REFLECT COMMENTS	13/04/2015
6	REVISED TO REFLECT COMMENTS	13/04/2015
7	REVISED TO REFLECT COMMENTS	13/04/2015
8	REVISED TO REFLECT COMMENTS	13/04/2015
9	REVISED TO REFLECT COMMENTS	13/04/2015
10	REVISED TO REFLECT COMMENTS	13/04/2015
11	REVISED TO REFLECT COMMENTS	13/04/2015
12	REVISED TO REFLECT COMMENTS	13/04/2015
13	REVISED TO REFLECT COMMENTS	13/04/2015
14	REVISED TO REFLECT COMMENTS	13/04/2015
15	REVISED TO REFLECT COMMENTS	13/04/2015
16	REVISED TO REFLECT COMMENTS	13/04/2015
17	REVISED TO REFLECT COMMENTS	13/04/2015
18	REVISED TO REFLECT COMMENTS	13/04/2015
19	REVISED TO REFLECT COMMENTS	13/04/2015
20	REVISED TO REFLECT COMMENTS	13/04/2015
21	REVISED TO REFLECT COMMENTS	13/04/2015
22	REVISED TO REFLECT COMMENTS	13/04/2015
23	REVISED TO REFLECT COMMENTS	13/04/2015
24	REVISED TO REFLECT COMMENTS	13/04/2015
25	REVISED TO REFLECT COMMENTS	13/04/2015
26	REVISED TO REFLECT COMMENTS	13/04/2015
27	REVISED TO REFLECT COMMENTS	13/04/2015
28	REVISED TO REFLECT COMMENTS	13/04/2015
29	REVISED TO REFLECT COMMENTS	13/04/2015
30	REVISED TO REFLECT COMMENTS	13/04/2015
31	REVISED TO REFLECT COMMENTS	13/04/2015
32	REVISED TO REFLECT COMMENTS	13/04/2015
33	REVISED TO REFLECT COMMENTS	13/04/2015
34	REVISED TO REFLECT COMMENTS	13/04/2015
35	REVISED TO REFLECT COMMENTS	13/04/2015
36	REVISED TO REFLECT COMMENTS	13/04/2015
37	REVISED TO REFLECT COMMENTS	13/04/2015
38	REVISED TO REFLECT COMMENTS	13/04/2015
39	REVISED TO REFLECT COMMENTS	13/04/2015
40	REVISED TO REFLECT COMMENTS	13/04/2015
41	REVISED TO REFLECT COMMENTS	13/04/2015
42	REVISED TO REFLECT COMMENTS	13/04/2015
43	REVISED TO REFLECT COMMENTS	13/04/2015
44	REVISED TO REFLECT COMMENTS	13/04/2015
45	REVISED TO REFLECT COMMENTS	13/04/2015
46	REVISED TO REFLECT COMMENTS	13/04/2015
47	REVISED TO REFLECT COMMENTS	13/04/2015
48	REVISED TO REFLECT COMMENTS	13/04/2015
49	REVISED TO REFLECT COMMENTS	13/04/2015
50	REVISED TO REFLECT COMMENTS	13/04/2015
51	REVISED TO REFLECT COMMENTS	13/04/2015
52	REVISED TO REFLECT COMMENTS	13/04/2015
53	REVISED TO REFLECT COMMENTS	13/04/2015
54	REVISED TO REFLECT COMMENTS	13/04/2015
55	REVISED TO REFLECT COMMENTS	13/04/2015
56	REVISED TO REFLECT COMMENTS	13/04/2015
57	REVISED TO REFLECT COMMENTS	13/04/2015
58	REVISED TO REFLECT COMMENTS	13/04/2015
59	REVISED TO REFLECT COMMENTS	13/04/2015
60	REVISED TO REFLECT COMMENTS	13/04/2015
61	REVISED TO REFLECT COMMENTS	13/04/2015
62	REVISED TO REFLECT COMMENTS	13/04/2015
63	REVISED TO REFLECT COMMENTS	13/04/2015
64	REVISED TO REFLECT COMMENTS	13/04/2015
65	REVISED TO REFLECT COMMENTS	13/04/2015
66	REVISED TO REFLECT COMMENTS	13/04/2015
67	REVISED TO REFLECT COMMENTS	13/04/2015
68	REVISED TO REFLECT COMMENTS	13/04/2015
69	REVISED TO REFLECT COMMENTS	13/04/2015
70	REVISED TO REFLECT COMMENTS	13/04/2015
71	REVISED TO REFLECT COMMENTS	13/04/2015
72	REVISED TO REFLECT COMMENTS	13/04/2015
73	REVISED TO REFLECT COMMENTS	13/04/2015
74	REVISED TO REFLECT COMMENTS	13/04/2015
75	REVISED TO REFLECT COMMENTS	13/04/2015
76	REVISED TO REFLECT COMMENTS	13/04/2015
77	REVISED TO REFLECT COMMENTS	13/04/2015
78	REVISED TO REFLECT COMMENTS	13/04/2015
79	REVISED TO REFLECT COMMENTS	13/04/2015
80	REVISED TO REFLECT COMMENTS	13/04/2015
81	REVISED TO REFLECT COMMENTS	13/04/2015
82	REVISED TO REFLECT COMMENTS	13/04/2015
83	REVISED TO REFLECT COMMENTS	13/04/2015
84	REVISED TO REFLECT COMMENTS	13/04/2015
85	REVISED TO REFLECT COMMENTS	13/04/2015
86	REVISED TO REFLECT COMMENTS	13/04/2015
87	REVISED TO REFLECT COMMENTS	13/04/2015
88	REVISED TO REFLECT COMMENTS	13/04/2015
89	REVISED TO REFLECT COMMENTS	13/04/2015
90	REVISED TO REFLECT COMMENTS	13/04/2015
91	REVISED TO REFLECT COMMENTS	13/04/2015
92	REVISED TO REFLECT COMMENTS	13/04/2015
93	REVISED TO REFLECT COMMENTS	13/04/2015
94	REVISED TO REFLECT COMMENTS	13/04/2015
95	REVISED TO REFLECT COMMENTS	13/04/2015
96	REVISED TO REFLECT COMMENTS	13/04/2015
97	REVISED TO REFLECT COMMENTS	13/04/2015
98	REVISED TO REFLECT COMMENTS	13/04/2015
99	REVISED TO REFLECT COMMENTS	13/04/2015
100	REVISED TO REFLECT COMMENTS	13/04/2015