

**KEY:**

Emerg RT / Site Road	Shielded Fence	Hera Fence	Stage Sighting
Toilet Block	Concession	First Aid Post	CCTV Camera
Emergency Exit Route	Drinking Water	Fire Hydrant	Water Pipe
Pedestrian Route	Floodlights (Indicative)	Festoon LT Walkway	Route and Park Exit
Trackway Panels Are 3m Wide And Are Suitable For Carrying a 16.25 Tonne Fire Appliance.			
Existing Ditch to be Covered			Pedestrian Access to Woods

**SITE BOUNDARY**  
 Access to and from the coffee shop will be via the Walled Nursery Garden via the Grange Road.

**KEY CONTACTS**  
 Licence Compliance - Ange Goliger Tel: 086 0295820  
 Fire Safety Officer - David Slattery Tel: 087 9437787  
 Fire Safety Officer - Adrian Sutton Tel: 086 3940225

**DRAFT**

SCALE 1:1500 (@ A1)  
 DRAWING BY  
 RICHARD WHITE  
 FOR  
 MELVIN BENN AND FESTIVAL REPUBLIC

CONTACT: MELVIN BENN  
 THE FESTIVAL OFFICE  
 BORD GAIS ENERGY THEATRE  
 GRAND CANAL SQUARE  
 DOCKLANDS, DUBLIN 2

TEL (01) 6742476  
 GRIDLINES 50M X 50M

Rev.	Description	DATE

**MSA**  
 Michael Slattery Associates  
 Fire Safety Engineers

13 Windsor Place  
 Lower Pembroke Place  
 Dublin 2, Ireland  
 Tel: +353(1)6765713  
 Fax: +353(1)6765242  
 Email: info@msa.ie

Building Design & Construction  
 Fire Engineering  
 Event Safety & Management  
 Disabled Access Consultancy  
 Compliance Monitoring

PROJECT: MARLAY PARK 2016

TITLE	SITE PLAN	JOB No	16025
SCALE	1:1500 @ A1	DATE	21.03.2016
CHECKED BY		DATE	16.02.16



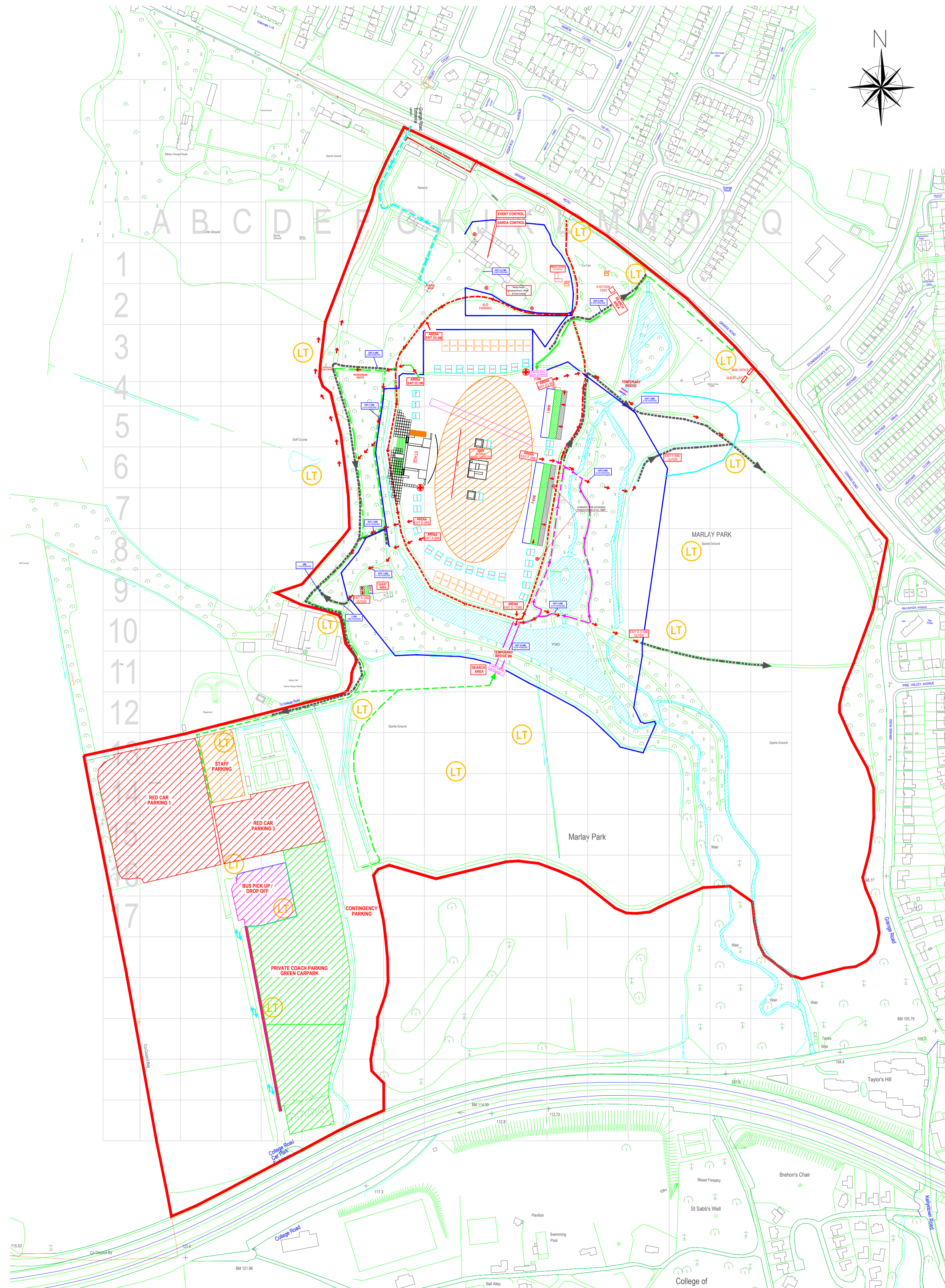

KEY:

Emerg. Rt / Site Road	Steelshield Fence	Heras Fence	Stage Sighline
Toilet Block	Concession	First Aid Post	CCTV Camera
Emergency Exit Route	Drinking Water	Fire Hydrant	Water Pipe
Pedestrian Route	Floodlights (Indicative)	Festoon Lit Walkway	Route and Park Exit
Trackway Panels Are 3m Wide And Are Suitable For Carrying a 16.25 Tonne Fire Appliance.	Water	Entrance Route	
Existing Ditch to be Covered		Pedestrian Access to Woods	

— SITE BOUNDARY  
 - - - Access to and from the coffee shop will be via the Walled Nursery Garden via the Grange Road.

KEY CONTACTS

Licence Compliance - Ange Goliger Tel: 086 0295820  
 Fire Safety Officer - David Slattery Tel: 087 9437787  
 Fire Safety Officer - Adrian Sutton Tel: 086 3940225

**DRAFT**

SCALE 1:2500 (@ A1)  
 DRAWING BY  
 RICHARD WHITE  
 FOR  
 MELVIN BENN AND FESTIVAL REPUBLIC

CONTACT: MELVIN BENN  
 THE FESTIVAL OFFICE  
 BORD GAIS ENERGY THEATRE  
 GRAND CANAL SQUARE  
 DOCKLANDS, DUBLIN 2

TEL (01) 6742476  
 GRIDLINES 50M X 50M

REV	DESCRIPTION	DATE
 <b>Michael Slattery Associates</b> Fire Safety Engineers		
<small>           19 Windsor Place            Lower Pembroke Place            Dublin 2, Ireland            Tel: +353(1)6765713            Fax: +353(1)6785247         </small>		
<small>           &gt; Building Design &amp; Construction            &gt; Fire Engineering Design            &gt; Event Safety &amp; Management            &gt; Building Fire Safety Management            &gt; Disabled Access Consultancy            &gt; Computer Modelling         </small>		
PROJECT: MARLAY PARK 2016		
TITLE: SITE LOCATION		
SCALE: 1:2500 @ A1	JOB NO: 16025	
DATE: 21.03.2016	DWG NO: 16025-02	
CHECKED BY:	REV:	



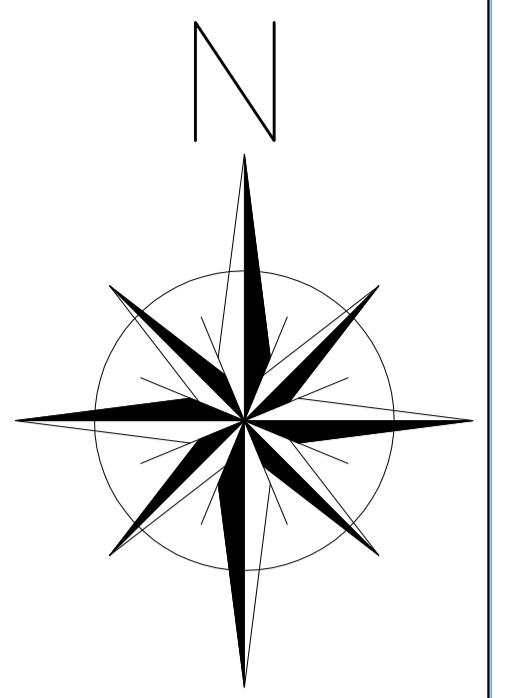
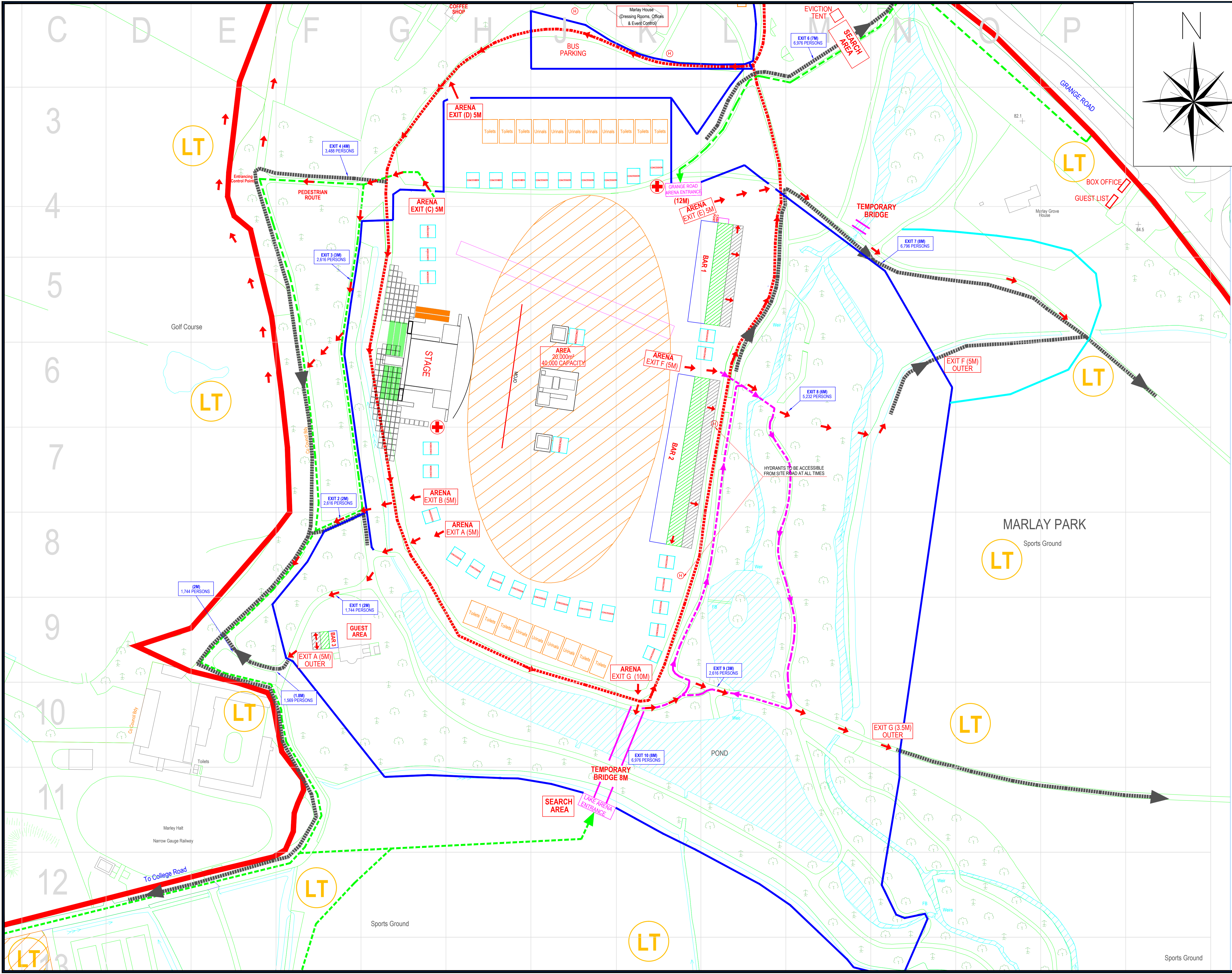

**KEY:**

Emerg RT / Site Road	Steelshield Fence	Hedge Fence	Stage Sighting
Toilet Block	Concession	First Aid Post	CCTV Camera
Emergency Exit Route	Drinking Water	Fire Hydrant	Water Pipe
Pedestrian Route	Floodlights (Indicative)	Festoon LT Walkway	Route and Park Exit
Trackway Panels Are 3m Wide And Are Suitable For Carrying a 16.25 Tonne Fire Appliance.	Water	Entrance Route	
Existing Ditch to be Covered		Pedestrian Access to Woods	

**KEY CONTACTS**  
 Licence Compliance - Ange Golliger Tel: 086 0295820  
 Fire Safety Officer - David Slattery Tel: 087 9437787  
 Fire Safety Officer - Adrian Sutton Tel: 086 3940225

**DRAFT**

SCALE 1:1000 (@ A1)  
 DRAWING BY  
 RICHARD WHITE  
 FOR  
 MELVIN BENN AND FESTIVAL REPUBLIC

CONTACT: MELVIN BENN  
 THE FESTIVAL OFFICE  
 BORD GAIS ENERGY THEATRE  
 GRAND CANAL SQUARE  
 DOCKLANDS, DUBLIN 2

TEL (01) 6742476  
 GRIDLINES 50M x 50M

Rev.	Description	DATE

**Michael Slattery Associates**  
 Fire Safety Engineers

13 Windsor Place  
 Lower Pembroke Place  
 Dublin 2, Ireland  
 Tel: +353 (1) 765713  
 Fax: +353 (1) 7657347

Building Design & Construction  
 Fire Engineering  
 Fire Safety & Management  
 Building Fire Safety Management  
 Disabled Access Consultancy  
 Computer Modelling

PROJECT: MARLAY PARK 2016

TITLE	ARENA
SCALE	1:1000 @ A1
DATE	21.03.2016
CHECKED BY	Rev
JOB No	16025
Draw No	16025-05