

***PROPOSED TRAFFIC
MANAGEMENT SCHEME***

for

TMP for Leopardstown Biggest Disco

2024

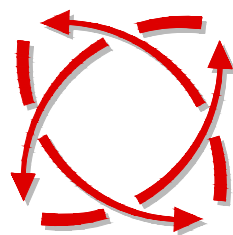

***FREEFLOW
TRAFFIC
MANAGEMENT***

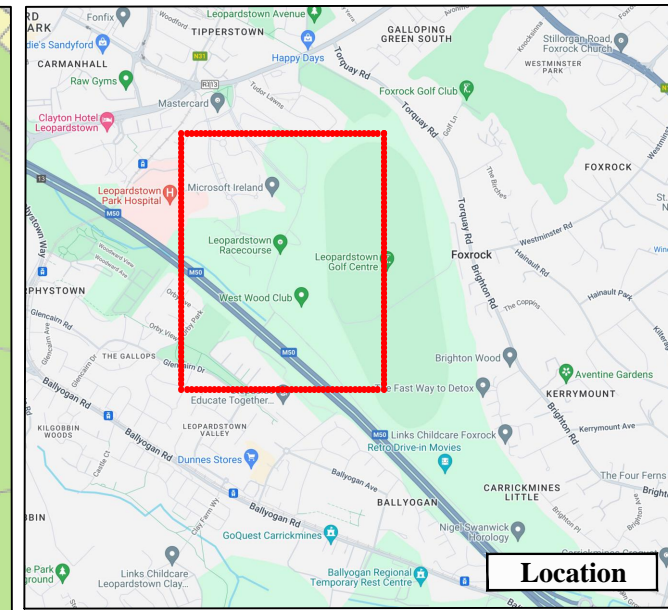
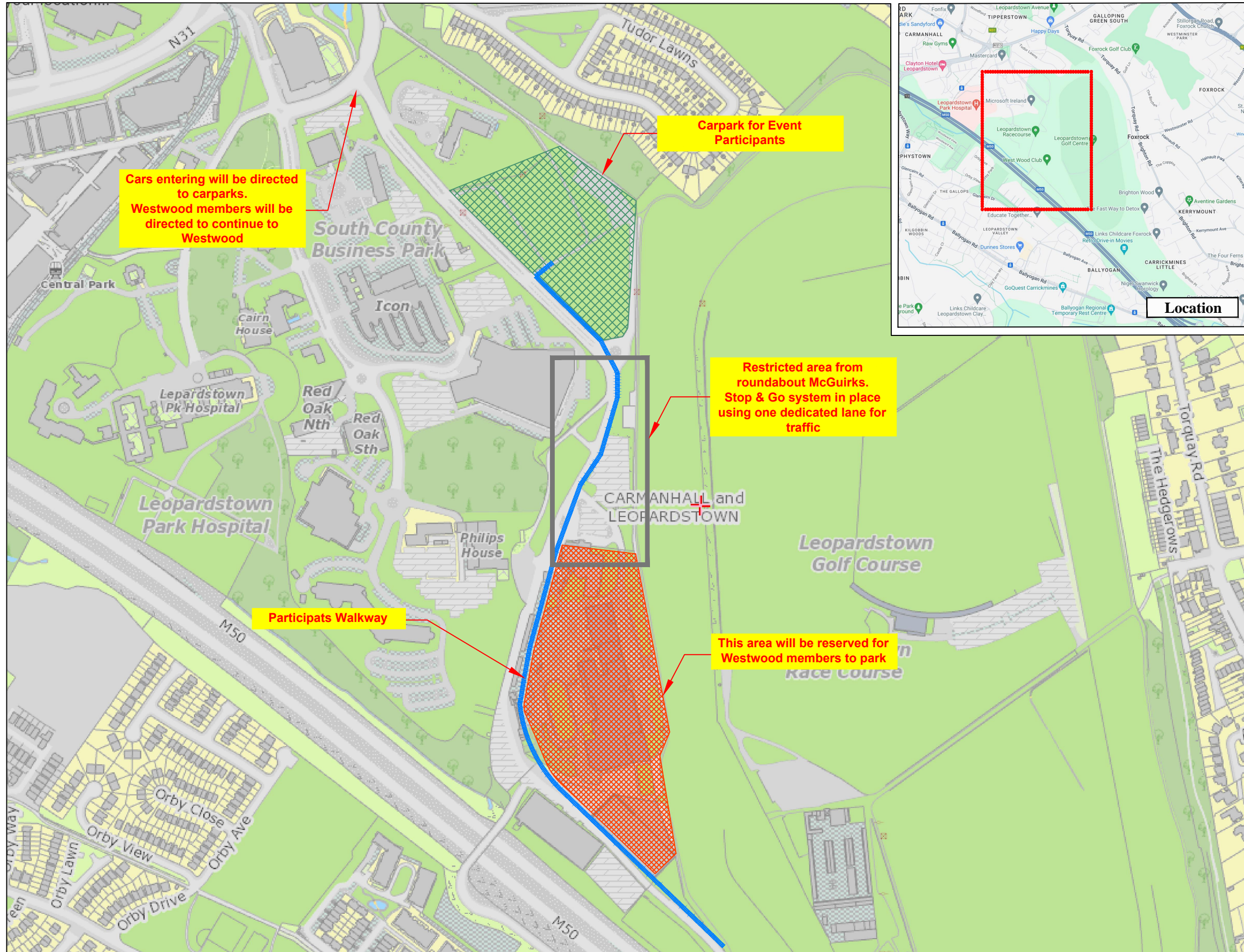

LEGEND

- Participants Walkway
- Participants Carpark
- Westwood Members Carpark

Works TTM type:	Static Type A				
Design Parameters:	Design Type A: >12h				
	LV-1 (I)	LV-1 (III)	LV-1 (IV)	LV-2 (I)	LV-2 (II)
1. Minimum Sign Size mm	450	600	600	800	750
2. Statutory Speed of the Road	30km/h	50	60	80	100
3. Distance between Advance Signs	10m	20m	20m	120m	200m
4. Number of Advance Signs	1 (<12h) 2 (>12h)	2	3 (<12h) 2 (>12h)	3 (<12h) 4 (>12h)	3 (<12h) 4 (>12h)
5. Minimum Visibility of Signs	25m	50m	60m	90m	120m
6. Longitudinal Safety Zone	0.5m	5m	15m	45m	60m
7. Lateral Safety Zone	0.5m	0.5m	1.2m	1.2m	1.2m
8. Leading Taper	1in1m	1in5m	1in10m	1in40	1in100
9. Maximum at Tapers Cone Space	1m	3m	3m	3m	3m
10. Maximum Longitudinal Cone Space	3m	3m	6m	12m	12m
11. Lane Width (m)	2.5m	3 (2.5)	3 (2.5)	3 m	3 m
12. Two-way Roadway width (m)	5m	5m	5m	-	-

Note:

- All signs to comply with Chapter 8 of the "Traffic Signs Manual"-Guidance Document-2019.
- All Traffic Management to be carried out in accordance with Chapter 8 of the "Traffic Signs Manual".
- Detailed Risk Assessment to be carried out prior to the installation of Traffic Management System.
- Exact sign positions to be agreed on site.
- All affected Parties and An Garda Siochana to be notified prior to works commencing.
- Signs to be positioned so as not to cause an obstruction to other road users.
- All signs to be faced with retro-reflective material to class ref 2 of EN 12899.
- "End of Roadworks" sign placed 20m to 50m from end of works area.



Rev:	Description:	Date:	Job Details: Proposed Traffic Management Plan for TMP for Leopardstown Biggest Disco 2024	Drawing: TMP for Event Parkings	Dwg no: 01
					Rev:
			Sheet:	CAD File ref.:	Drawn By: DM
				Date: March 2024	Scale: As Shown

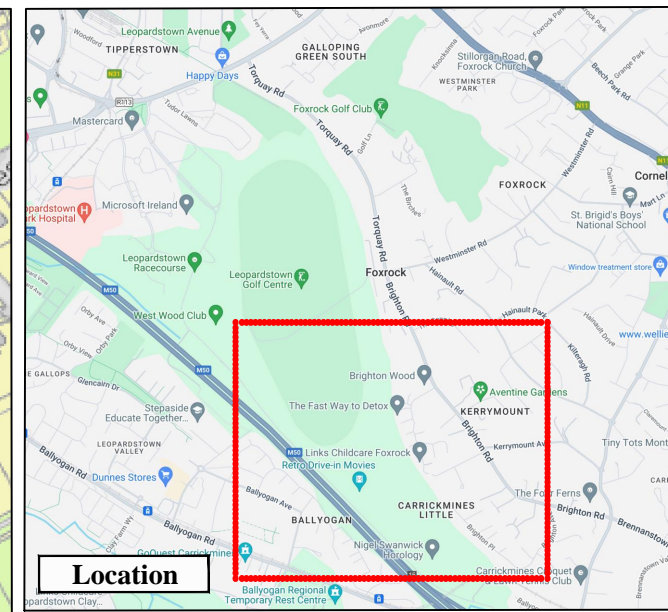
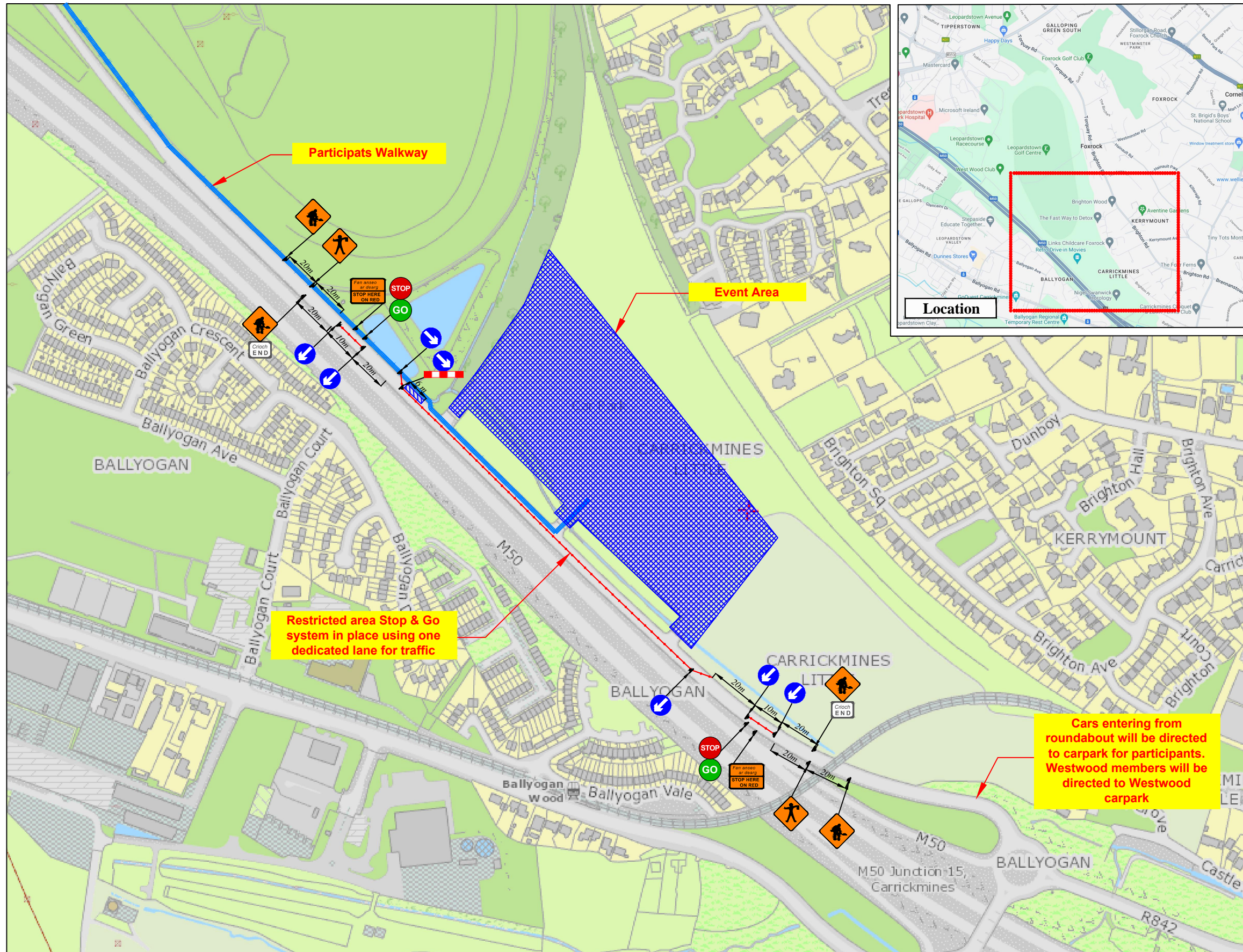

LEGEND

- Participants Walkway
- Participants Carpark
- Westwood Members Carpark
- Traffic Cones
- Longitudinal Safety Zone
- Event Area

Works TTM type:	Static Type A				
Design Parameters:	Design Type A: >12h				
	LV-1 (I)	LV-1 (III)	LV-1 (IV)	LV-2 (I)	LV-2 (II)
1. Minimum Sign Size mm	450	600	600	600	750
2. Statutory Speed of the Road	30km/h	50	60	80	100
3. Distance between Advance Signs	10m	20m	20m	120m	200m
4. Number of Advance Signs	1 (<12h) 2 (>12h)	2	3 (<12h) 2 (>12h)	3 (<12h) 4 (>12h)	3 (<12h) 4 (>12h)
5. Minimum Visibility of Signs	25m	50m	60m	90m	120m
6. Longitudinal Safety Zone	0.5m	5m	15m	45m	60m
7. Lateral Safety Zone	0.5m	0.5m	0.5m	1.2m	1.2m
8. Leading Taper	1in1m	1in5m	1in10m	1in40	
9. Maximum at Tapers Cone Space	1m	3m	3m	3m	3m
10. Maximum Longitudinal Cone Space	3m	3m	6m	12m	12m
11. Lane Width (m)	2.5m	3 (2.5)	3 (2.5)	3 m	3 m
12. Two-way Roadway width (m)	5m	5m	5m	-	-

- Note:**
- All signs to comply with Chapter 8 of the "Traffic Signs Manual"-Guidance Document-2019.
 - All Traffic Management to be carried out in accordance with Chapter 8 of the "Traffic Signs Manual".
 - Detailed Risk Assessment to be carried out prior to the installation of Traffic Management System.
 - Exact sign positions to be agreed on site.
 - All affected Parties and An Garda Siochana to be notified prior to works commencing.
 - Signs to be positioned so as not to cause an obstruction to other road users.
 - All signs to be faced with retro-reflective material to class ref 2 of EN 12899.
 - "End of Roadworks" sign placed 20m to 50m from end of works area.



Rev:	Description:	Date:

Job Details: Proposed Traffic Management Plan for TMP for Leopardstown Biggest Disco 2024	
Sheet:	CAD File ref.:

Drawing: TMP for Event Area	
Drawn By: DM	Date: March 2024

Dwg no: 02
Rev:
Scale: As Shown