

Site Location Map
1 : 500

Notes:
- Do not scale from this drawing. Use figured dimensions in all cases.
- Verify dimensions on site and report any discrepancies to the Architect immediately.
- This drawing is to be read in conjunction with the Architect's Specification.
- © This drawing is copyright and may only be reproduced with the Architect's permission.

Drawing Notes:
OSi Licence No. CYAL50273835
Map Sheets Ref: 3329-17
Centre Coordinates: 716940, 730049

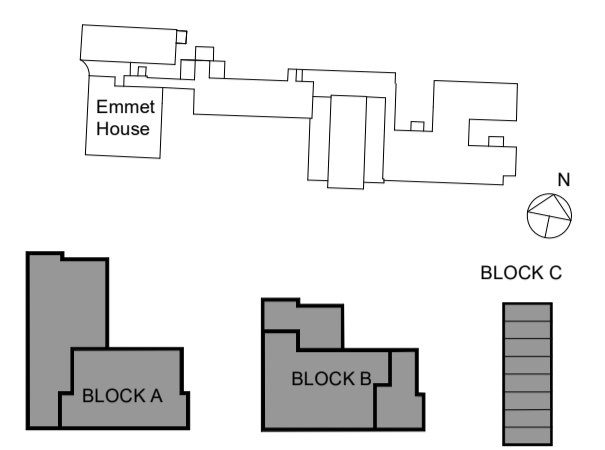

- Site Boundary Line
- Site Ownership Line
- Wayleave /ROW (Right of Way)

| | | | |
|--------|----------|-------|-----------------------------|
| P3 S-2 | Feb 2025 | BG | Planning Application |
| P3 S-1 | Oct 2024 | BG | Pre-Planning Application |
| Rev. | Date | Drawn | Details of Issue / Revision |

Issues & Revisions



Darity Mills,
 Darity Road
 Dublin 6,
 D06 Y0E3

T: +353 (0)1 498 7000
 W: www.reddyarchitecture.com
 E: info@reddyarchitecture.com

Applicant Details:
Dún Laoghaire-Rathdown County Council

Project Details:
Proposed Residential Development,
Mount Saint Mary's, Dundrum Road, Dublin 14

Drawing Title:
Site Location Map, Existing

| | | |
|-----------------|--------------|--------------|
| Job No. | Sheet Size: | Scale @A1: |
| P23-129D | A1 Landscape | As indicated |
| Issue Date: | Drawn By: | Reviewed By: |
| Mar 2025 | B. Gil | R. Quinn |

Status: **P3** Purpose of Issue: **Planning Application**

Project-Originator-Zone-Level-Type-Role-Classification-Number
MSM-02-SW-ZZZ-DR-RAU-AR-1000 P3 S-2