



Proposed Site Plan
1: 500

Notes:
 - Do not scale from this drawing. Use figured dimensions in all cases.
 - Verify dimensions on site and report any discrepancies to the Architect immediately.
 - This drawing is to be read in conjunction with the Architect's Specification.
 - © This drawing is copyright and may only be reproduced with the Architect's permission.

Drawing Notes:

OSi Licence No. AR 0052220
 Map Sheets Ref: 3329-17

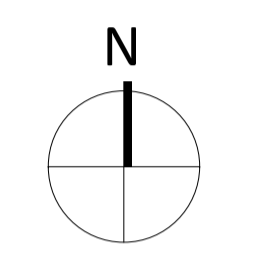
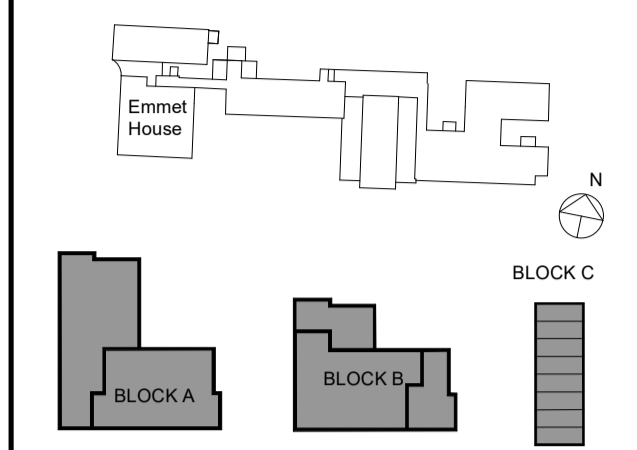

- Site Boundary Line
- Site Ownership Line
- Wayleave /ROW (Right of Way)

- ▲ Residential Entrance
- ▲ Services access
- ▲ Site access

| Rev. | Date | Drawn | Details of Issue / Revision |
|--------|----------|-------|-----------------------------|
| P3 S-2 | Mar 2025 | BG | Issued for Information |
| P3 S-1 | Oct 2024 | BG | Pre-Planning Application |

reddy architecture
+urbanism

Dartly Mills,
Dartly Road
Dublin 6,
D06 Y0E3

T: +353 (0)1 498 7000
W: www.reddyarchitecture.com
E: info@reddyarchitecture.com

Applicant Details:
Dún Laoghaire-Rathdown County Council

Project Details:
**Proposed Residential Development,
 Mount Saint Mary's, Dundrum Road, Dublin 14**

Drawing Title:
Site Plan, Proposed

| | | |
|----------------------------|-----------------------------|----------------------------|
| Job No. P23-129D | Sheet Size: A1 Landscape | Scale @A1: As indicated |
| Issue Date: Mar 2025 | Drawn By: B. Gil | Reviewed By: R. Quinn |

| | |
|---|--|
| Status: P3 | Purpose of Issue: Planning Application |
| Project-Originator-Zone-Level-Type-Role-Classification-Number | |
| MSM-02-SW-ZZZ-DR-RAU-AR-1004 | P3 S-2 |