



LEGEND

TREE IMPACT CATEGORIES

-  TREES FOR RETENTION
-  TREES TO BE REMOVED TO FACILITATE DEVELOPMENT
-  TREES TO BE REMOVED DUE TO CONDITION
-  HEDGE / VEGETATION TO BE RETAINED
-  HEDGE / VEGETATION TO BE REMOVED

DRAWING TO BE INTERPRETED WITH REFERENCE TO TREE SURVEY DOCUMENT
 NOTE: THIS DRAWING WAS ORIGINALLY PRODUCED IN COLOUR WHICH IS ESSENTIAL TO THE PLAN'S INTERPRETATION AND USE. MONOCHROME COPIES SHOULD NOT BE RELIED UPON.
 TOTAL TREES IDENTIFIED FOR REMOVAL: 9
 TOTAL TREES TO BE RETAINED: 6

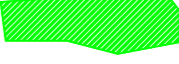
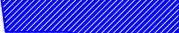
TREE #691 IS UNLIKELY TO HAVE ROOTS IMPACTED BY PROPOSED PARKING SPACES DUE TO SLOPE OF TERRAIN. REFER TO TREE PROTECTION DRAWING AND METHOD STATEMENT FOR FURTHER INFORMATION.

MOTORWAY SCREEN PLANTING UNAFFECTED

MOTORWAY SCREEN PLANTING UNAFFECTED

SCRUB VEGETATION TO BE RETAINED: APPROX. 800M2

SCRUB VEGETATION TO BE REMOVED: APPROX. 580M2

HEDGE 4 - TO BE REMOVED

LEOPARDSTOWN ROAD

HEDGE 2 - MAY BE LARGELY RETAINED WITH SOME REMOVAL OF MINOR SECTION AT CLOSE CORNER OF BIKE SHED.

HEDGE 3 - TO BE REMOVED

HEDGE 1 - TO BE RETAINED

LEOPARDSTOWN RISE

LEOPARDSTOWN RISE

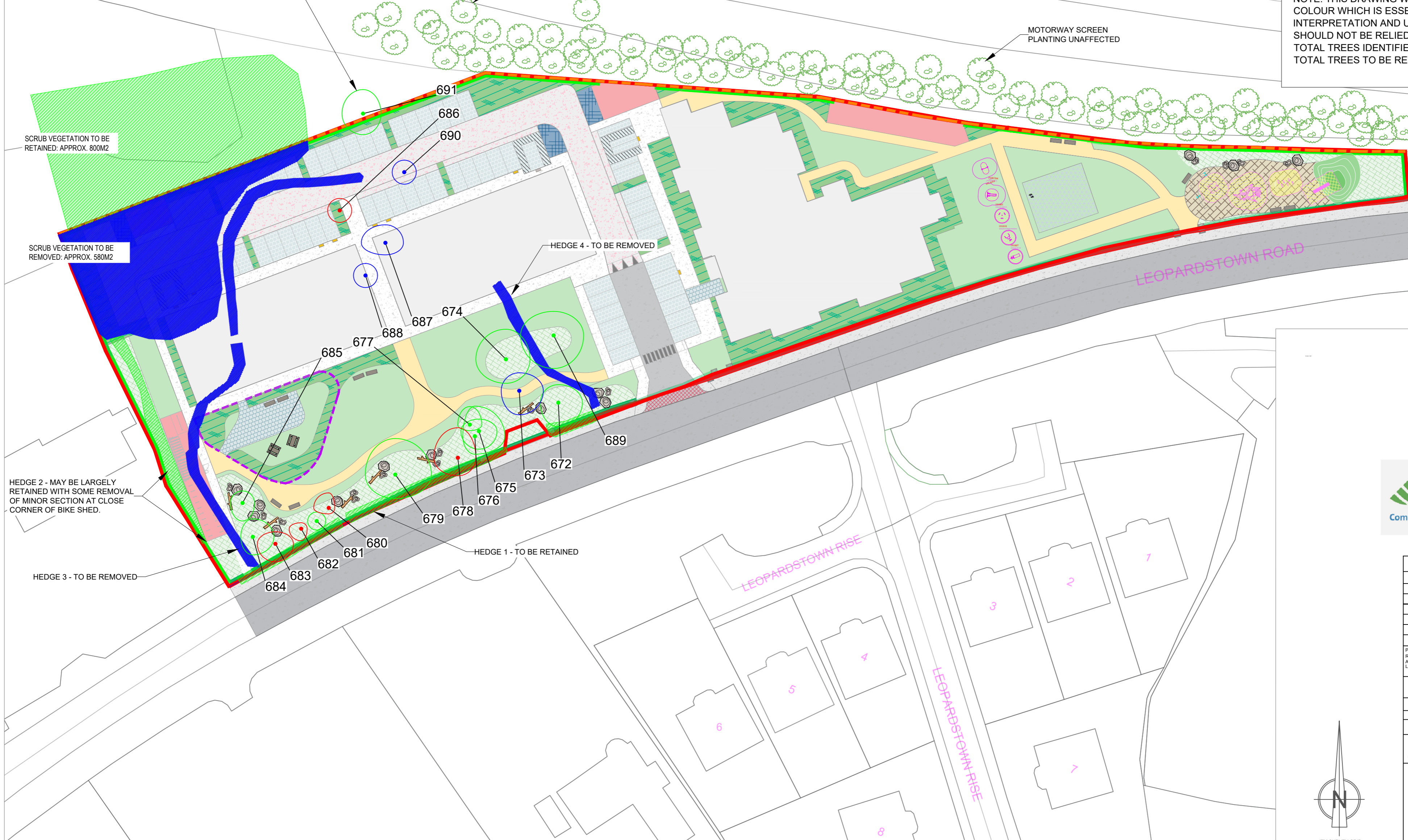

REV	DATE	COMMENT
	04/10/24	FOR REVIEW AND COMMENT
A	22/10/24	UPDATE TO LAYOUT
B	07/02/25	UPDATE TO LAYOUT

PROJECT: RESIDENTIAL DEVELOPMENT AT LEOPARDSTOWN ROAD, LEOPARDSTOWN, DUBLIN	JOB NO. TWIL003
DRAWING: IMPACT ASSESSMENT	SCALE: 1:500 @A2
DRAWN BY: LAUREN MCCOLGAN	DATE: 07/02/25
STATUS: PLANNING	
DRAWING NO. 002	DRAWING NAME: TWIL003-00-DR-CMK-AR8-002

NOTES:
 1. All drawings are for information only.
 2. All drawings are for information only.
 3. All drawings are for information only.
 (c) THE DRAWING IS COPYRIGHT OF CMK URBAN FORESTRY CONSULTANTS LTD.

