

ISO A1 594mm x 841mm
Checked: ROSS LOUGHNANE Approved: ED FRAMPTON
Designer: DAVID GALLAGHER
Project Management Initials:
Last saved by: CULLETONK(2022.03.14), Last Plotted: 2022.03.14
Filename: Z:\UK\IEDBL2\LOGS\PR-402643_CHERRYWOOD_GREEN_NETWORK\K1000_CAD_GIS\910_CAD\05-MODELS\GREENWAY_LASHEETS\K02643-SHT-20-L-1000.DWG

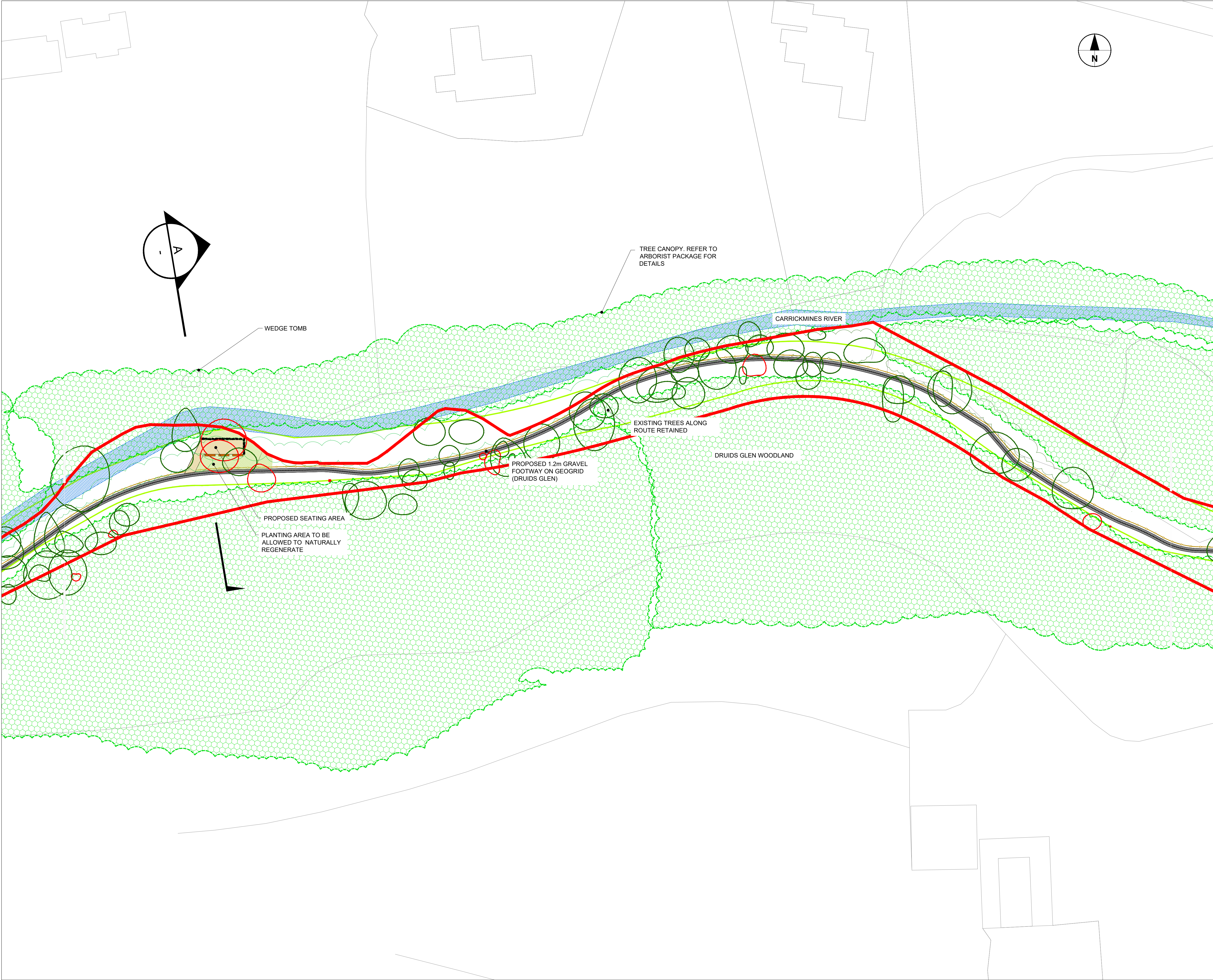

PROJECT

CHERRYWOOD
GREEN ROUTES
NETWORK

CLIENT



CONSULTANT

AECOM Ireland Limited
24 Lower Hatch Street
Dublin 2, D02 TY88
01 676 3671 tel
www.aecom.com/ie

KEY

- EXISTING SPECIMEN TREES RETAINED
- EXISTING SPECIMEN TREES REMOVED
- EXISTING WOODLAND RETAINED
- EXISTING VEGETATION TRIMMED/REMOVED
- EXISTING GRASSLAND RETAINED
- PROPOSED TREES
 - PROPOSED SPECIMEN TREES
 - PROPOSED FEATURE TREES
- PROPOSED SOFTWORKS:
 - PROPOSED GRASSLAND PLANTING
 - AREAS TO REGENERATE
 - MOWN STRIP ALONG GREENWAY
 - PROPOSED WOODLAND PLANTING
- PROPOSED HARDWORKS:
 - ASPHALT TO GREENWAY
 - RESIN BOUND GRAVEL
 - LOOSE BOUND GRAVEL ON GEOCELLS
 - SMALL UNIT PAVING BAND TO ACCESS POINT
- PROPOSED FURNITURE:
 - SEATING TO BENCH HAVEN
 - CYCLE STAND TO BENCH HAVEN
 - WAYFINDING SIGNAGE TO ACCESS POINT
- OTHER
 - CHERRYWOOD SDZ PLANNING SCHEME
 - GREEN INFRASTRUCTURE ZONED LANDS

ISSUE/REVISION

I/R		DATE	DESCRIPTION
-	March 2022	ISSUE FOR PART 8	

PROJECT NUMBER

60599677

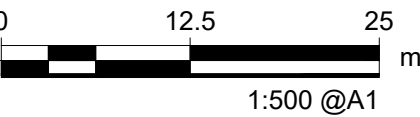

SHEET TITLE

GENERAL ARRANGEMENT PLAN
Sheet 2 of 11

SHEET NUMBER

60599677-SHT-20-L-1002

This drawing has been prepared for the use of AECOM's client. It may not be used, modified, reproduced or relied upon by third parties, except as agreed by AECOM or as required by law. AECOM accepts no responsibility, and denies any liability whatsoever, to any party that uses or relies on this drawing without AECOM's express written consent. Do not scale this document. All measurements must be obtained from the stated dimensions.