



AECOM
 Adelphi Plaza
 George's Street Upper
 Dun Laoghaire Co.Dublin
 Tel:+353(0)1 2383100 Fax:+353(0)1 2383199
 www.aecom.com

NOTES

1. THIS DRAWING IS TO BE READ IN CONJUNCTION WITH ALL OTHER RELEVANT ENGINEERING DRAWINGS. ANY DISCREPANCIES, ERRORS OR OMISSIONS TO BE BROUGHT TO THE ATTENTION OF THE DESIGNER.
2. THE LOCATION AND DEPTH OF SERVICES TO BE CHECKED ON SITE PRIOR TO COMMENCING ANY WORKS. NO WARRANTY GIVEN AS TO THE ACCURACY OF THE INFORMATION PROVIDED.
3. THE EMPLOYERS REPRESENTATIVE IS TO BE INFORMED BY THE CONTRACTOR OF ANY DISCREPANCIES PRIOR TO COMMENCEMENT OF WORKS ON SITE.
4. DO NOT SCALE. ALL MEASUREMENTS AND COORDINATES TO BE CHECKED ON SITE.
5. LOCATIONS OF EXISTING SERVICES ARE INDICATIVE ONLY. THE CONTRACTOR MUST LIAISE WITH EACH UTILITY PROVIDER THROUGHOUT THE WORKS.

LEGEND:

- EXISTING LEVEL
- PROPOSED LEVEL
- THIRD PARTY ADJOINING DEVELOPMENT LEVELS

ISSUE/REVISION

I/R	DATE	DESCRIPTION
A	MARCH 2022	ISSUED FOR PART 8

KEY PLAN

PROJECT NUMBER

60599677

SHEET TITLE

PROPOSED LONGITUDINAL SECTIONS
 ALIGNMENT No. 11, 12 & 13
 SHEET 1 OF 1

SHEET NUMBER

60599677_SHT_162.8

ALIGNMENT 11 - LONGSECTION
 SCALE: H 1:500,V 1:100. DATUM: 20.000

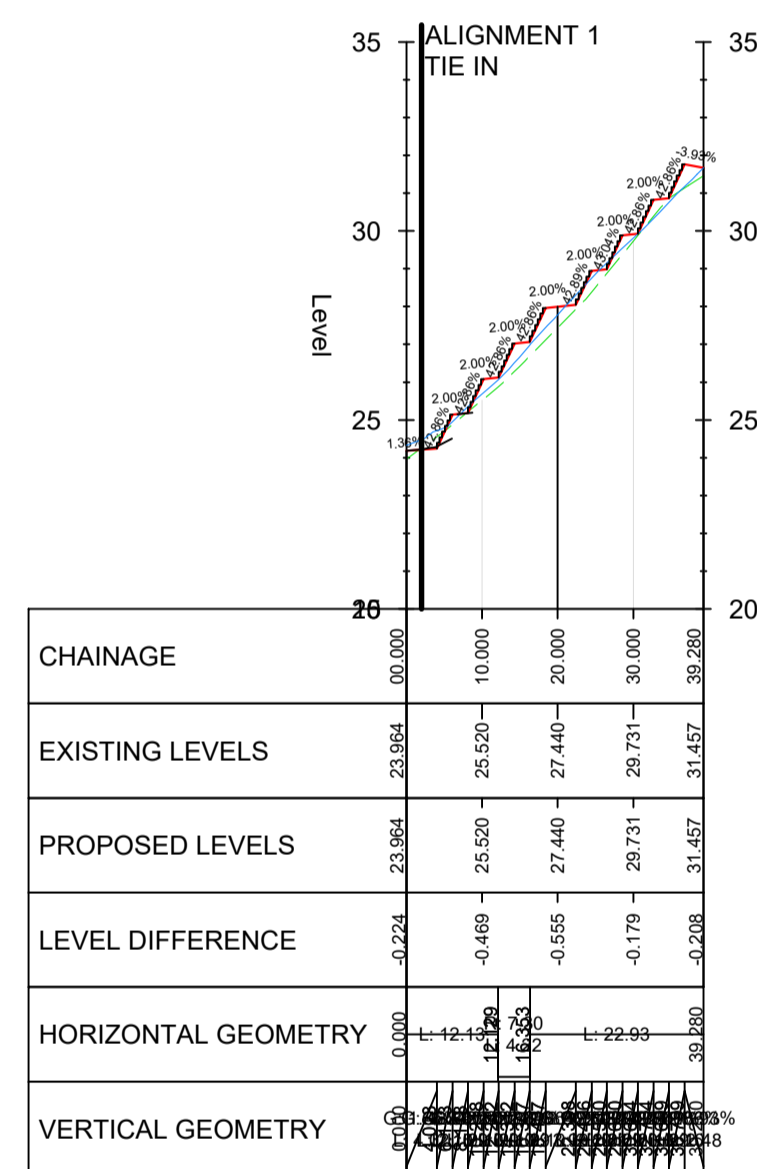

ALIGNMENT 12 - LONGSECTION
 SCALE: H 1:500,V 1:100. DATUM: 20.000

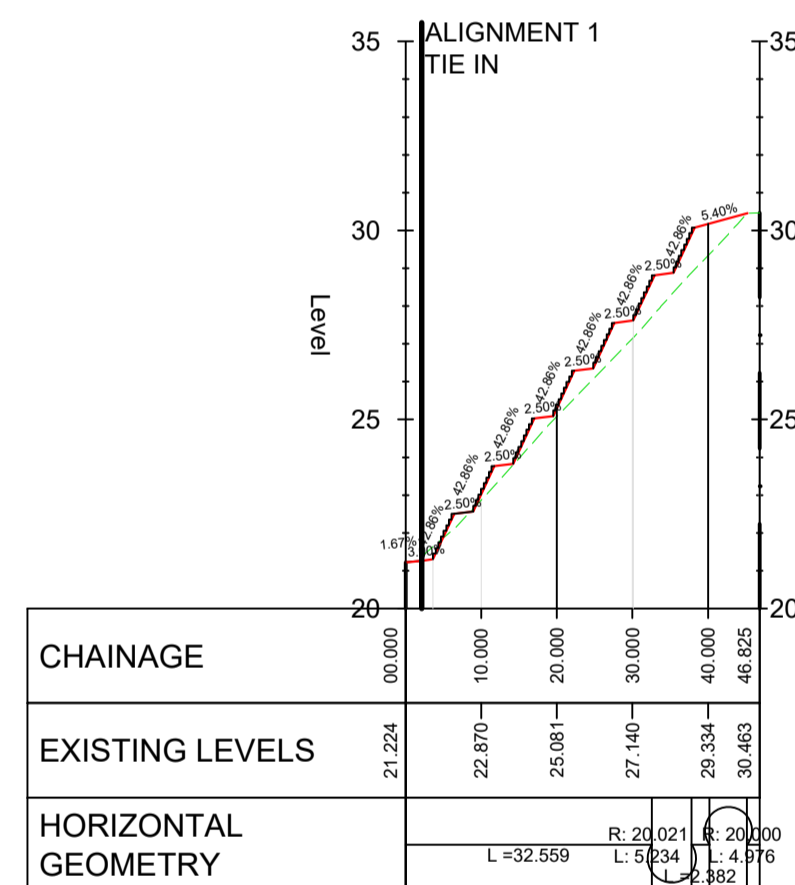

ALIGNMENT 13 - LONGSECTION
 SCALE: H 1:500,V 1:100. DATUM: 20.000

