

PROPOSED FUTURE LAYOUT OF BLACKTHORN DRIVE JUNCTION, ONCE BRACKEN LINK ROAD IS IN PLACE.

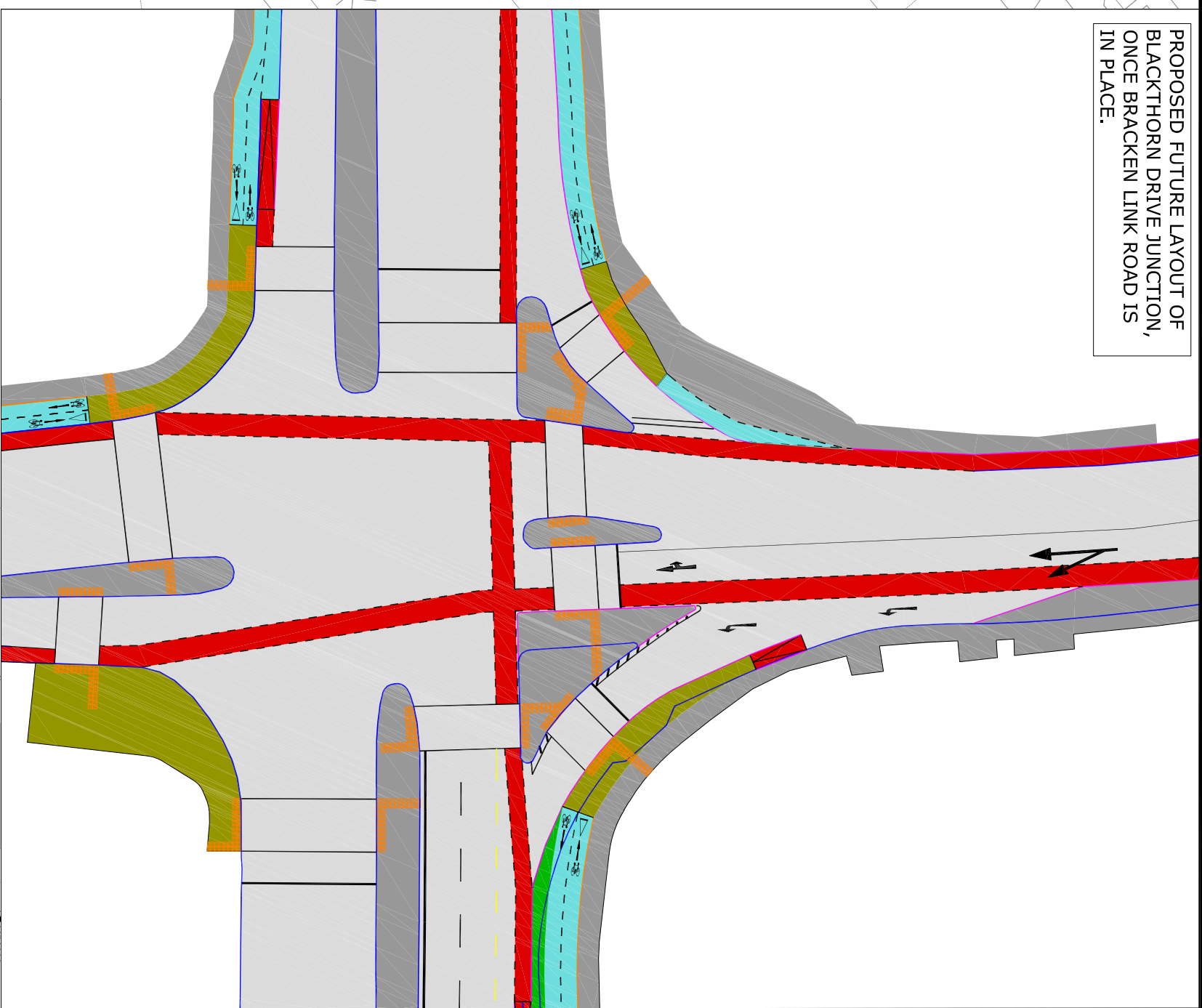

# SANDYFORD CYCLE ROUTE (KILGOBBIN/DRUMMARTIN LINK ROAD)

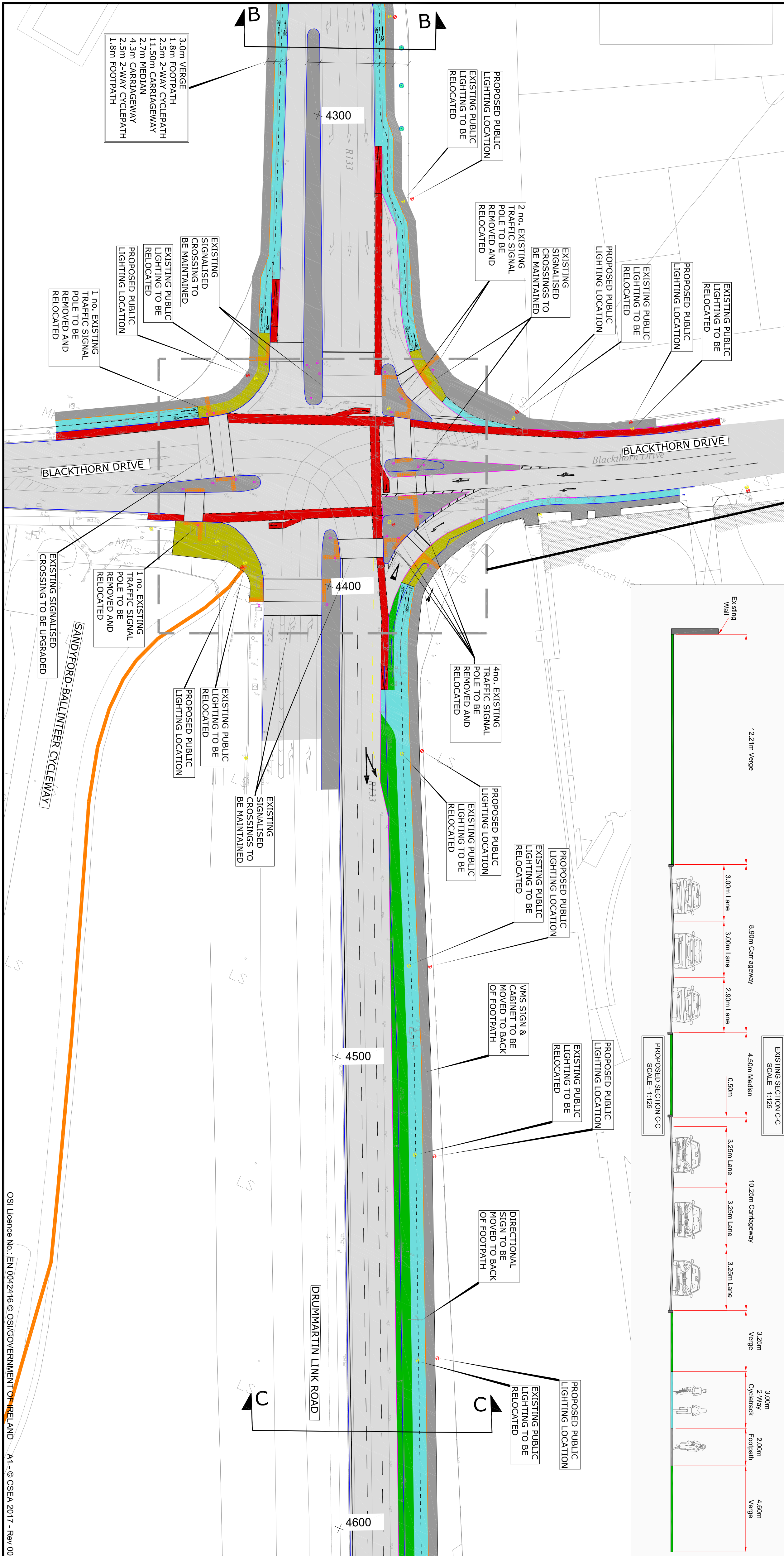
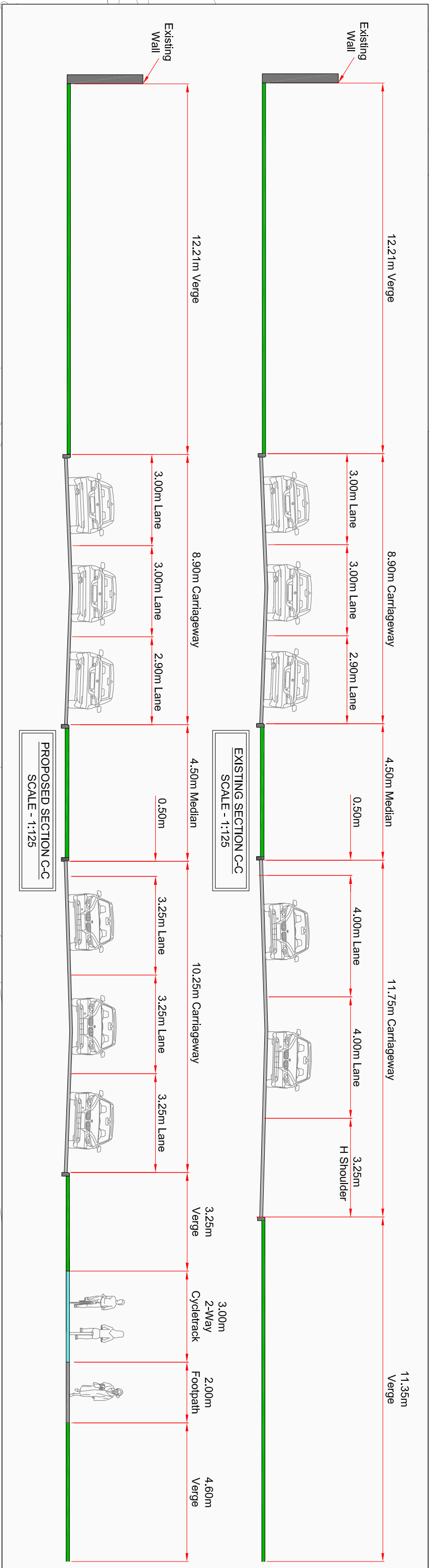
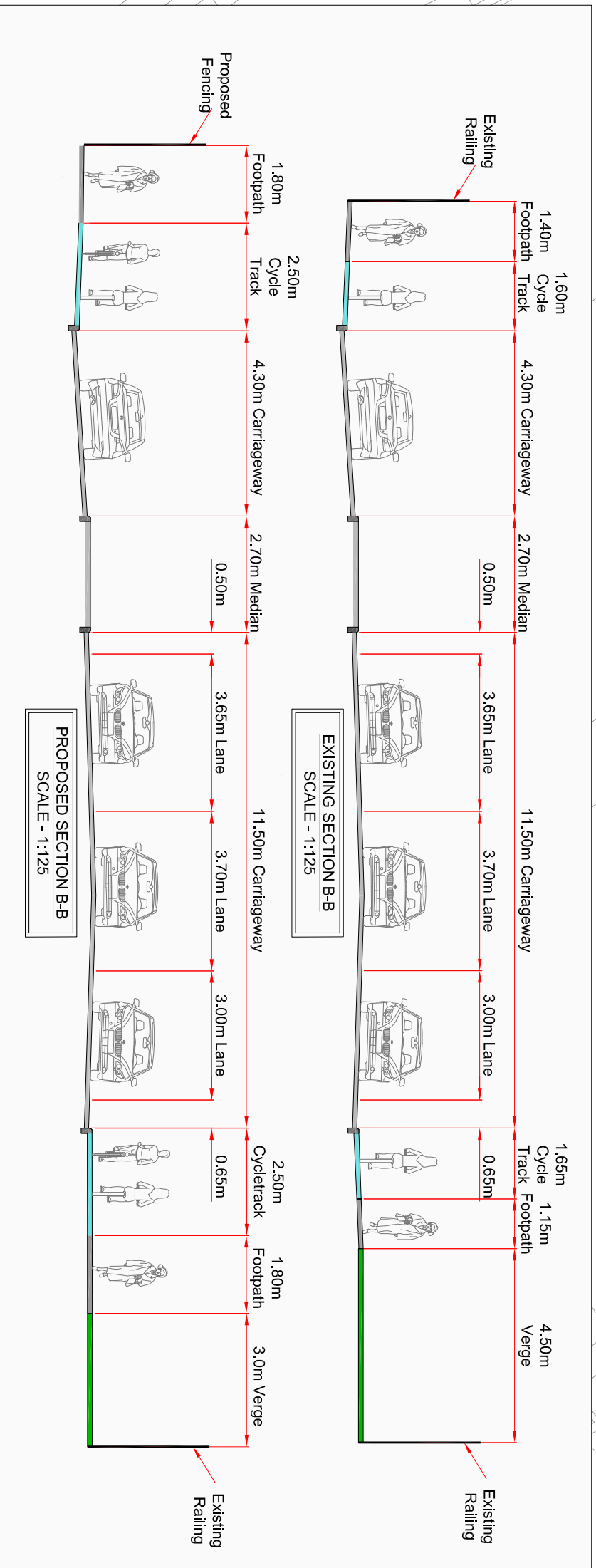

This drawing is produced using the Irish Transverse Mercator (ITM) Geographic Coordinate System

A1

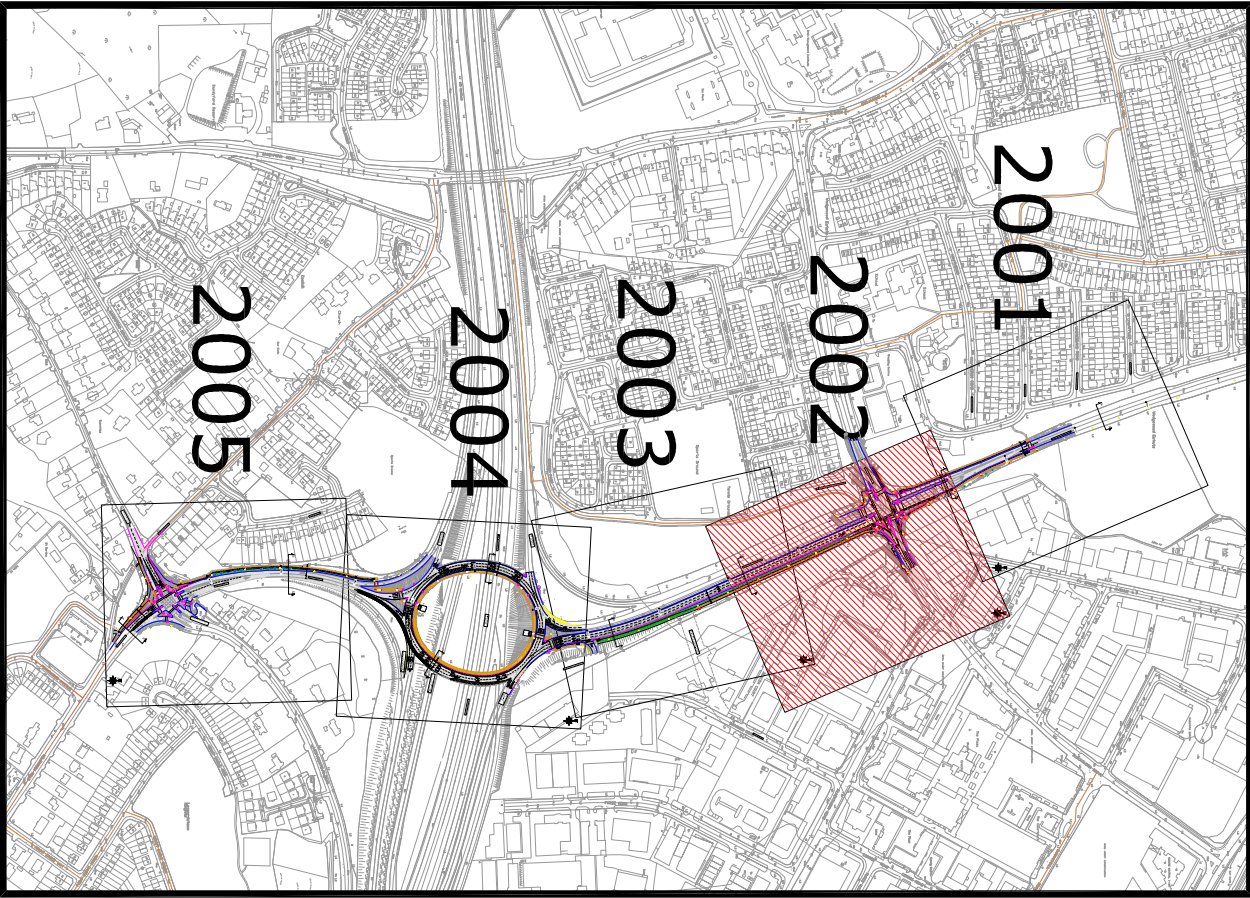

Key Plan  
NTS

LEGEND:	
PROPOSED KERBLINE	
PROPOSED 50mm KERB BETWEEN CYCLETRACK AND FOOTPATH	
PROPOSED TACTILE PAVING	
PROPOSED KASSEL KERBLINE	
PROPOSED RAISED CYCLETRACK	
PROPOSED MANDATORY CYCLELANE ON ROAD CYCLELANE CONFLICT AREA WITH VEHICULAR TRAFFIC	
PROPOSED SHARED CYCLE AND PEDESTRIAN AREA	
PROPOSED BUS LANE / STOP	
PROPOSED RAISED PLATFORM / TABLE	
PROPOSED RAISED PARKING	
PROPOSED RAISED TAXI RANK	
PROPOSED AREA OF CARRIAGEWAY WITH ARCHITECTURAL FINISHES	
PROPOSED LANDSCAPING	
PROPOSED CARRIAGEWAY	
PROPOSED FOOTPATH	
LOW TRAFFICKED ROUTES	
EXISTING TREES TO BE RETAINED	
EXISTING TREE TO BE REMOVED	
EXISTING/PROPOSED PUBLIC LIGHTING	

Revision	Description	Initials	Date
P04	DRAFT ISSUE	MR	25/01/2018
P03	DRAFT ISSUE	MR	28/11/2017
P02	DRAFT ISSUE	MR	11/10/2017
P01	DRAFT ISSUE	MR	27/09/2017
P00	DRAFT ISSUE	MR	05/07/2017

Clifton Scannell Emerson  
Associates



Clifton Scannell Emerson  
Associates Limited  
Consulting Engineers,  
Seafort Lodge,  
Castledawson Avenue,  
Blackrock, Co. Dublin,  
Ireland.  
T. +353 1 288 8006  
F. +353 1 283 3466  
E. info@cseal.ie  
W. www.cseal.ie

Dun Laoghaire Rathdown  
County Council

Sandyford Cycle Route  
(Kilgobbin / Drummartin Link Road)  
Preferred Option - Proposed Layout  
Sheet 02 of 05

Drawn By: MR  
Date: 31/05/2017

Checked By: CAB  
Scale: 1:500 @ A1

Drawn By: MR  
Date: 31/05/2017

Drawn By: MR  
Date: 31/05/2017