

WALTHAM TERRACE - TRAFFIC MANAGEMENT PLAN FOR CONCRETE WORKS

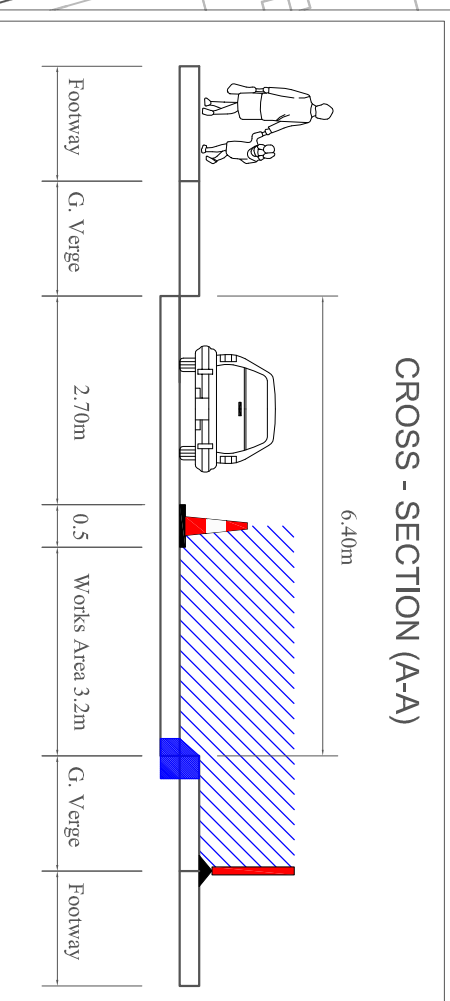
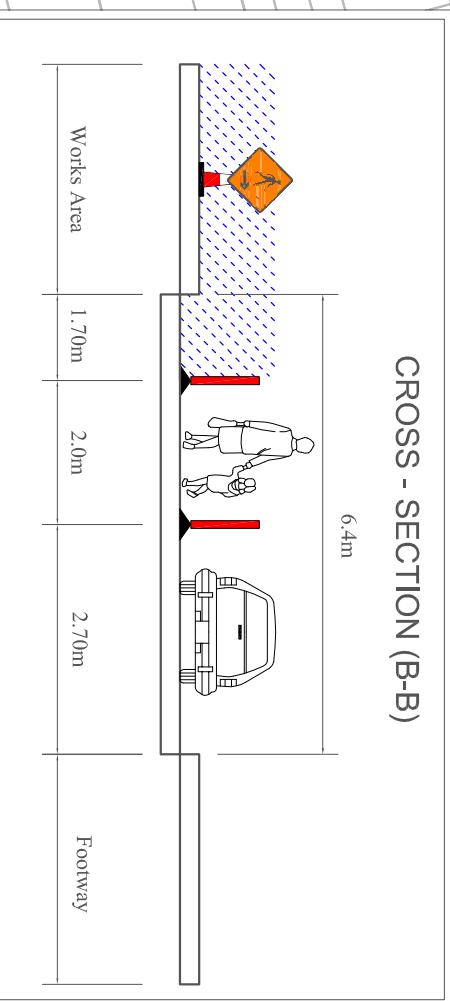
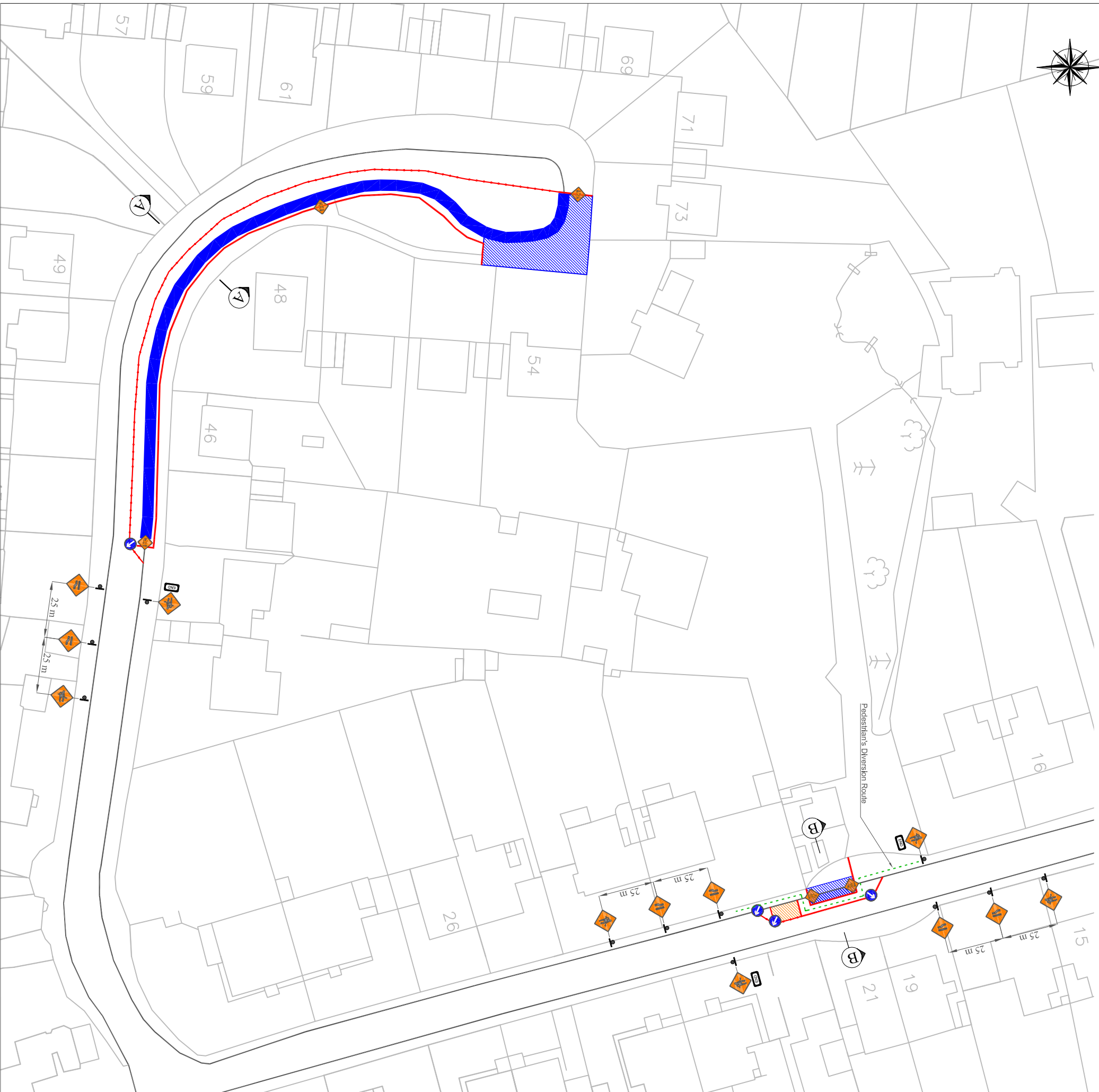
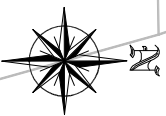

- REGION PARAMETERS:**
- TRAFFIC CONTROL: ONE LANE TAKE
 - STATUTORY SPEED OF THE ROAD: 50km/h
 - MINIMUM SIGN SPACING: 20m
 - MINIMUM SIGN VISIBILITY: 50m
 - LONG: SAFETY ZONE: 25M
 - LONG: SAFETY ZONE: 25M
 - LEADING TAPER: 45 DEG
 - LEADING TAPER CONE SPACE: 3.0M
 - LONG: CONE SPACE: 6.0M
 - UNRESTRICTED WIDTH: 3.00M
- LEGEND**
- LONG SAFETY ZONE
 - WORKS AREA
 - SAFETY BARRIERS
 - CONES (INCLUDING 0.5M SIDE SAFETY ZONE)
 - SIGN LOCATION

SIBIC
BITUMINDUS PRODUCTS

WALTHAM TERRACE CONCRETE WORKS
TRAFFIC MANAGEMENT PLAN

APPROVED: DENIS RYAN

DATE: 18/05/2015

DRAWN: RAFAL STRZALKOWSKI

SCALE: NOT TO SCALE

REVISION: 1