

KEY PLAN:
SCALE - 1:125

LEGEND:

- EXISTING KERBLINE
- PROPOSED KERBLINE
- PROPOSED 50mm KERB BETWEEN CYCLETRACK AND FOOTPATH
- PROPOSED PRECAST EDGING KERB BETWEEN CYCLETRACK AND GRASS VERGE / LANDSCAPED AREA
- PROPOSED FACILE PAVING
- PROPOSED KASSEL KERBLINE
- PROPOSED CARRAGEWAY BUILDUP / RESURFACING
- PROPOSED FOOTPATH
- PROPOSED SHARED SURFACE
- PROPOSED PAISED CYCLETRACK
- PROPOSED MANDATORY CYCLELANE
- PROPOSED GRASSSED AREA
- PROPOSED PLANTED EMBANKMENT / AREA
- PROPOSED BUS STOP
- PROPOSED PEDESTRIAN AND CYCLIST RAMP TO LINEAR PARK
- PROPOSED WALL



Clifton Scannell Emerson Associates Limited
Consulting Engineers
Seaford Lodge,
Castledawson Avenue,
Blackrock, Co. Dublin,
Ireland.
T. +353 1 288 8006
F. +353 1 283 3466
E. info@cse.ie
W. www.cse.ie

DUN LAOGHAIRE RATHDOWN COUNTY COUNCIL

WYATTVILLE ROAD PEDESTRIAN AND CYCLE SCHEME

PROPOSED SCHEME LAYOUT - CONSTRUCTED 2016

SHEET 2 OF 2

Drawn By: CP Date: MARCH 2016

Checked By: PL Scale: AS SHOWN @ A1

Dwg. Progress: DRAFT

Dwg. No.: 13_183_011-A

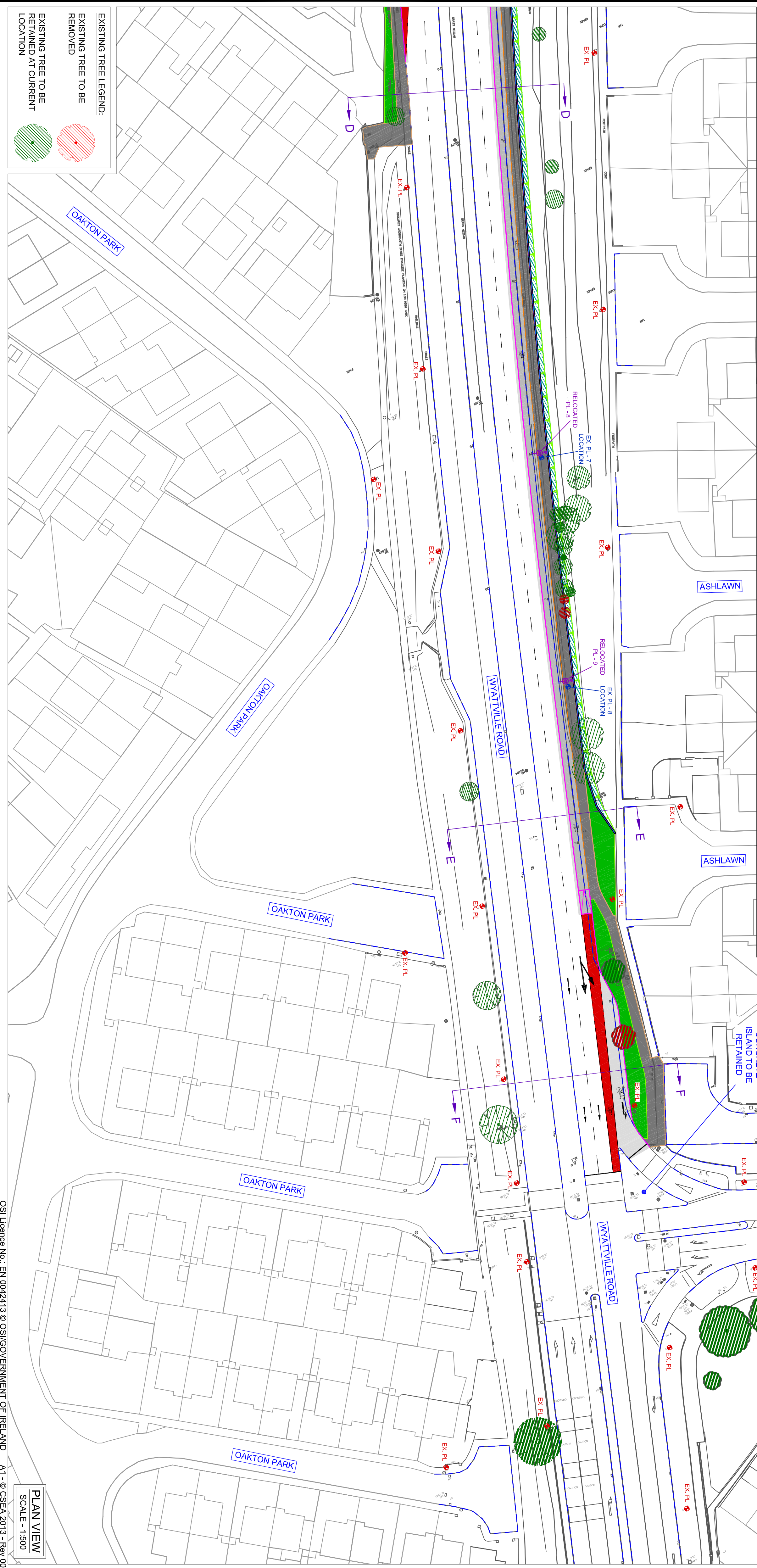
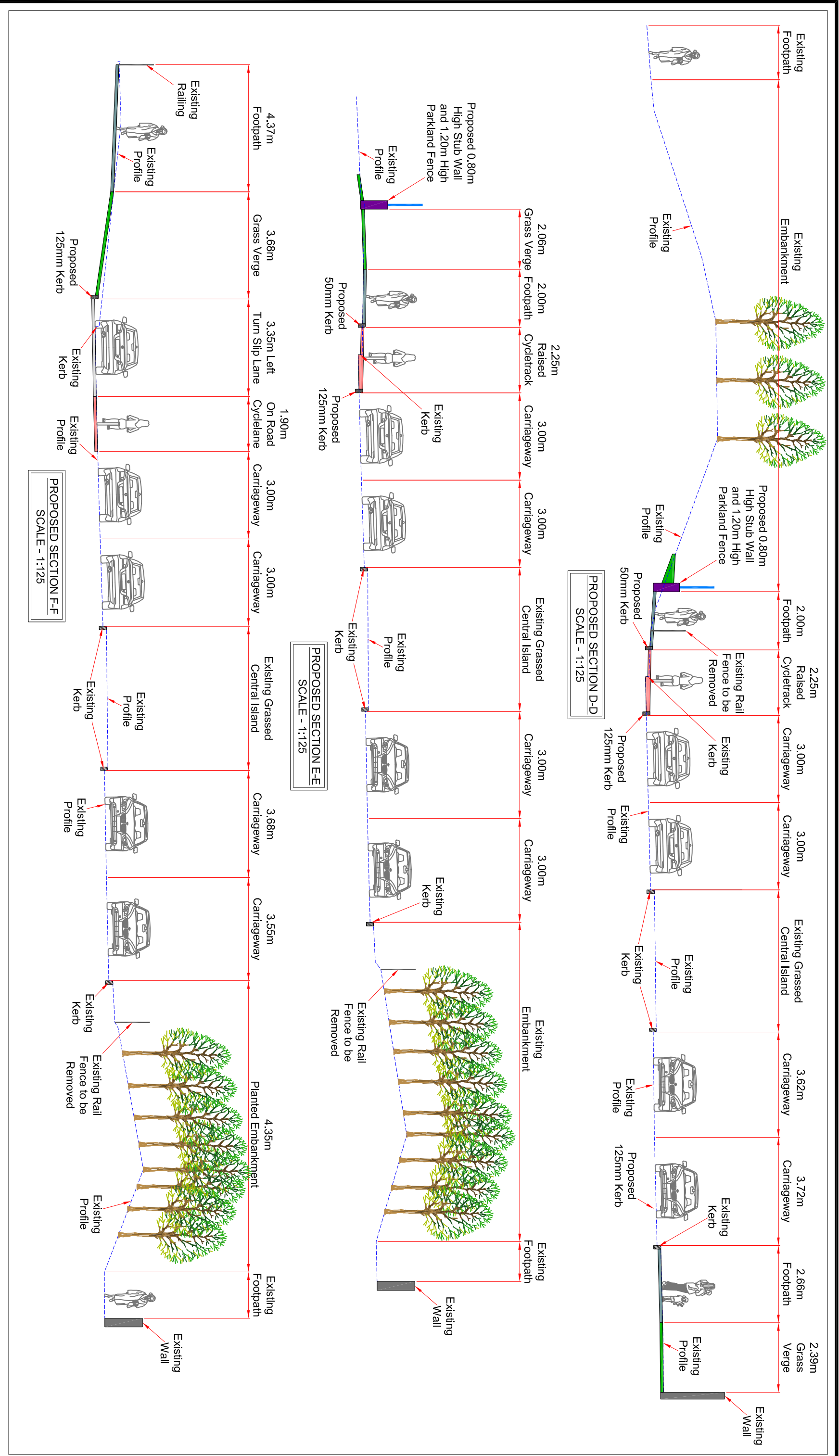

EXISTING TREE LEGEND:

- EXISTING TREE TO BE REMOVED
- EXISTING TREE TO BE RETAINED AT CURRENT LOCATION